

AUTOMATIC AIR GREASE GUN

OWNER/OPERATOR RESPONSIBILITIES

IT IS THE RESPONSIBILITY OF THE OWNER AND/OR OPERATOR TO PROPERLY USE AND MAINTAIN THIS EQUIPMENT AND THE LEGIBILITY OF ALL WARNING AND INSTRUCTION LABELS. CAREFULLY READ AND UNDERSTAND THE INSTRUCTIONS AND WARNINGS IN THIS MANUAL BEFORE OPERATING THIS EQUIPMENT. THE OWNER/OPERATOR SHALL RETAIN THIS MANUAL FOR FUTURE REFERENCE TO IMPORTANT OPERATING INSTRUCTIONS.

SPECIFICATIONS

See product labels for model number, series level, and capacity rating.

⚠ WARNING

FAILURE TO HEED WARNINGS MAY RESULT IN PROPERTY DAMAGE OR PERSONAL INJURY.

- High pressure hazard.
- Wear safety goggles.
- Do not exceed 90 psi with hose or 150 psi with solid extension.



Follower Seal Lip
(Cartridge Position)
(1)

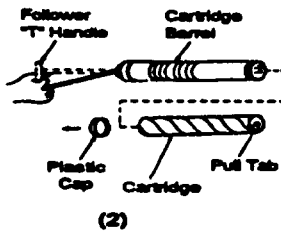

(2)



Front Side

(3)



(4)

INSPECTION

Visually inspect for damaged, loose or missing parts. If equipment is worn or damaged, remove from service. Contact an authorized service center for damage assessment or repair.

GREASE FILLING

Removing Empty Cartridge

1. Unscrew pump head assembly from the container tube.
2. To remove an empty cartridge, pull back on the follower "T" handle until the follower rod is fully extended and locks into place. Then carefully release follower "T" handle to eject empty cartridge from container tube.

Installing Cartridge (1 & 2)

1. Visually check follower seal lip direction before loading a new cartridge. The follower seal lip must be directed toward follower "T" handle for cartridge loading.
2. Pull back on follower "T" handle and latch the follower rod groove in the keyway to lock.
3. Remove the plastic cap from the cartridge and insert cartridge into container tube.
4. Remove pull tab and screw pump head onto the container tube.
5. Unlock follower "T" handle. Purge air from gun. See air purging instructions.

Manual Filling (3 & 4)

1. Unscrew pump head assembly from container tube.
2. The follower seal lip must be directed toward the pump head assembly when cartridges are not used. Turn follower seal lip over and away from the follower spring. Reassemble container tube.
3. Pack container tube follower end with grease to eliminate air pocket.
4. Dip packed end of container tube about one inch into bulk container.
5. Slowly pull follower rod back while gradually pushing container tube deeper into grease.
6. Screw pump head assembly onto container tube.
7. Unlock follower "T" handle. Purge air from gun. See air purging instructions.

Pump Filling

NOTE: If required, purchase filler nipple (91108) and install in place of pipe plug.

1. Visually check follower seal lip direction through the open end of container tube before filling gun with grease. The follower seal lip must be directed toward the pump head assembly when cartridges are not used.
2. Engage follower rod and piston by rotating follower "T" handle.
3. Insert grease gun filler nipple into filler pump socket.
4. Operate filler pump to fill container tube.
5. Push follower rod into container tube.

ASSEMBLY AND OPERATION

1. Inspect pump head for assembly of ball check spring seated in 1/8 NPSF thread in the end of the pump head nozzle.
2. Thread extension tube or hose to pump head nozzle.
3. Securely attach air supply line to an air fitting on bottom of gun handle.
4. Refer to loading instructions for proper grease loading.
5. Before attaching coupler to grease fitting, depress trigger to cycle gun and verify gun is primed with grease. If gun fails to prime, refer to air purging instructions.

IMPORTANT

AIR POCKETS IN GREASE ENTERING THE PUMPING CHAMBER WILL CAUSE THE GUN TO OPERATE ERRATICALLY AND LOSE PRIME. WHEN LOADING THE GUN IT IS VERY IMPORTANT TO PREVENT AIR POCKETS AND TO PURGE ANY AIR TRAPPED BETWEEN THE PUMP HEAD AND CONTAINER TUBE.

AIR PURGING:

NOTE: If required, owner/operator may purchase bleeder valve (243307) and install in place of pipe plug.

Purge air as follows:

1. Unscrew container tube from pump head assembly about 1/2 way.
2. Pull back on follower "T" handle and rotate to engage follower locking mechanism.
3. Push follower "T" handle forward to force any air pockets out of pump head assembly.
4. Cycle gun before attaching coupler to grease fitting to exhaust any trapped air from the pumping chamber.
5. Repeat procedure if gun loses prime.

SERVICE

If gun fails to prime or fails to cycle continuously, contact your nearest factory authorized service center for repairs and/or replacement parts.

LIMITED WARRANTY

Lincoln, A Pentair Company, warrants that lubrication equipment, materials dispensing equipment and other related equipment manufactured by it will be free from defects in material and workmanship during the one (1) year following the date of purchase. If equipment proves to be defective during this warranty period, it will be repaired or replaced without charge, provided that factory examination indicates the equipment to be defective. To obtain repair or replacement, it must be shipped, transportation charges prepaid, with proof of date of purchase, to a Lincoln authorized Warranty and Service Center, within one (1) year following the date of purchase.

This warranty is extended to the original retail purchaser only. This warranty does not apply to parts damaged from accident, overload, abuse, misuse, negligence, faulty installation or abrasive or corrosive materials, or to equipment repaired or altered by anyone not authorized by Lincoln to repair or alter the equipment. This warranty applies only to equipment installed and operated according to the recommendations of Lincoln or its authorized field personnel. No other express warranty applies to lubrication equipment, materials dispensing equipment, and other related equipment manufactured by Lincoln.

Any implied warranties applicable to lubrication equipment, materials dispensing equipment, and other related equipment manufactured by Lincoln, including the warranties of merchantability and fitness for a particular purpose, will last for only one (1) year from the date of purchase. Some states do not allow limitations on how long an implied warranty lasts, so the above may not apply to you.

In no event shall Lincoln be liable for incidental or consequential damages. The liability of Lincoln on any claim or damage arising out of the sale, resale or use of lubrication equipment, materials dispensing equipment, and other related equipment shall in no event exceed the purchase price. Some states do not allow the exclusion or limitation of incidental or consequential damages, so the above may not apply to you.

This warranty gives you specific legal rights, and you may also have other rights which vary from state to state.

AUTOMATIC AIR GREASE GUN

SERVICE PARTS SHEET

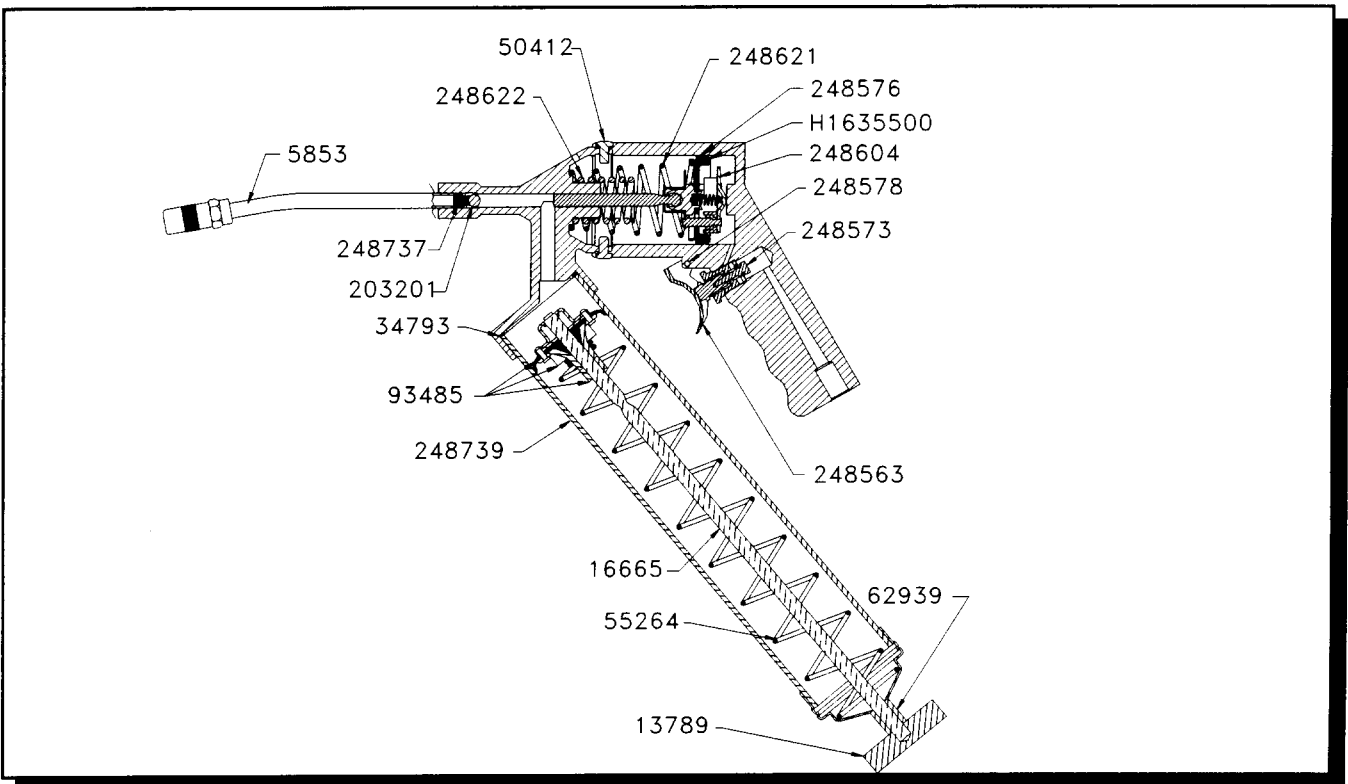

PART NUMBER	DESCRIPTION	QTY	PART NUMBER	DESCRIPTION	QTY
5853	Coupler extension	1	248573	Trigger valve assembly	1
13789	Handle	1	248576*	U-cup packing	1
16665	Plunger rod	1	248578	Roll pin	1
34793	Packing	1	248604	Air piston	1
50412	Screw, 10-32 x 1/4	4	248621	Return spring	1
55264	Follower spring	1	248622*	Actuation spring	1
62939	Spacer	1	248737	Ball check spring	1
93485	Follower assembly	1	248739	Tube and cap assembly	1
203201	Ball	1	H1635500*	O-ring packing	1
248563	Trigger	1			

* included in air motor repair kit 248738

*One Lincoln Way
St. Louis, MO 63120-1578
Customer Service (314)679-4300*

*Copyright 1997
Printed in U.S.A.*

**Section - 1
Air Operated Pump
Form 420454**