

FLUID DISPENSER

3:1 RATIO, FOR 5 GAL. CONTAINER

Models 416, 83776
83777

SPECIFICATIONS

DIMENSIONS- 12-1/2" Diameter x 24" Height
 CONTAINER SIZE - 5 Gallons
 PUMP RATIO - 3:1
 MAXIMUM OPERATING
 AIR PRESSURE - 200 psi

WARNING
 DO NOT OPERATE
 WITH COMBUSTIBLE GAS.

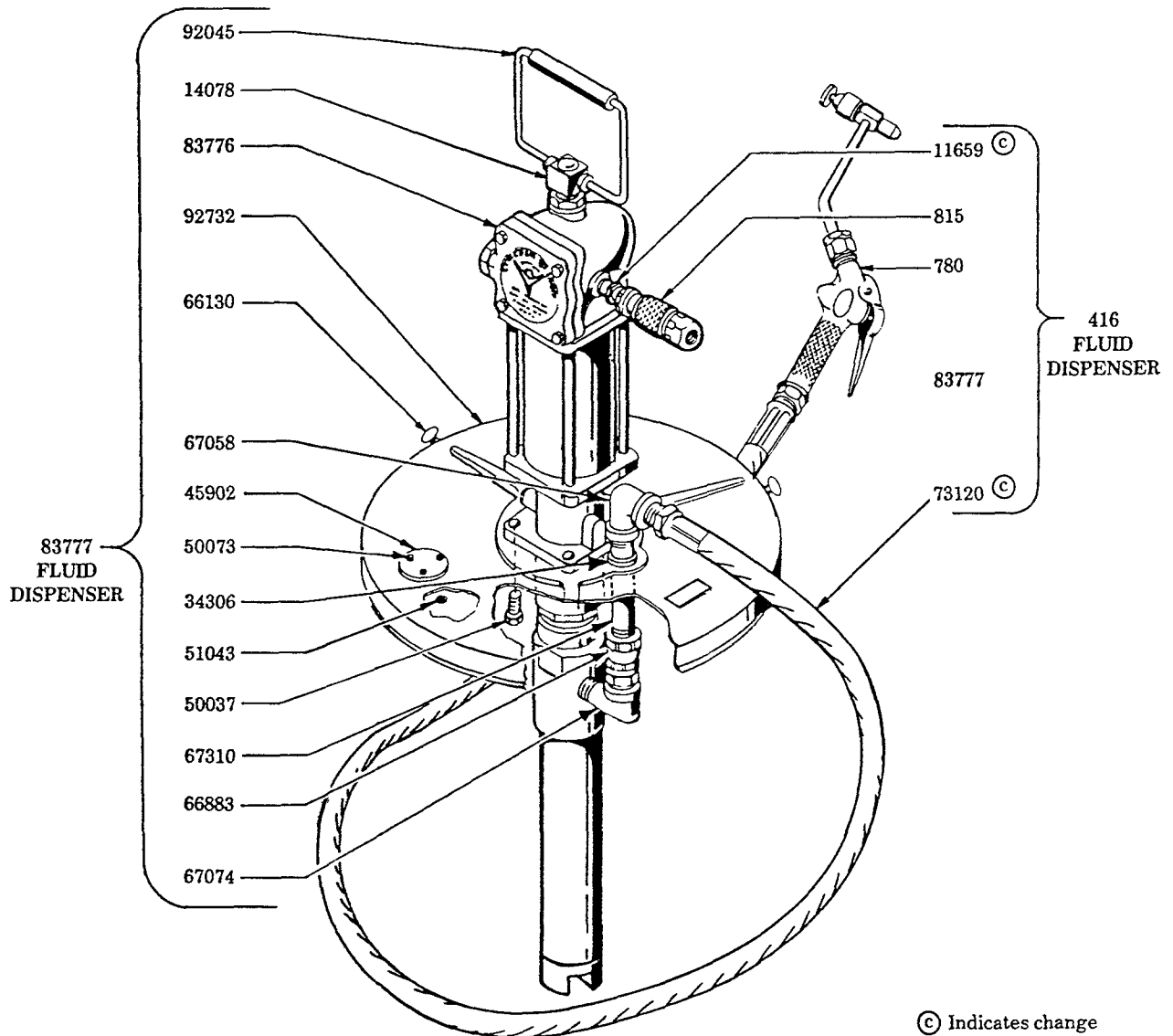

LINCOLN, One Lincoln Way
 St. Louis, Missouri 63120-1578
 (314) 679-4200 Customer Service, (314) 679-4300

SECTION -A36
 PAGE -1G

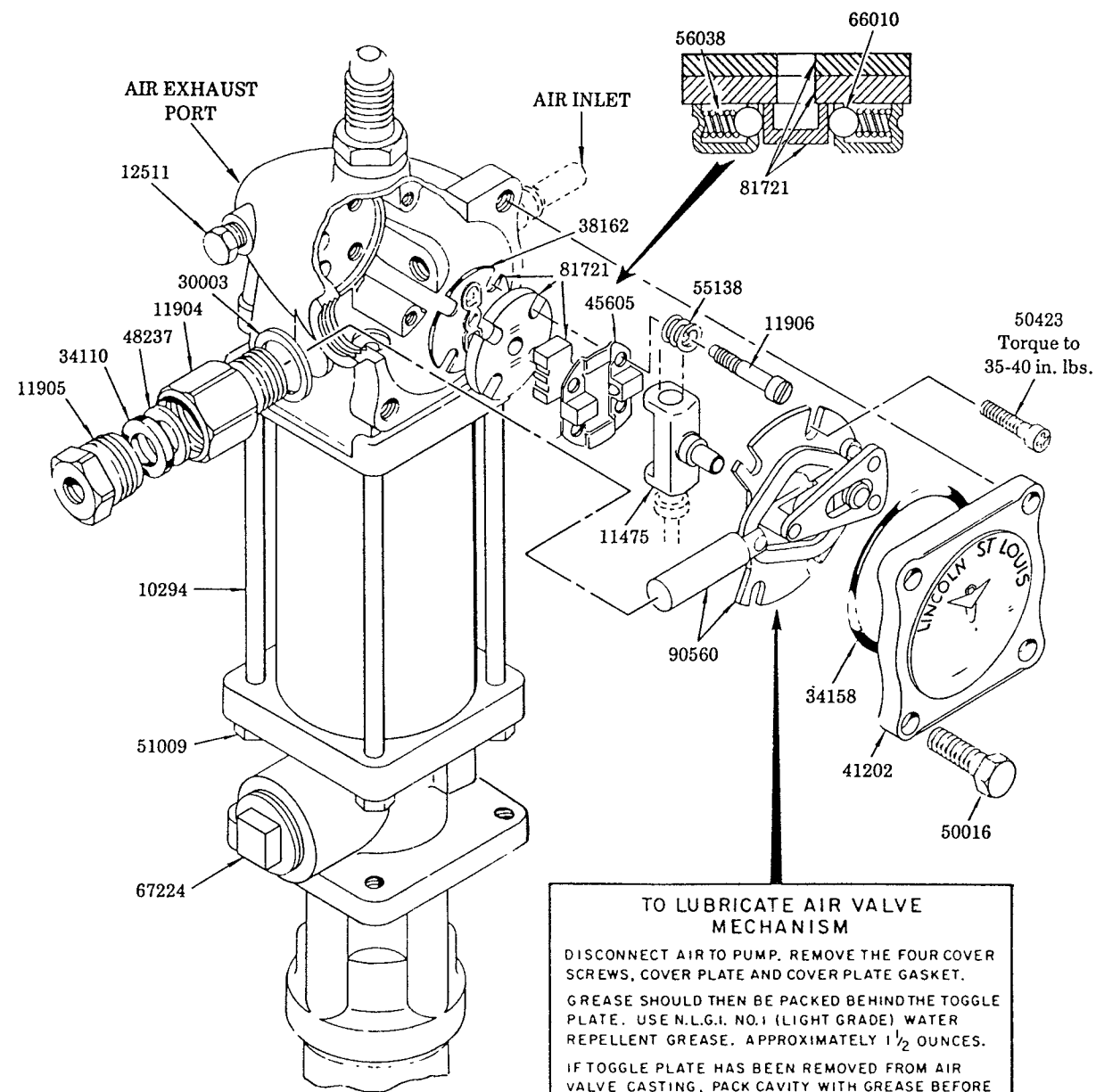
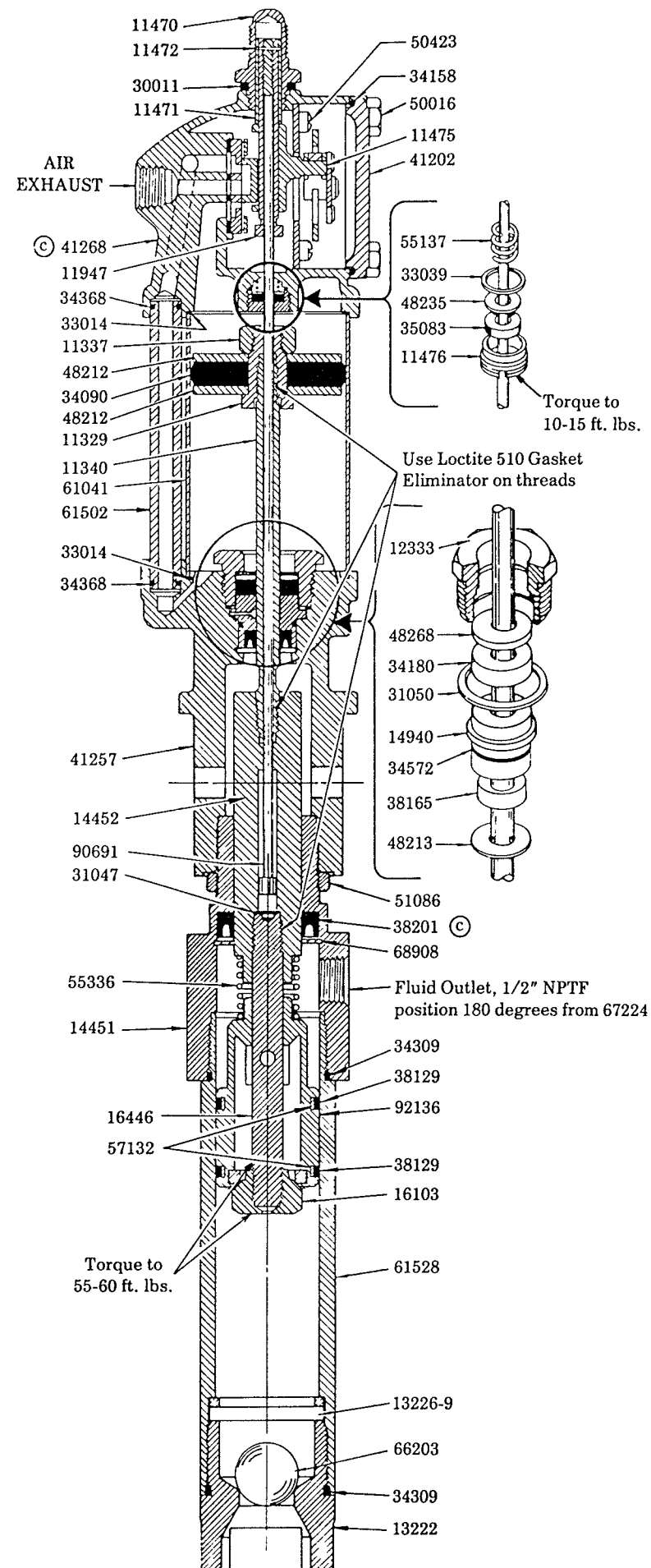

TO LUBRICATE AIR VALVE MECHANISM

DISCONNECT AIR TO PUMP. REMOVE THE FOUR COVER SCREWS, COVER PLATE AND COVER PLATE GASKET. GREASE SHOULD THEN BE PACKED BEHIND THE TOGGLE PLATE. USE N.L.G.I. NO. 1 (LIGHT GRADE) WATER REPELLENT GREASE. APPROXIMATELY 1 1/2 OUNCES. IF TOGGLE PLATE HAS BEEN REMOVED FROM AIR VALVE CASTING, PACK CAVITY WITH GREASE BEFORE REPLACING TOGGLE PLATE. REPLACE COVER PLATE GASKET, COVER PLATE AND COVER SCREWS. TIGHTEN TO AVOID AIR LEAKS. PERIODIC INSPECTION OF PARTS AT LEAST ONCE EACH YEAR IS ADVISABLE.

Model 83776 - Series " E "
2-1/2" DIA. AIRMOTOR - 3:1 RATIO

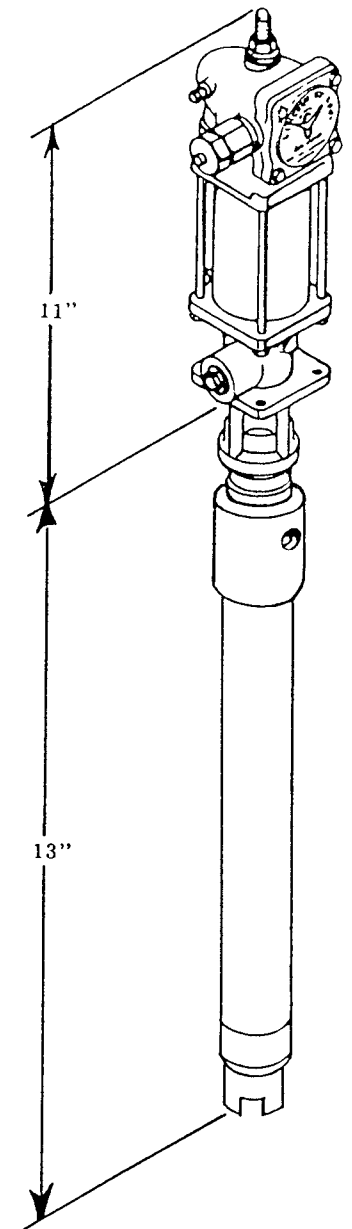

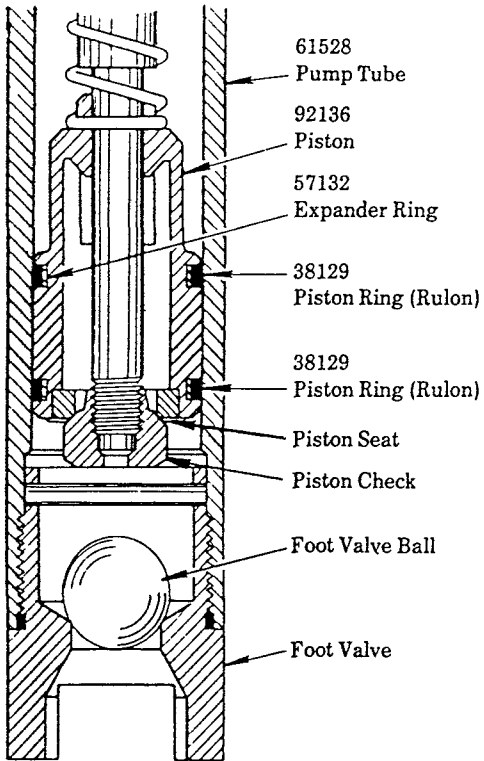

PISTON RING INSTALLATION PROCEDURE

1. Install a 57132 Expander Ring in the lower piston groove of the 92136 Piston.
2. Install the 38129 Piston Ring over the expander ring with their gaps separated 180°.
3. Push the piston into the 61528 Pump Tube to retain the lower piston ring.
4. Repeat the procedure to install the upper piston ring.

TROUBLE SHOOTING

PROBLEM: Pump will not stall against fluid pressure on up stroke.
CAUSE: Worn piston rings or piston check not sealing against piston seat.

PROBLEM: Pump will not stall against fluid pressure on down stroke.
CAUSE: Foot valve ball is not sealing against seat.

PROBLEM: Pump runs continuously.
CAUSE: Container is empty.

SERVICE PARTS

| PART | QUAN. | DESCRIPTION | PART | QUAN. | DESCRIPTION | PART | QUAN. | DESCRIPTION |
|---------|-------|----------------------|--------|-------|------------------------|--------|-------|---------------------|
| 780 | 1 | Control valve | *31047 | 1 | Gasket | 50073 | 3 | Screw |
| 815 | 1 | Air coupler | *31050 | 1 | Gland gasket | 50423 | 4 | Screw |
| 10294 | 4 | Tie rod | *33014 | 2 | Air cylinder gasket | 51009 | 4 | Nut |
| 11329 | 1 | Air piston bolt | *33039 | 1 | Gasket | 51043 | 3 | Nut |
| 11337 | 1 | Air piston nut | *34090 | 1 | Air piston packing | 51086 | 1 | Nut |
| *11340 | 1 | Piston rod | *34110 | 1 | Plunger packing | 55137 | 1 | Spring |
| 11470 | 1 | Valve cap | *34158 | 1 | Cover gasket | 55138 | 4 | Spring |
| 11471 | 1 | Trip rod collar | *34180 | 1 | Packing | 55336 | 1 | Spring |
| *11472 | 1 | Trip rod pin | *34306 | 1 | Seal | *56038 | 2 | Spring |
| *11475 | 1 | Trip shoe | *34309 | 2 | Gasket | *57132 | 2 | Expander ring |
| *11476 | 1 | Trip rod packing nut | *34368 | 2 | O-ring | *61041 | 1 | Air cylinder |
| 11659 | 1 | Coupler nipple | *34572 | 1 | O-ring | 61502 | 1 | Air passage tube |
| 11904 | 1 | Packing nut | *35083 | 1 | Trip rod packing | 61528 | 1 | Pump tube |
| 11905 | 1 | Packing cap | *38129 | 2 | Piston ring (Rulon) | *66010 | 2 | Steel ball |
| 11906 | 4 | Valve seat bolt | *38162 | 1 | Valve seat gasket | 66130 | 3 | Thumb screw |
| *11947 | 1 | Trip sleeve | *38165 | 1 | U-cup packing | *66203 | 1 | Steel ball |
| 12333 | 1 | Packing nut | *38201 | 1 | U-cup packing | 66883 | 1 | Adapter union |
| 12511 | 1 | Plug | 41202 | 1 | Cover casting | 67058 | 1 | Elbow |
| *13222 | 1 | Foot valve body | 41257 | 1 | Outlet casting | 67074 | 1 | Street elbow |
| 13226-9 | 1 | Ball retaining pin | 41268 | 1 | Air valve casting | 67224 | 1 | Pipe plug |
| 14078 | 1 | Handle adapter | 45605 | 1 | Valve guide | 67310 | 1 | Nipple |
| 14451 | 1 | Pump tube adapter | 45902 | 1 | Cover | 68908 | 1 | Retaining ring |
| *14452 | 1 | Plunger | 48212 | 2 | Air piston washer | 73120 | 1 | Hose |
| 14940 | 1 | Gland packing spacer | 48213 | 1 | Washer | 81721 | 1 | Valve, slide & seat |
| *16103 | 1 | Piston check | 48235 | 1 | Packing washer | *90560 | 1 | Toggle plate |
| 16446 | 1 | Piston rod | 48237 | 1 | Plunger packing washer | *90691 | 1 | Trip rod |
| *30003 | 1 | Packing nut gasket | 48268 | 1 | Washer | 92045 | 1 | Handle |
| *30011 | 1 | Valve cap gasket | 50016 | 4 | Screw | *92136 | 1 | Pump piston |
| | | | 50037 | 4 | Screw | 92732 | 1 | Drum cover |

*Recommended service parts inventory.

RETAIN THIS INFORMATION FOR FUTURE REFERENCE

When ordering replacement parts, list: Part Number, Description, Model Number, and Series Letter.

LINCOLN ST. LOUIS provides a Distributor Network that stocks equipment and replacement parts.

A list of Authorized Service Departments will be furnished upon request.