

**AIR OPERATED
14:1 RATIO**

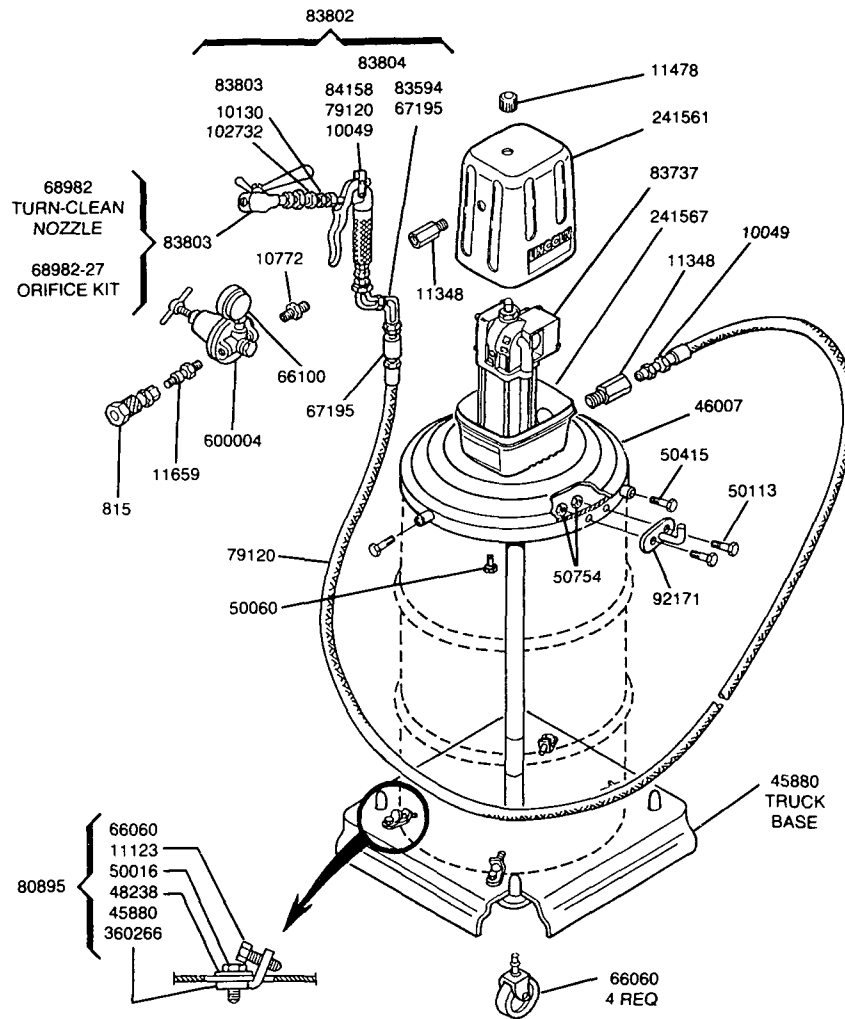

**MODEL 930
PORTABLE 120 LB. DRUM (SLEEVELESS)**

1. Insert end of Pump Tube through hole in Drum Cover. Line up holes in Drum Cover with holes in cover-bottom and Pump Outlet Body. Use four hex. head screws, tighten securely.
2. Assemble the four casters to the Base.
3. Place fresh Material Drum centrally on Base between the four Base Clamps.
 - a. Adjust Clamp position to fit Drum and tighten securely to Base.
 - b. Tighten the four Studs in the Clamps to hold Drum rigidly to the Base.
4. Guide end of Pump Tube into Drum (until Drum Cover rests on top head of Drum).
Assemble the three Adjusting Screws into the side openings in the Drum Cover and tighten Screws to hold Pump rigidly to Drum.
5. Assemble the Air Controls to the Pump air inlet. Connections must be leak-proof.
6. Assemble Delivery Hose into Pump Outlet. Connections must be leak-proof.

CAUTION

TO PREVENT ACCIDENTS, ROTATE SAFETY LATCH TO THE "OFF" POSITION AFTER EACH USE.

83803 TURN-KLEEN SPRAY NOZZLE

Includes 68982 Adapter and 68982-27 Orifice Insert Kit

**Other kits are available. Refer to chart below.
(Must be ordered separately.)

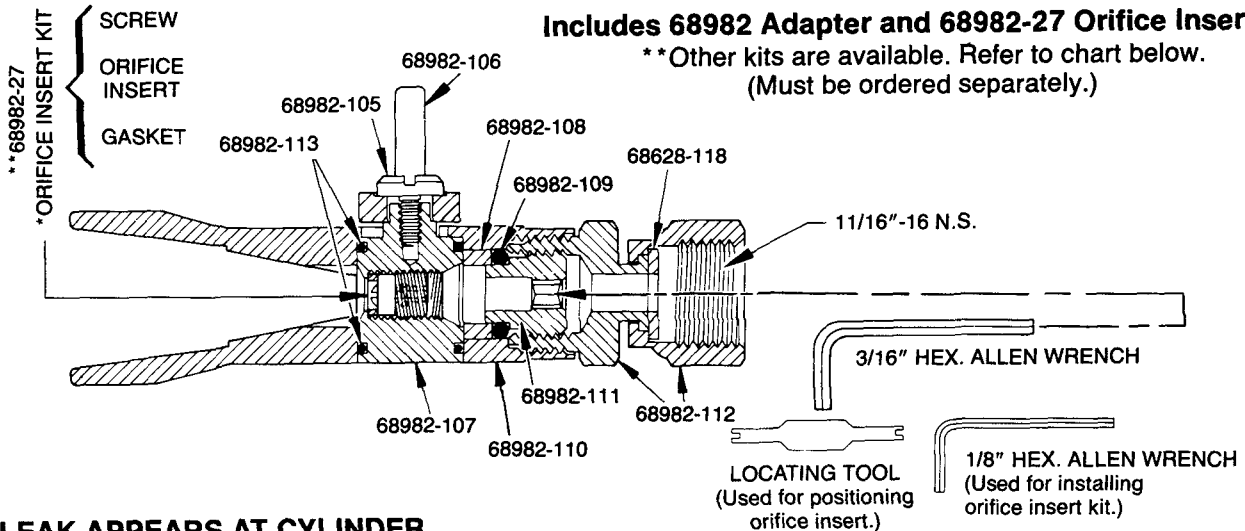

IF LEAK APPEARS AT CYLINDER

1. Rotate control valve safety latch to "Off" position.
2. Remove Turn-Kleen nozzle from control valve.
3. Rotate handle to "Clean-out" position.
4. Use 3/16" allen wrench to tighten adjusting screw to seat packing against cylinder.
5. Inspect 68982-113 O-rings. O-rings may be worn or damaged. Replace if necessary.

TO REPLACE ORIFICE KIT

1. Rotate control valve safety latch to "Off" position.
2. Remove Turn-Kleen nozzle from control valve.
3. Rotate handle to "Clean-out" position.
4. Remove lock screw from cylinder.
5. Insert wrench into back end of cylinder. Push or tap out orifice insert and gasket from cylinder.
6. Assemble new gasket and orifice insert into cylinder, replace lock screw.
7. Rotate handle back to "Spray" position.

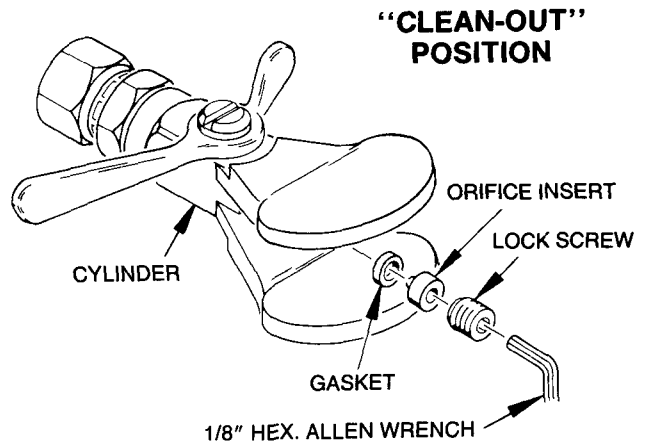

OPERATION

Recommended operating air pressure will vary in certain localities due to temperature conditions.

1. Shut off the air regulator and attach the air supply hose to the air inlet nipple of the pump.
2. Open air regulator slowly to start pump operation. Rotate safety latch to "ON" position. Depress

control valve handle and increase air pressure until a good spray pattern is obtained.

3. Decrease air pressure to reduce overspray.

TO SPRAY

- a. Depress control valve handle completely.
- b. Hold spray nozzle 10" to 12" away from work surface for most efficient coverage pattern.

POSITION OF HANDLE WHEN CLEARING ORIFICE

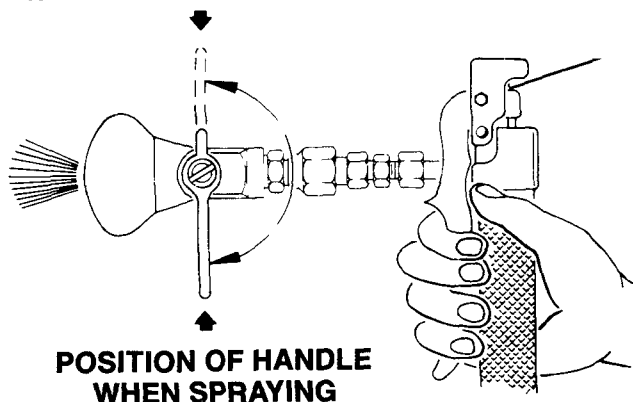

IF SPRAY NOZZLE ORIFICE BEGINS TO CLOG

- a. Release control valve handle.
- b. Rotate spray nozzle handle 180°
- c. Spray briefly to flush clogging particles, release control valve handle.
- d. Rotate spray nozzle handle back to "spray" position.

If orifice becomes clogged with dried material, clean in solvent. DO NOT USE WIRE OR PIN TO CLEAN OPENING OF ORIFICE—Use air pressure.

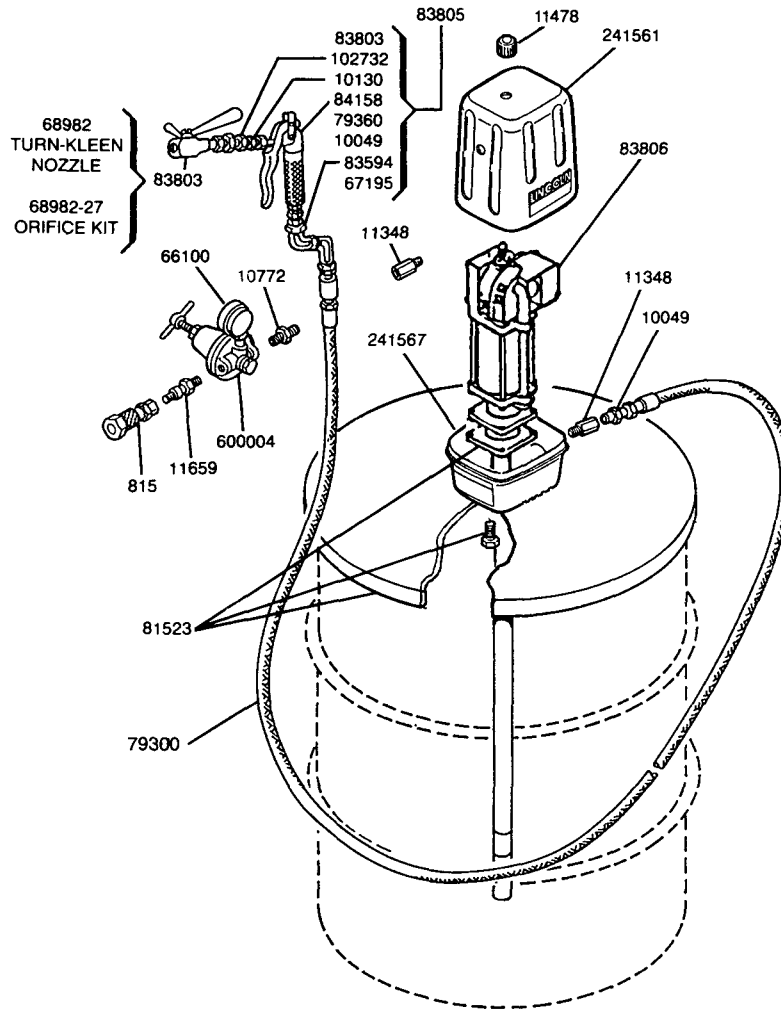

MODEL 931

STATIONARY 400 LB. DRUM (SLEEVELESS)

1. Insert end of Pump Tube through hole in Drum Cover. Line up holes in Drum Cover with holes in Cover-Bottom and Pump Outlet Body. Use four hex. head screws, tighten securely.
2. Assemble the Air Controls to the Pump air inlet. Connections must be leak-proof.
3. Assemble Delivery Hose into Pump Outlet. Connections must be leak-proof.



CAUTION

TO PREVENT ACCIDENTS, ROTATE SAFETY LATCH TO THE "OFF" POSITION AFTER EACH USE.

RETAIN THIS INFORMATION FOR FUTURE REFERENCE

When ordering replacement parts, list: Part Number, Description, Model Number, and Series Letter.

LINCOLN provides a Distributor Network that stocks equipment and replacement parts.

****TURN-KLEEN ORIFICE KITS**
(For use with Turn-Kleen nozzle.)

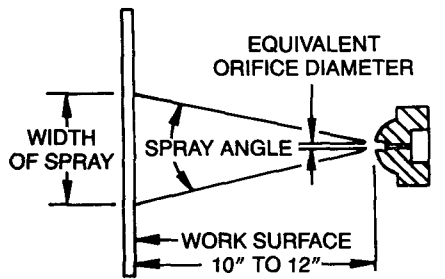

Use 68982-98 Gasket (thin) with orifice insert kit (-A thru -N).
Use 68982-97 Gasket (thick) with orifice insert kit (-O thru -Z).

ORIFICE INSERT KIT

Orifice Insert Kit	Tip Stenciled	Equivalent Orifice Diameter	Spray Angle	Approx. Width of Spray at 1600 PSI, 1' Distance
68982-13 68982-15 68982-8	2-F 2-G 2-H	.011" .013" .015"	15° 15° 15°	5" 5" 5-1/2"
68982-17 68982-14 68982-16	3-D 3-F 3-G	.007" .011" .013"	25° 25° 25°	5-1/2" 6" 6"
68982-18 68982-25 68982-26 68982-27 68982-28 68982-30 68982-31	4-E 4-K 4-J 4-L 4-H 4-M 4-N	.009" .021" .018" .026" .015" .031" .036"	40° 40° 40° 40° 40° 40° 40°	7" 11" 10" 12" 8-1/2" 12" 12"
68982-10 68982-12 68982-7 68982-6 68982-22 68982-19 68982-20 68982-23 68982-24	6-F 6-G 6-H 6-J 6-K 6-N 6-O 6-R 6-T	.011" .013" .015" .018" .021" .036" .043" .062" .072"	65° 65° 65° 65° 65° 65° 65° 65° 65°	10" 10-1/2" 11" 13" 15" 16" 16" 16" 16"
68982-5	8-J	.018"	80°	15"

Spray pattern width is based on a material with a viscosity of 20 seconds #4 Zahn cup spraying at 1600 psi. Coverages with other materials will vary but coverages of the various tips will be proportional to width tabulated.

COMPONENT PARTS

Part	Qty.	Description	Part	Qty.	Description
815	1	Air coupler	68982-107	1	Cylinder
10049	1	Adapter	68982-108	1	Teflon packing
10130	1	Nipple	68982-109	1	O-ring
10772	1	Nipple	68982-110	1	Cylinder body
11123	4	Screw	68982-111	1	Adjusting screw
11348	2	Adapter	68982-112	1	Cap assembly
11478	1	Cover nut	68982-113	2	O-ring
11659	1	Air nipple	79120	1	Hose (10 ft.)
241561	1	Cover—top	79300	1	Hose (25 ft.)
241567	1	Cover—bottom	80895	1	Truck assembly
45880	1	Truck plate	81523	1	Drum cover assembly
46007	1	Drum cover	83594	1	Universai swivel
48238	4	Washer	83737	1	Pump assembly
50016	4	Screw	83802	1	Hose, control valve & nozzle assembly
50060	4	Screw	83803	1	Turnkleen tip adapter & orifice kit
50113	2	Screw	83804	1	Hose & control valve assembly
50415	3	Screw	83805	1	Hose, control valve & nozzle assembly
50754	2	Nut	83806	1	Pump assembly
66060	4	Caster	84158	1	Low pressure control valve
66100	1	Pressure gauge	92171	1	Nozzle hanger
67195	1	Pipe coupling	102732	1	Reducing bushing
68628-118	1	Nylon tip gasket	360266	1	Clamp
68982	1	Turnkleen tip adapter assembly	600004	1	Air regulator
68982-27	1	Orifice insert kit			
68982-105	1	Screw			
68982-106	1	Handle			