

# 2-1/2" HYDRAULIC MOTOR OPERATED PUMP

Model 84617

CHASSIS - 50:1 RATIO

Series "A"

**IMPORTANT**

**MAXIMUM HYDRAULIC OIL TEMPERATURE: 150° F.**  
(If higher temperature is required, contact factory.)

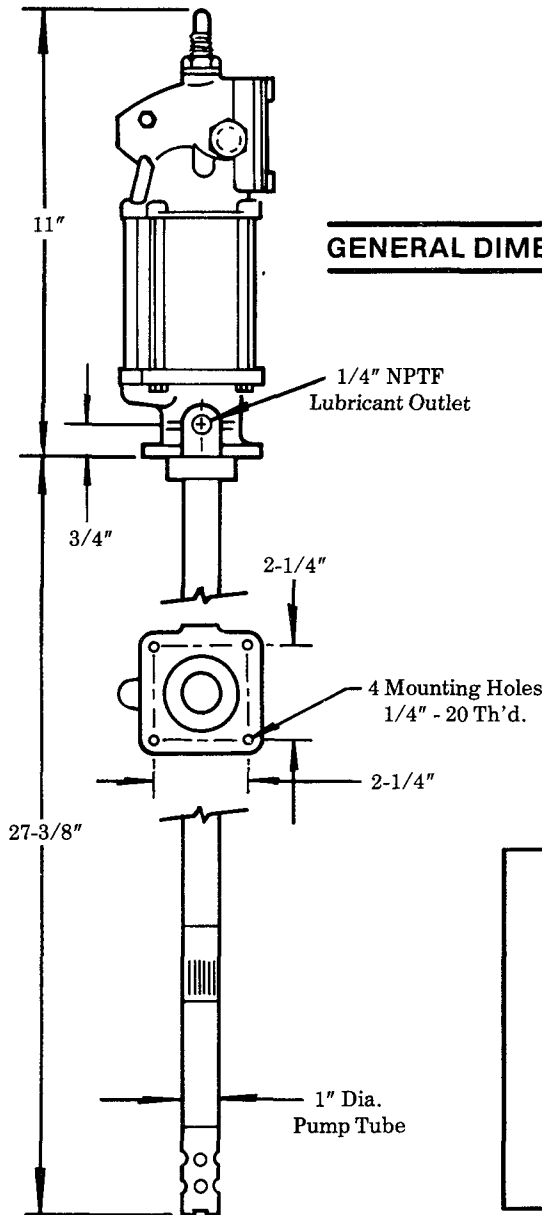
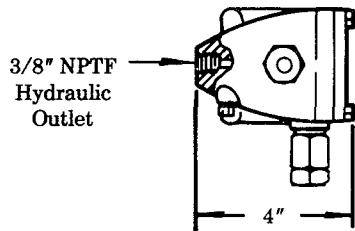

**GENERAL DIMENSIONS**

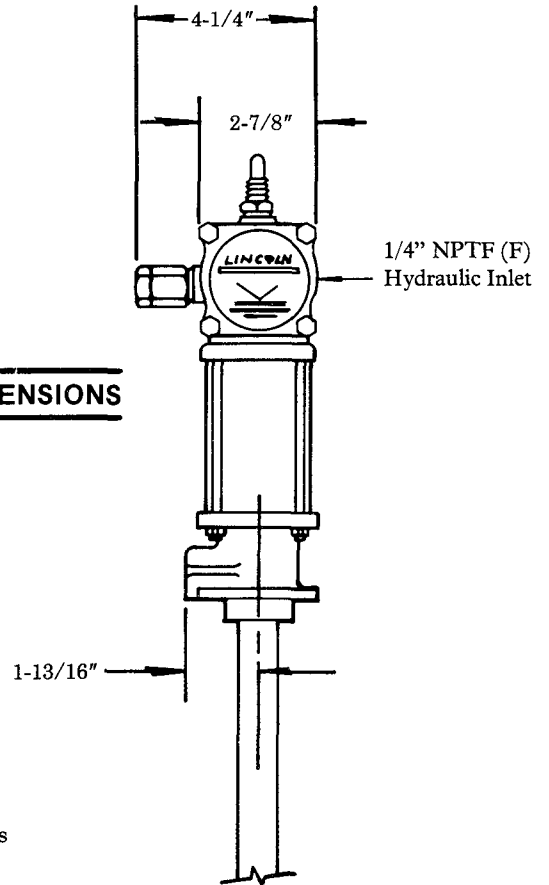

**HYDRAULIC INLET PRESSURE**

Refer to Service Manual  
Section C8, Page 201 Series.  
For 84615 Hydraulic Control Panel

————— 100 PSI MAX. —————

When used in a Modular Lube system or with a control valve in grease system.

————— 200 PSI MAX. —————

When used in Centro-Matic system having pressure switch and relief valve in system control.

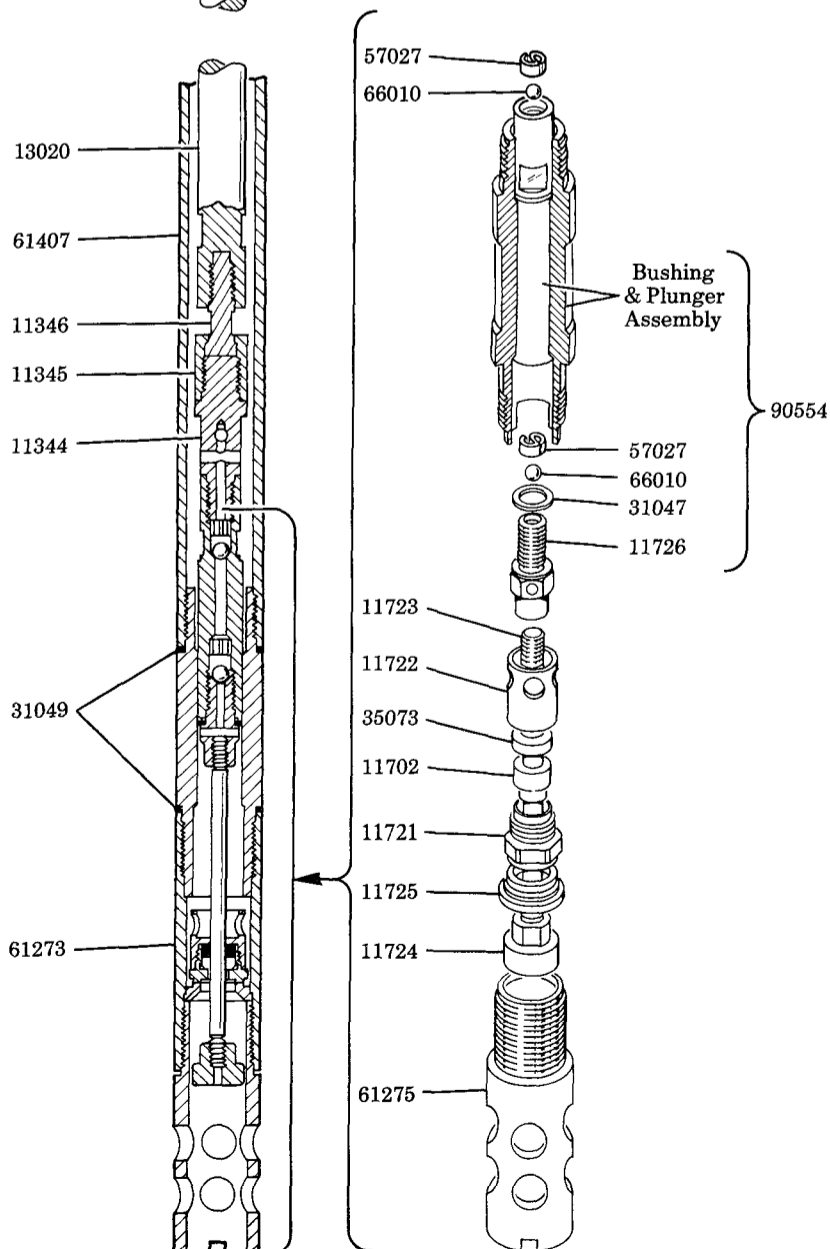
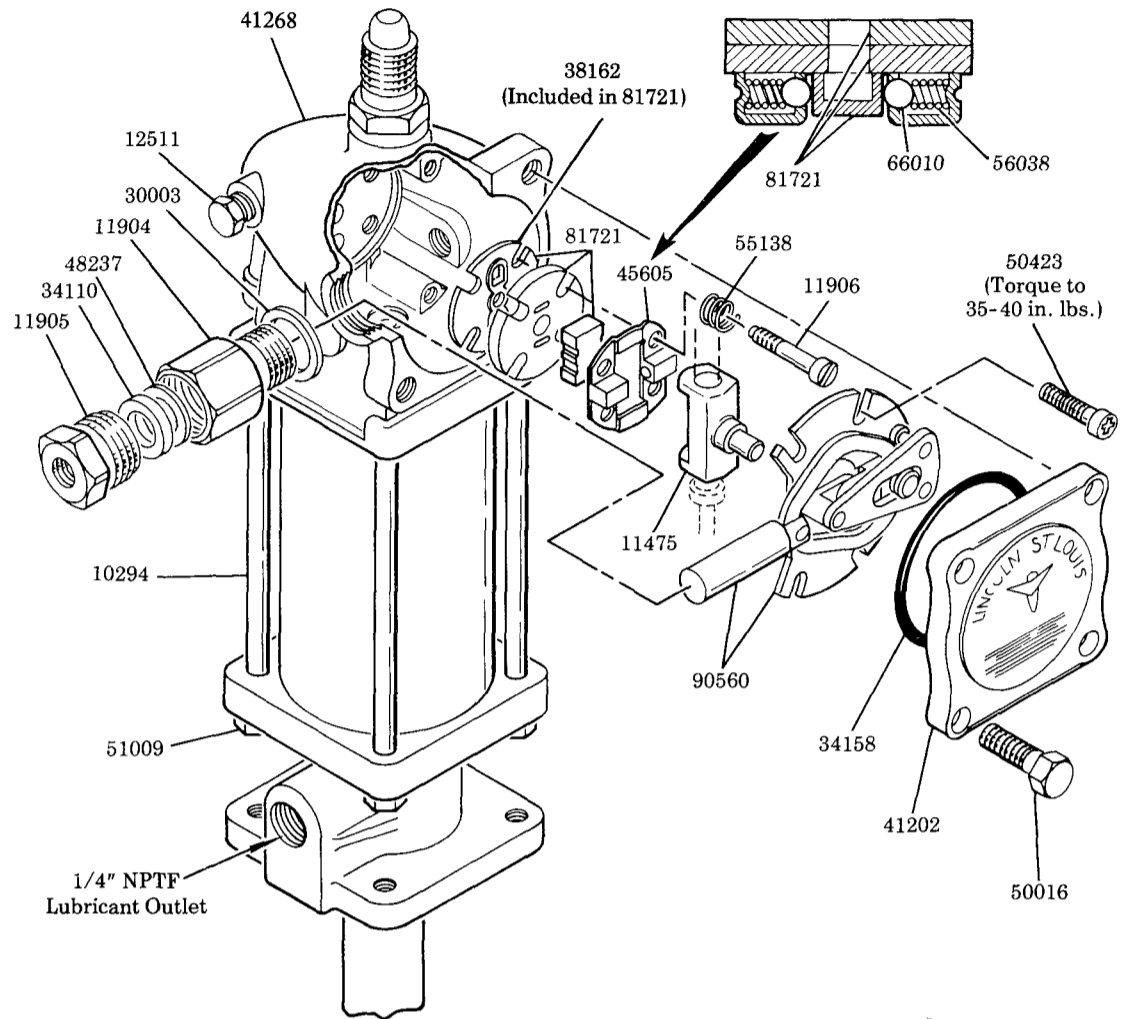
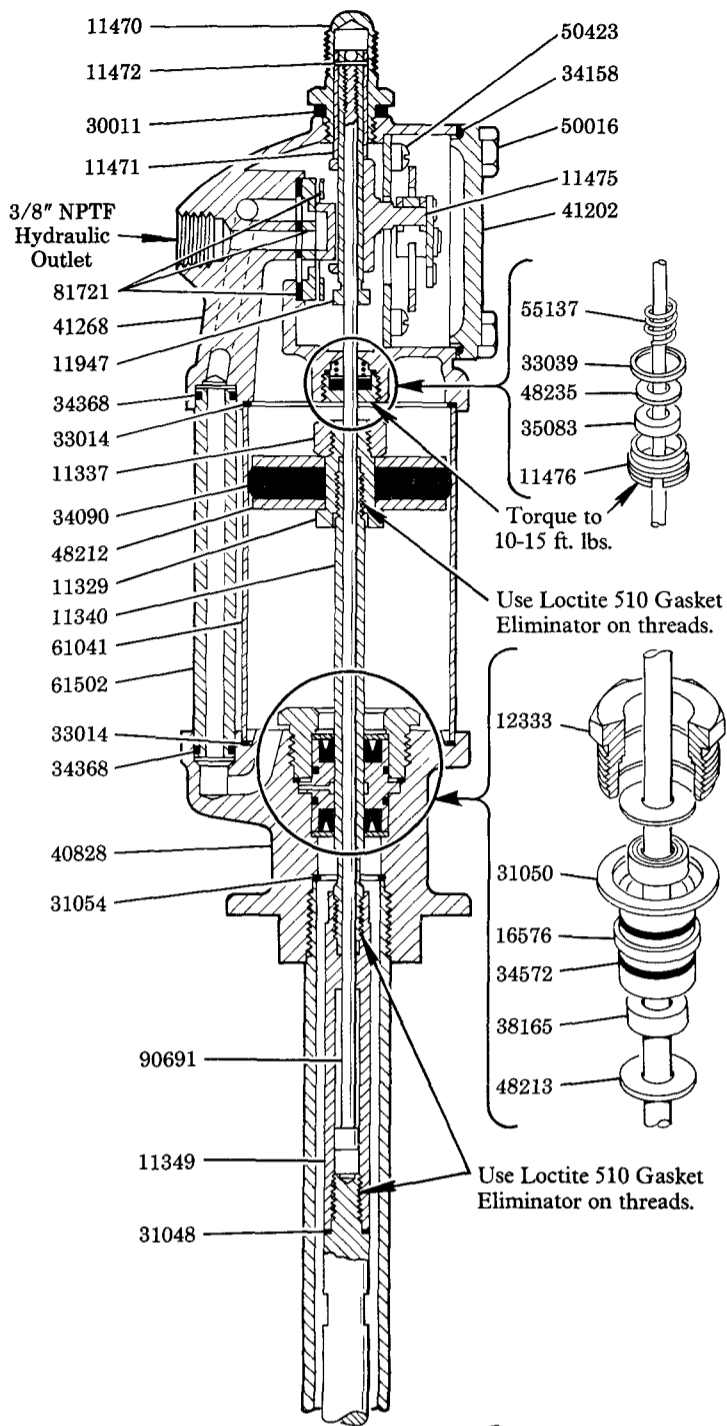

### SERVICE PARTS

PART	QUAN.	DESCRIPTION	PART	QUAN.	DESCRIPTION
10294	4	Tie rod	* 33039	1	Packing nut gasket
11329	1	Piston bolt	* 34090	1	Piston packing
11337	1	Piston nut	* 34110	1	Plunger packing
* 11340	1	Piston rod	* 34158	1	Cover gasket
11344	1	Plunger adapter	* 34368	2	O-ring
11345	1	Coupling nut	* 34572	2	O-ring
11346	1	Coupling stud	* 35073	1	Priming check packing
11349	1	Piston rod connector	* 35083	1	Trip rod packing
11470	1	Valve cap	* 38162	1	Valve seat gasket
11471	1	Trip rod collar	* 38165	2	U-cup packing
* 11472	1	Trip rod pin	40828	1	Outlet body
* 11475	1	Trip shoe	41202	1	Cover casting
11476	1	Trip rod packing nut	41268	1	Valve casting
11702	1	Check washer	45605	1	Valve guide plate
* 11721	1	Priming check	48212	2	Piston washer
11722	1	Check stop	48213	2	Gland packing washer
* 11723	1	Plunger rod	48235	1	Packing washer
* 11724	1	Priming plunger	48237	1	Plunger packing washer
* 11725	1	Priming check seat	50016	4	Valve cover screw
11726	1	Check seat	* 50423	4	Toggle plate screw
11904	1	Packing nut	51009	4	Tie rod nut
11905	1	Packing cap	* 55137	1	Trip rod packing spring
11906	4	Valve seat bolt	55138	4	Valve seat spring
11947	1	Trip sleeve	56038	2	Spring
12333	1	Gland packing nut	57027	2	Ball stop
12511	1	Pipe plug	61041	1	Cylinder
13020	1	Piston rod	61273	1	Bushing extension
16576	1	Gland packing spacer	61275	1	Priming tube
* 30003	1	Packing nut gasket	61407	1	Pump tube
* 30011	1	Valve cap gasket	61502	1	Passage tube
* 31047	1	Check seat gasket	* 66010	4	Ball
* 31048	1	Connector gasket	* 81721	1	Valve slide, seat & gasket
* 31049	2	Bushing gasket	90554	1	Plunger & bushing ass'y.
* 31050	1	Gland gasket	* 90560	1	Toggle plate assembly
* 31054	1	Pump tube gasket	* 90691	1	Trip rod assembly
* 33014	2	Cylinder gasket			

\* Recommended Service Parts Inventory.

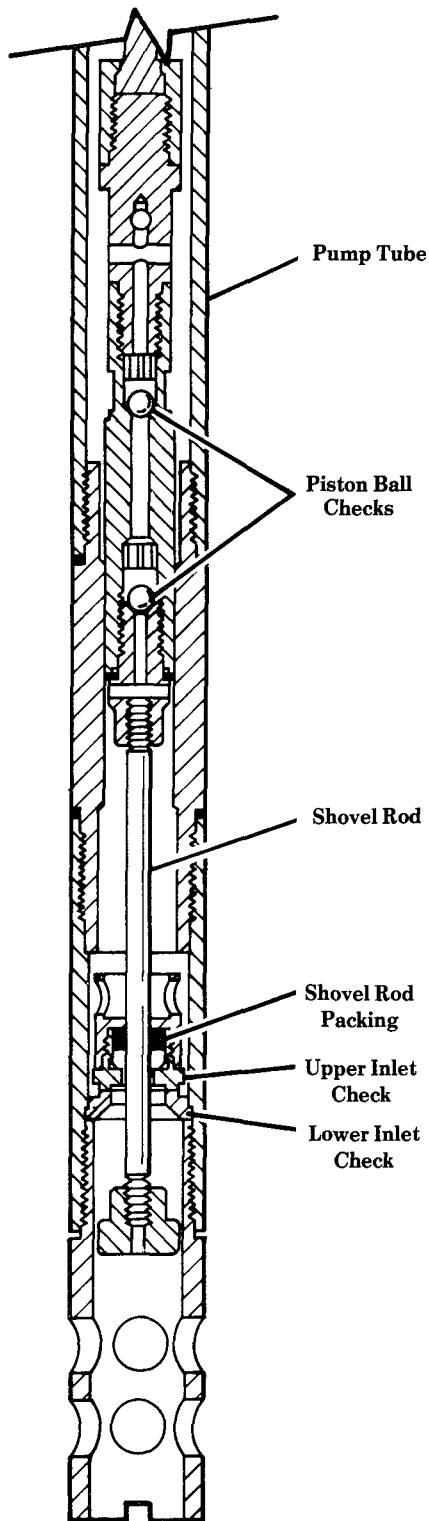

### **SERVICE OF LOWER PUMP TUBE ASSEMBLY**

Loss of pressure, volume or continuous operation of pump when not in use indicates:

- A) Foreign material lodged under Piston Ball Checks or between Upper and Lower Inlet Checks. To correct this condition the Piston Ball Checks and Inlet Checks should be removed and cleaned thoroughly. If sealing surfaces between Upper and Lower Inlet Checks are rough or pitted, replace or resurface if damage is slight.
- B) Shovel Rod Packing worn or damaged. Before installing new Packing, inspect surface of Shovel Rod and replace if rough or pitted. Do not grip Shovel Rod when disassembling lower pump tube assembly.

If pump continues to operate when not in normal use and lubricant level in drum drops, inspect lubricant supply line between pump and outlet for leaks or break in line.

#### **RETAIN THIS INFORMATION FOR FUTURE REFERENCE**

When ordering replacement parts, list: Part Number, Description, Model Number, and Series Letter.

LINCOLN ST. LOUIS provides a Distributor Network that stocks equipment and replacement parts.  
A list of Authorized Service Departments will be furnished upon request.