

GENERAL DIMENSIONS

IMPORTANT CHASSIS - 50:1 RATIO

MAXIMUM HYDRAULIC OIL TEMPERATURE: 150° F.
(If higher temperature is required, contact factory.)

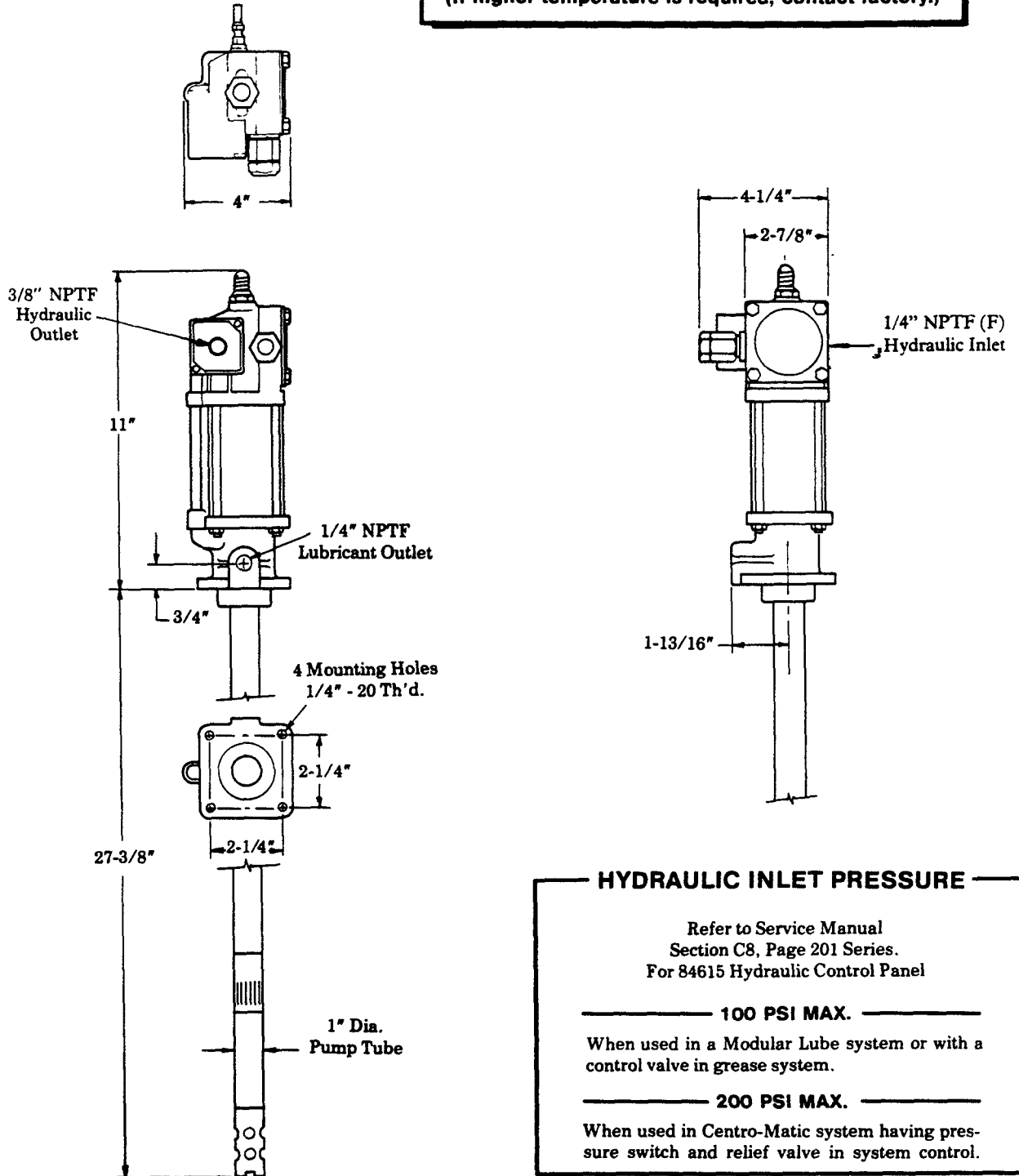

HYDRAULIC INLET PRESSURE

Refer to Service Manual
Section C8, Page 201 Series.
For 84615 Hydraulic Control Panel

————— **100 PSI MAX.** —————

When used in a Modular Lube system or with a control valve in grease system.

————— **200 PSI MAX.** —————

When used in Centro-Matic system having pressure switch and relief valve in system control.

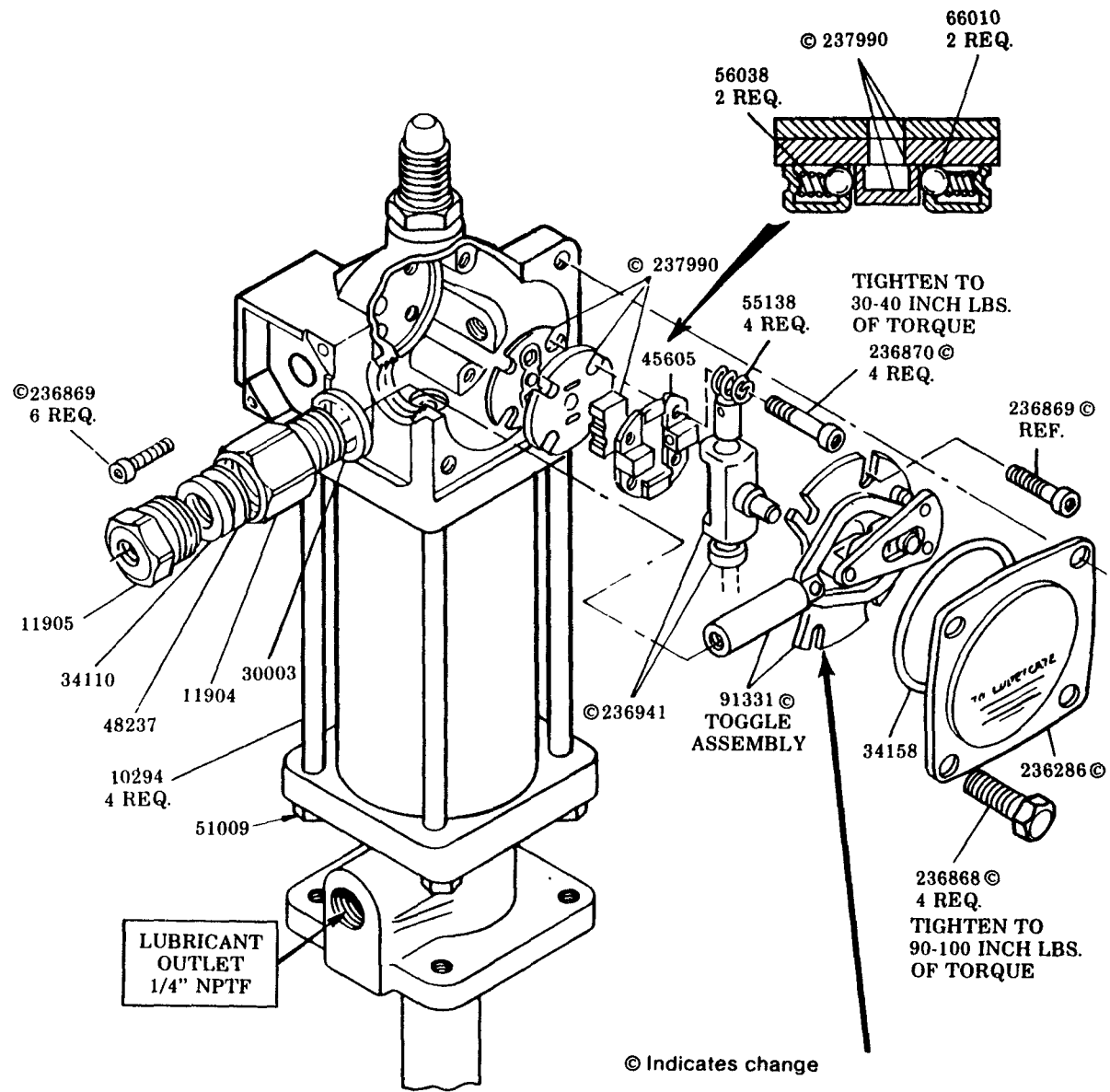
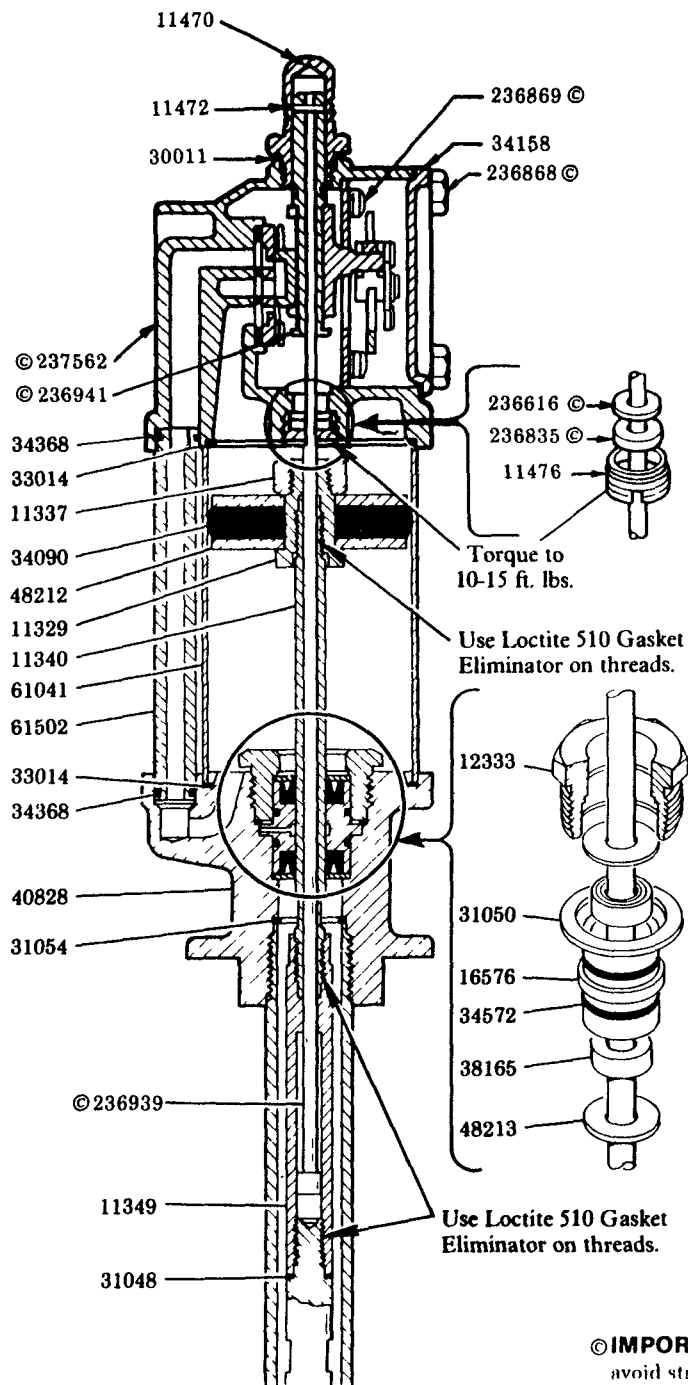

© **IMPORTANT** - Start fasteners by hand to avoid stripping threads when re-assembling

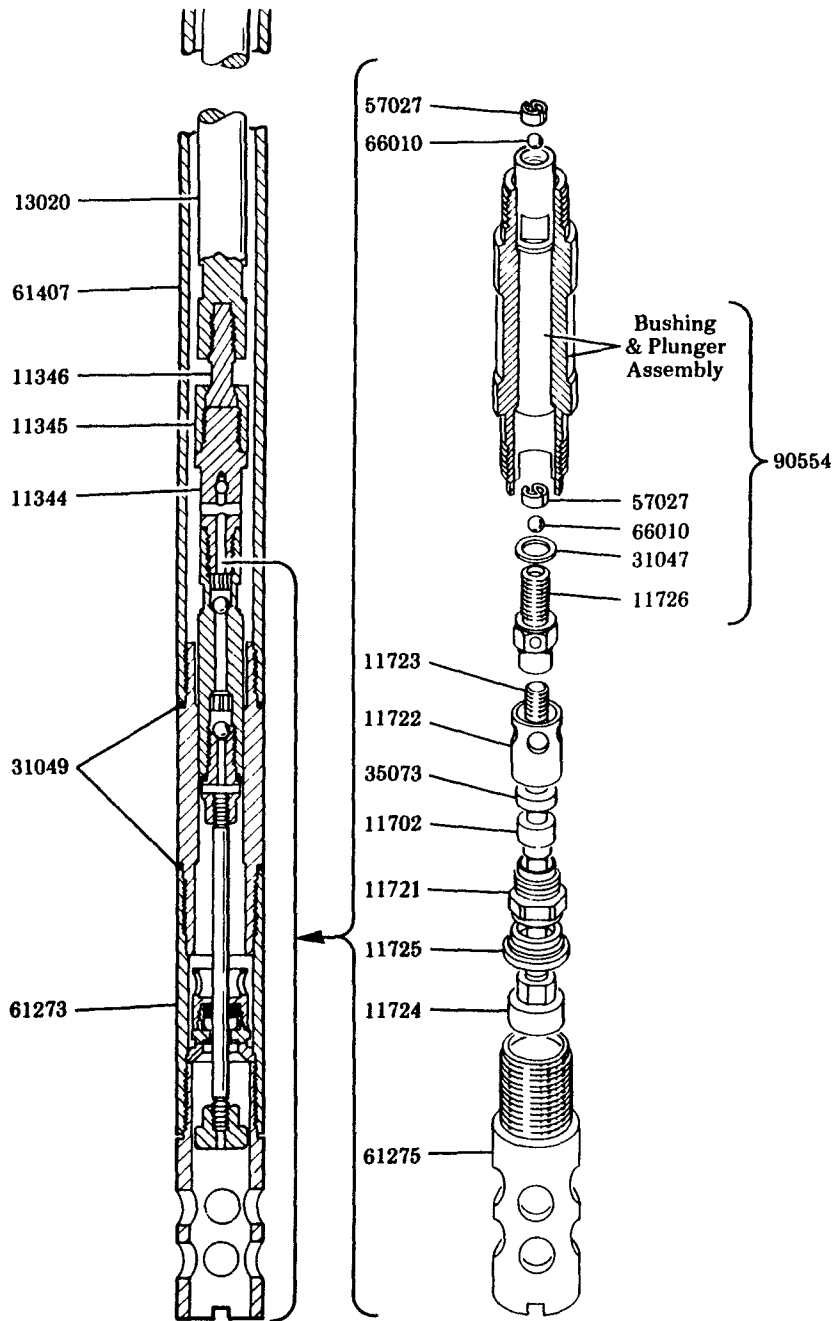

SERVICE PARTS

Part	Qty.	Description	Part	Qty.	Description
10294	4	Tie rod	*34158	1	Cover gasket
11329	1	Piston bolt	*34368	2	O-ring
11337	1	Piston nut	*34572	2	O-ring
*11340	1	Piston rod	*35073	1	Priming check packing
11344	1	Plunger adapter			
11345	1	Coupling nut	*38165	2	U-cup packing
11346	1	Coupling stud	40828	1	Outlet body
11349	1	Piston rod connector	45605	1	Valve guide plate
11470	1	Valve cap	48212	2	Piston washer
*11472	1	Trip rod pin	48213	2	Gland packing washer
11476	1	Trip rod packing nut	48237	1	Plunger packing washer
11702	1	Check washer	51009	4	Tie rod nut
*11721	1	Priming check	55138	4	Valve seat spring
11722	1	Check stop	56038	2	Spring
*11723	1	Plunger rod	57027	2	Ball stop
*11724	1	Priming plunger	61041	1	Cylinder
*11725	1	Priming check seat	61273	1	Bushing extension
11726	1	Check seat	61275	1	Priming tube
11904	1	Packing nut	61407	1	Pump tube
11905	1	Packing cap	61502	1	Passage tube
12333	1	Gland packing nut	*66010	4	Ball
13020	1	Piston rod	90554	1	Plunger & bushing ass'y.
16576	1	Gland packing spacer	*91331	1	Toggle plate assembly
*30003	1	Packing nut gasket	236286	1	Cover
*30011	1	Valve cap gasket	*236616	1	Packing nut gasket
*31047	1	Check seat gasket	*236835	1	Trip rod packing
*31048	1	Connector gasket	236868	4	Valve cover screw
*31049	2	Bushing gasket	236869	4	Toggle plate screw
*31050	1	Gland gasket	236870	4	Valve seat bolt
*31054	1	Pump tube gasket	*236939	1	Trip rod assembly
*33014	2	Cylinder gasket	236941	1	Trip shoe assembly
*34090	1	Piston packing	237569	1	Valve casting
*34110	1	Plunger packing	*237990	1	Valve slide, seat & gasket

*Recommended Service Parts Inventory.

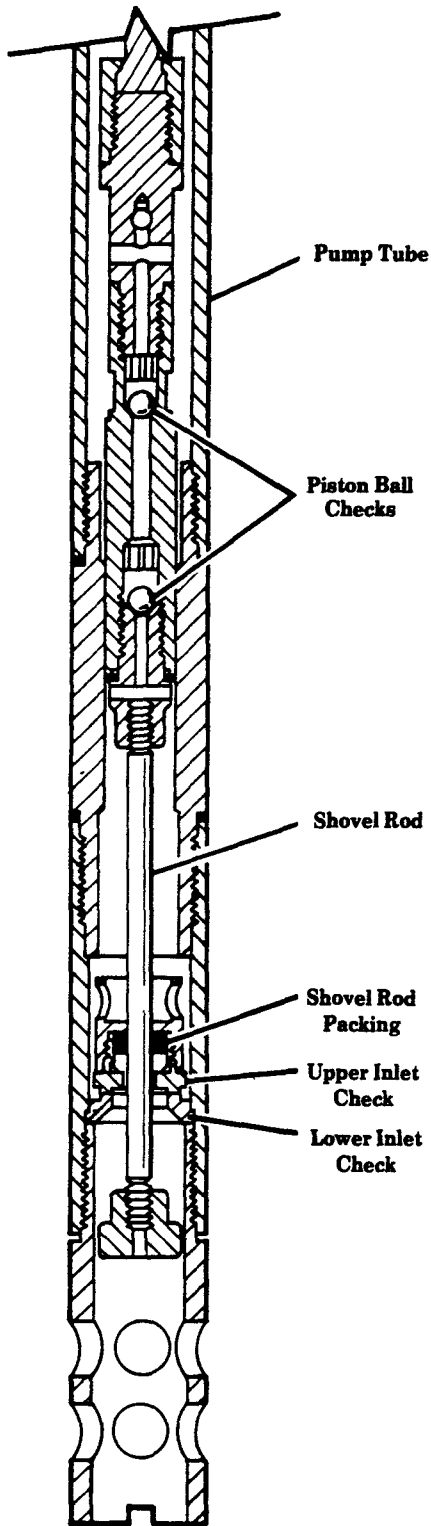

ASSEMBLY REQUIREMENTS FOR ALUMINUM GASKET PLATE

1. Valve Cavity must not be packed with grease which is a standard requirement for the other Air Motors.
2. The Head Casting, Valve Plate and Gasket Plate should be clean and free of oil or grease.
3. A thin bead of RTV sealant should be applied around all three holes of the Gasket Plate. This application should be on both sides of the Gasket Plate.
4. The Gasket Plate should then be sandwiched between the Head Casting and the Valve Plate so that the parts align as required.
5. Use a high pressure Air Gun to blow excess sealant out of the Valve Port Holes.
6. The assembly should be allowed to set for at least one hour before assembling and testing with high air pressure. If testing occurs before this elapsed time leakage may result.

SERVICE OF LOWER PUMP TUBE ASSEMBLY

Loss of pressure, volume or continuous operation of pump when not in use indicates:

- A) Foreign material lodged under Piston Ball Checks or between Upper and Lower Inlet Checks. To correct this condition the Piston Ball Checks and Inlet Checks should be removed and cleaned thoroughly. If sealing surfaces between Upper and Lower Inlet Checks are rough or pitted, replace or resurface if damage is slight.
- B) Shovel Rod Packing worn or damaged. Before installing new Packing, inspect surface of Shovel Rod and replace if rough or pitted. Do not grip Shovel Rod when disassembling lower pump tube assembly.

If pump continues to operate when not in normal use and lubricant level in drum drops, inspect lubricant supply line between pump and outlet for leaks or break in line.

RETAIN THIS INFORMATION FOR FUTURE REFERENCE

When ordering replacement parts, list: Part Number, Description, Model Number, and Series Letter.

LINCOLN provides a Distributor Network that stocks equipment and replacement parts.