

SPECIFICATIONS

Maximum operating air pressure 200 P.S.I.

WARNING
DO NOT OPERATE
THIS UNIT WITH
COMBUSTIBLE GAS

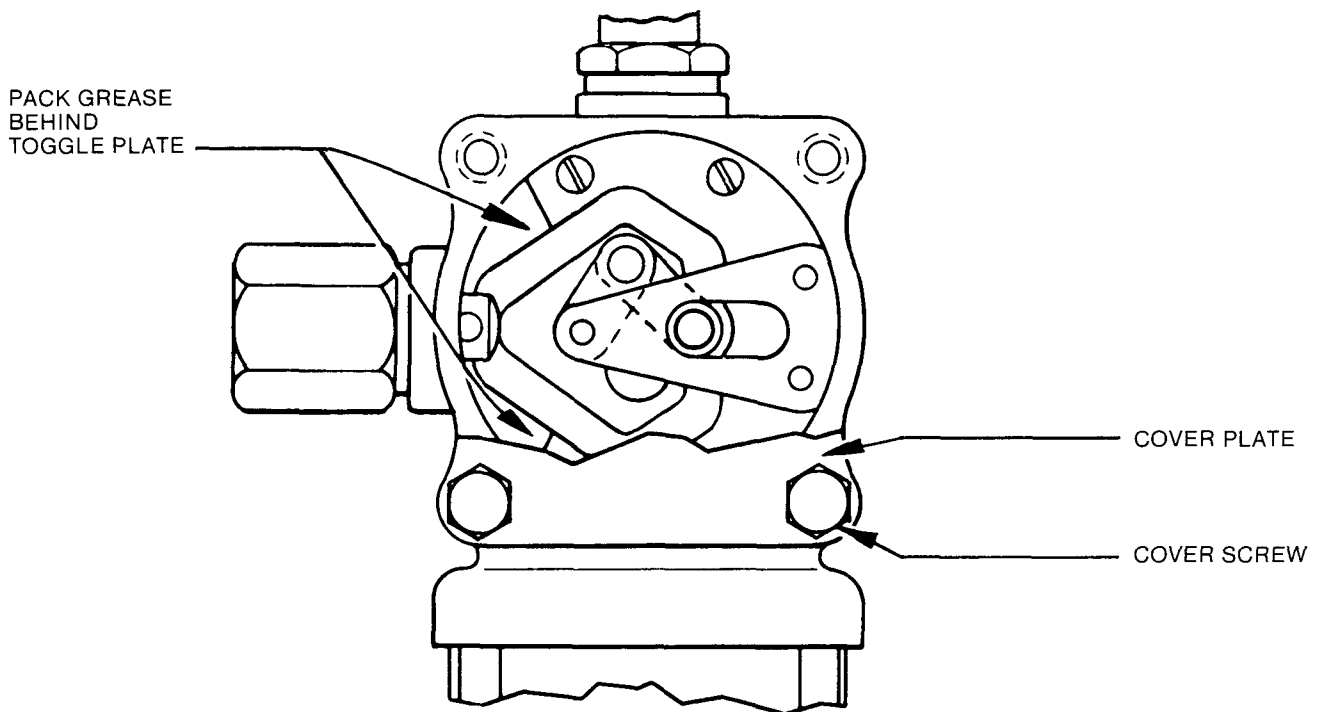

TO LUBRICATE AIR VALVE MECHANISM

Disconnect air to pump. Remove the four Cover Screws, Cover Plate and Cover Plate Gasket. Remove and disassemble the Air Valve Casting from the Air Motor. The Air Valve Casting should be cleaned or flushed to remove any chips, or other foreign particles prior to reassembly.

Before replacing the Toggle Assembly, pack cavity with grease. Use N.L.G.I. No. 1 (light grade) water repellent grease, approximately 1½ ounces. Replace Cover Gasket, Cover and Screws, tighten to avoid air leaks.

Periodic inspection of parts at least once each year is advisable.

Model 82737 POWER-MASTER 2 AIR MOTOR

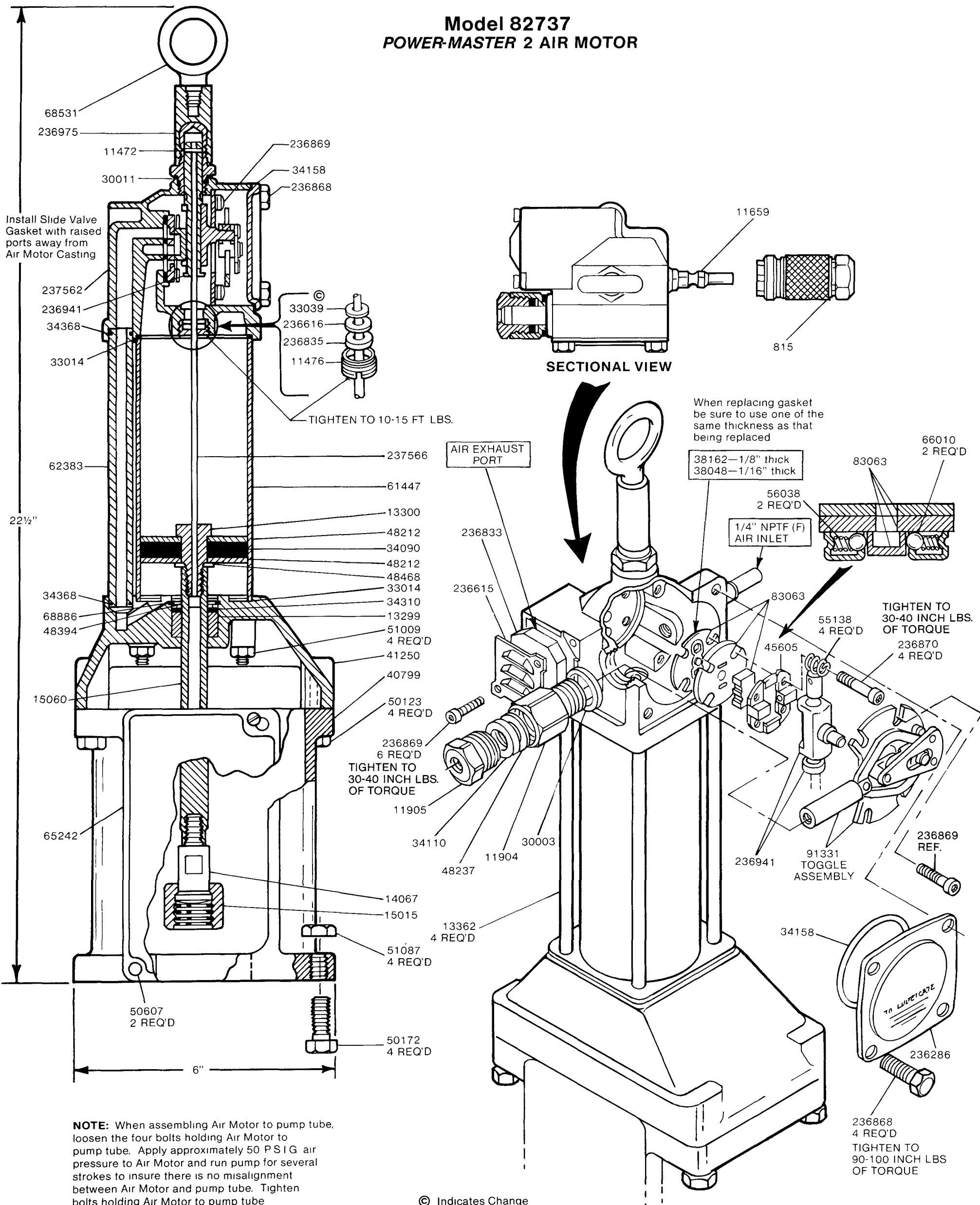

68531

236975

11472

30011

236869

34158

236868

237562

236941

34368

33014

33039

236616

236835

11476

TIGHTEN TO 10-15 FT. LBS.

62383

237566

61447

13300

48212

34090

48212

48468

33014

34310

13299

51009

4 REQ'D

41250

40799

50123

4 REQ'D

236869

6 REQ'D

TIGHTEN TO 30-40 INCH LBS. OF TORQUE

11905

34110

11904

30003

48237

14067

15015

51087

4 REQ'D

50607

2 REQ'D

50172

4 REQ'D

65242

50607

2 REQ'D

6"

22 1/2"

11659

815

SECTIONAL VIEW

When replacing gasket be sure to use one of the same thickness as that being replaced

38162—1/8" thick

38048—1/16" thick

56038

2 REQ'D

1/4" NPTF (F) AIR INLET

83063

66010

2 REQ'D

TIGHTEN TO 30-40 INCH LBS. OF TORQUE

55138

4 REQ'D

TIGHTEN TO 30-40 INCH LBS. OF TORQUE

236870

4 REQ'D

236833

236615

83063

55138

4 REQ'D

91331

TOGGLE ASSEMBLY

236869

REF.

34158

TO LUBRICATE

236286

236868

4 REQ'D

TIGHTEN TO 90-100 INCH LBS OF TORQUE

SERVICE PARTS

Part	Description	Part	Description
815	Air coupler	50123	Hex. head screw
*11472	Trip rod pin	50172	Bolt
11476	Trip rod packing nut	50607	Rd. head screw
11659	Air coupler nipple	51009	Tie rod nut
11904	Packing nut	51087	Nut
11905	Packing cap	55138	Valve seat spring
13299	Spacer	*56038	Spring
13300	Piston bolt	61447	Air cylinder
13362	Tie rod	62383	Air passage tube
14067	Coupling stud	65242	Serial plate
15015	Coupling nut	*66010	Equalizer ball
*15060	Piston rod	68531	Eye bolt
*30003	Packing nut gasket	68886	Retaining ring
*30011	Valve cap gasket	*83063	Slide valve & springs
*33014	Air cylinder gasket	*91331	Toggle plate assembly
*33039	Gasket	236286	Cover
*34090	Air piston packing	236615	Muffler cover
*34110	Plunger packing	*236616	Packing nut gasket
*34158	Cover gasket	236833	Muffler
*34310	Packet	*236835	Trip rod packing
*34368	O-ring (BUNA-N)	236868	Valve cover screw
40799	Air motor support casting	236869	Toggle plate screw
41250	Cylinder head casting	236870	Valve seat bolt
45605	Valve guide plate	236941	Trip shoe assembly
48212	Air piston washer	236975	Extension adapter
48237	Plunger packing washer	237562	Air valve casting
48394	Washer	*237566	Trip rod assembly
48468	Washer		

* Recommended Service Parts Inventory.

RETAIN THIS INFORMATION FOR FUTURE REFERENCE

When ordering replacement parts, list: Part Number, Description, Model Number, and Series Letter.

LINCOLN provides a Distributor Network that stocks equipment and replacement parts.