

**WARNING**  
DO NOT OPERATE  
WITH COMBUSTIBLE GAS

# PILE DRIVER PUMPS

(SHOVEL TYPE FOOT VALVE)

## AIRMOTOR MODELS

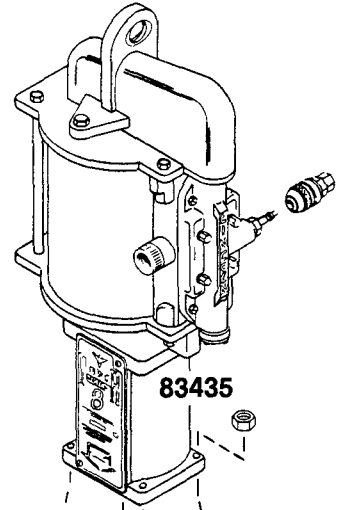
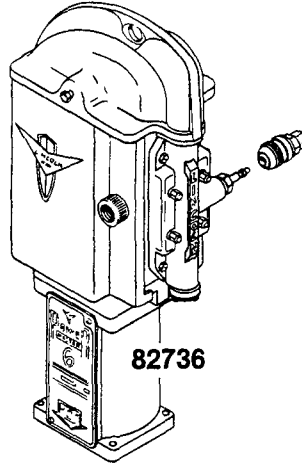
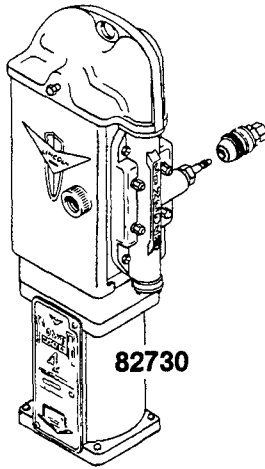

### ATTACHING AIRMOTOR TO PUMPTUBE

- 1- Tightly connect airmotor coupling nut to pump plunger.
- 2- Attach airmotor to the pump outlet body flange with the four bolts and nuts (hand tight) supplied with airmotor.
- 3- Slowly cycle the pump several times, using just enough air pressure to operate the pump without stalling.
- 4- Stop the pump on an "up" stroke and tighten the four bolts and nuts to securely fasten the airmotor to the pumptube.

### GLAND PACKING LUBE WELL

Many materials such as ink, undercoating, buffing compounds, etc. tend to build up and dry out on the pump rod. This causes the gland packings to wear out rapidly. To prevent material buildup on the pump rod, fill the lube well with a fluid compatible with the material that is to be pumped.

The lube well is accessible for inspection and filling by removing the Power-Master name plate from the side of the airmotor.

**CAUTION:** Do not fill lube well to full capacity as the reciprocating movement of the airmotor piston rod may draw the fluid into the airmotor.

1-1/2" NPTF (F)  
OUTLET

GLAND  
PACKING  
LUBE WELL

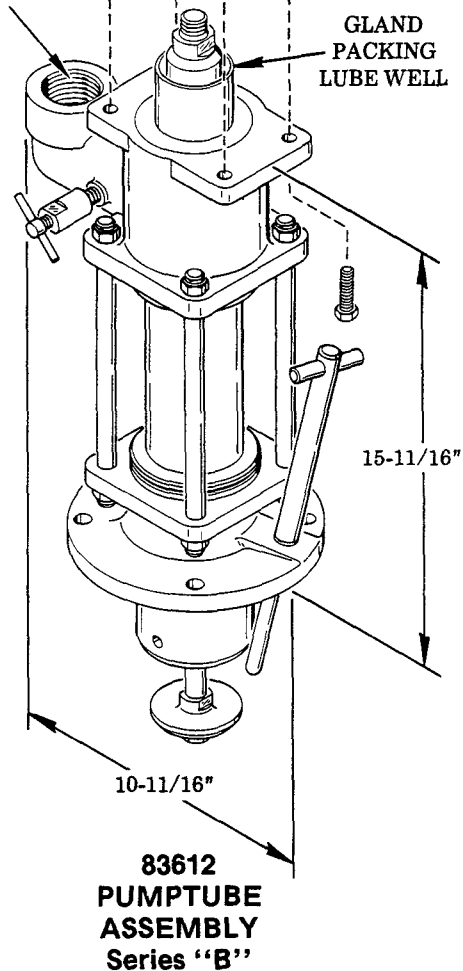

### MODEL CHART

(\*Size of airmotor used with pumptube determines pump ratio.)

PUMPTUBE	PUMP MODEL	*RATIO	MAXIMUM AIR PRESSURE	AIRMOTOR	AIRMOTOR SERVICE PAGE
<b>83612</b>	2251	5:1	200 psi	82730	A-50, Pg. 3 Series
	2271	10:1	100 psi	82736	A-50, Pg. 3 Series
	2291	18:1	100 psi	83435	A-50, Pg. 6 Series



One Lincoln Way St. Louis, Missouri 63120-1578  
(314) 679-4200 Telex 44881

**SECTION - A50**  
**PAGE - 40C**

## 83612 PUMPTUBE ASSEMBLY Series "B"

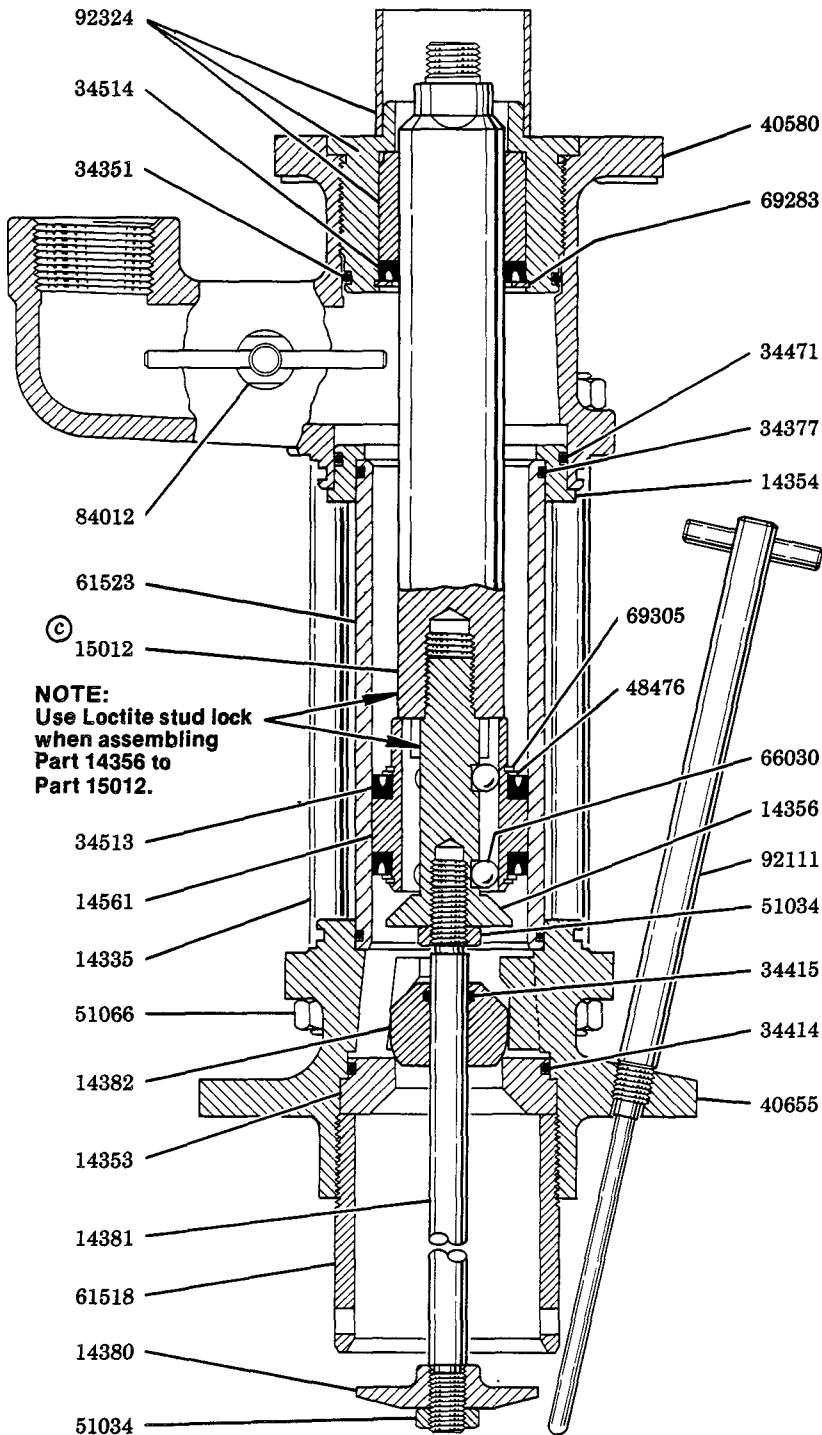

**NOTE:**  
Use Loctite stud lock  
when assembling  
Part 14356 to  
Part 15012.

**OPTIONAL:** 83979 Teflon Packing Conversion Kit.  
Refer to Service Manual  
Section K4, Pg. 19 Series.

© Indicates change

## SERVICE OF LOWER PUMPING UNIT

Loss of volume and pressure or continuous operation of pump when not in normal use indicates:

- 1) Material supply in drum may not be adequate.
- 2) Air supply may not be adequate. Check setting of air supply line regulator.
- 3) Pump may operate on down stroke only, due to material by-passing the 14356 Check and piston. Remove and clean parts. Inspect seating surfaces for wear. Replace if necessary.
- 4) Material by-passing the piston packings. 34513 U-cup Packings may be worn or damaged. Replace packings. Inside of pump tube may be scored or rough. Remove and inspect pump tube. If area inside of tube where piston packings travel is scored or rough, replace the pump tube.
- 5) Pump is operating but not dispensing material. 14382 Check in foot valve is not seating. Inspect check and seat for foreign particles or wear. Also inspect 34415 O-ring in check and 34414 O-ring in check seat. Replace parts if necessary.
- 6) Material by-passing 34514 U-cup Packing in gland assembly. Replace packing.
- 7) Plunger may be scored, pitted or worn. Replace plunger.

**NOTE:** 69278 Adjustable Spanner Wrench and 69294 Face Spanner Wrench are available for service of pumtube assembly.

### SERVICE PARTS

PART	QUAN.	DESCRIPTION
14335	4	Tie rod
*14353	1	Check seat
14354	1	Adapter ring
*14356	1	Check
14380	1	Priming plunger nut
*14381	1	Priming rod
*14382	1	Check
*14561	1	Piston
*15012	1	Plunger
*34351	1	O-ring
*34377	2	O-ring
*34414	1	O-ring
*34415	1	O-ring
*34471	1	O-ring
*34513	2	U-cup packing
*34514	1	U-cup packing
40580	1	Outlet body
40655	1	Adapter plate
48476	2	Washer
51034	2	Nut
51066	8	Nut
61518	1	Tube
61523	1	Pump tube
66030	6	Ball
69283	1	Retaining ring
69305	2	Retaining ring
84012	1	Bleeder valve
92111	1	Probe assembly
92324	1	Bushing & gland nut assembly

\*Recommended service parts inventory.

### RETAIN THIS INFORMATION FOR FUTURE REFERENCE

When ordering replacement parts, list: Part Number, Description, Model Number, and Series Letter.

LINCOLN provides a Distributor Network that stocks equipment and replacement parts.  
A list of Authorized Service Departments will be furnished upon request.