

# PILE DRIVER PUMPTUBE

FOR VISCOUS BULK SYSTEMS  
(SHOVEL TYPE FOOT VALVE)



**WARNING**  
DO NOT OPERATE  
WITH COMBUSTIBLE GAS

## Model 84576

## Series "A"

### AIRMOTOR MODELS

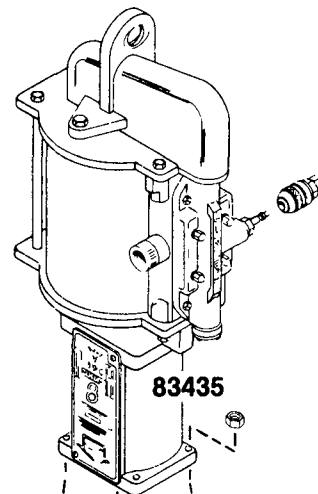
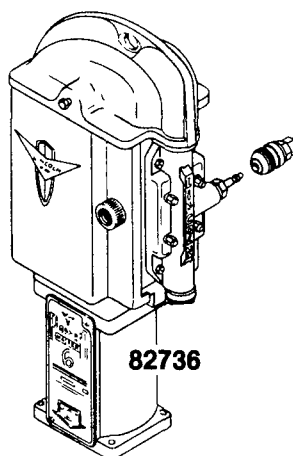
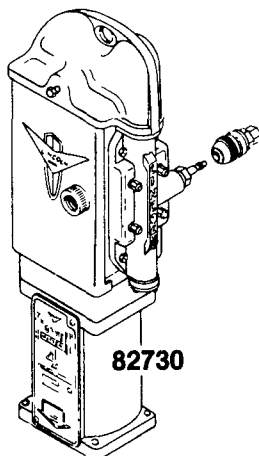

### ATTACHING AIRMOTOR TO PUMPTUBE

- 1- Tightly connect airmotor coupling nut to pump plunger.
- 2- Attach airmotor to the pump outlet body flange with the four bolts and nuts (hand tight) supplied with airmotor.
- 3- Slowly cycle the pump several times, using just enough air pressure to operate the pump without stalling.
- 4- Stop the pump on an "up" stroke and tighten the four bolts and nuts to securely fasten the airmotor to the pumptube.

### GLAND PACKING LUBE WELL

Many materials such as ink, undercoating, buffing compounds, etc. tend to build up and dry out on the pump rod. This causes the gland packings to wear out rapidly. To prevent material buildup on the pump rod, fill the lube well with a fluid compatible with the material that is to be pumped.

The lube well is accessible for inspection and filling by removing the Power-Master name plate from the side of the airmotor.

**CAUTION:** Do not fill lube well to full capacity as the reciprocating movement of the airmotor piston rod may draw the fluid into the airmotor.

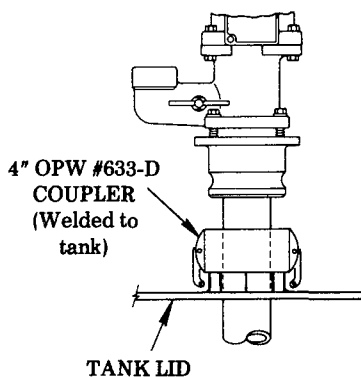

TYPICAL INSTALLATION

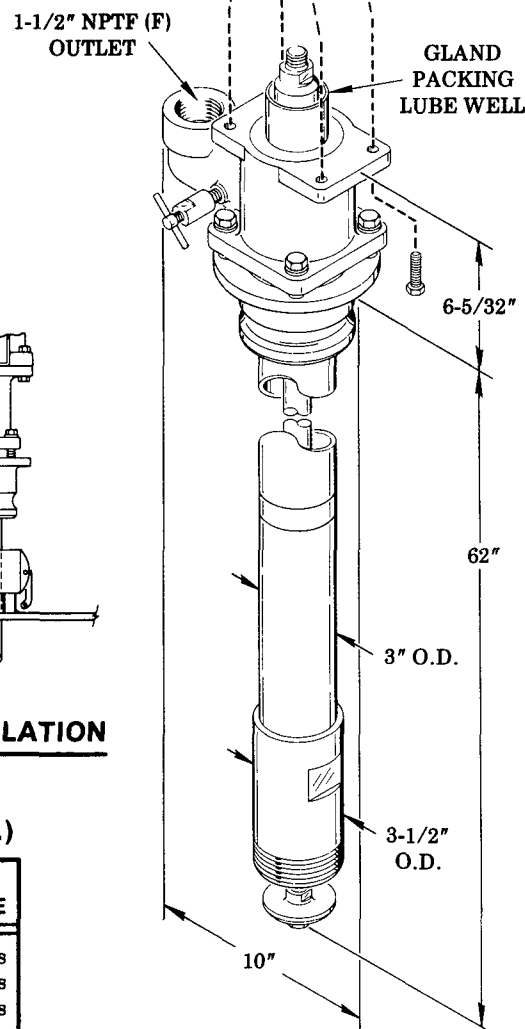

### AIRMOTOR SELECTION CHART

(\*Size of airmotor used with pumptube determines pump ratio.)

PUMPTUBE	AIRMOTOR	*RATIO	MAXIMUM AIR PRESSURE	AIRMOTOR SERVICE PAGE
84576	82730	5:1	200 psi	A-50, Pg. 3 Series
	82736	10:1	100 psi	A-50, Pg. 3 Series
	83435	18:1	100 psi	A-50, Pg. 6 Series

**LINCOLN ST. LOUIS**  
4010 GOODFELLOW BLVD • ST LOUIS, MO 63120 • (314) 383 5900

A DIVISION OF  
**McNEIL**  
CORPORATION

SECTION - **A50**  
PAGE - **58**

# 84576 PUMPTUBE ASSEMBLY Series "A"

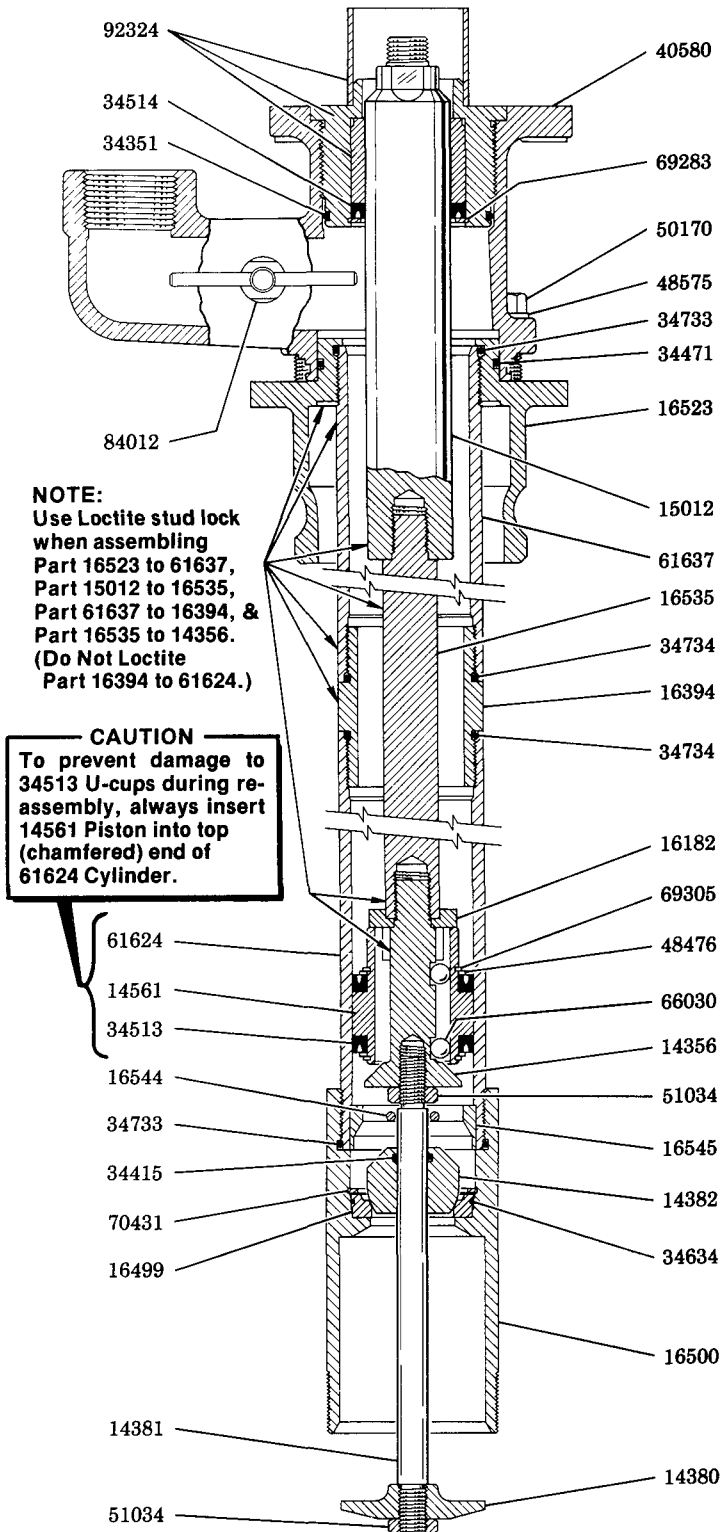

\*Recommended service parts inventory.

## SERVICE OF LOWER PUMPING UNIT

Loss of volume and pressure or continuous operation of pump when not in normal use indicates:

- 1) Material supply in tank may not be adequate.
- 2) Air supply may not be adequate. Check setting of air supply line regulator.
- 3) Pump may operate on down stroke only, due to material by-passing the 14356 Check and piston. Remove and clean parts. Inspect seating surfaces for wear. Replace if necessary.
- 4) Material by-passing the piston packings. 34513 U-cup Packings may be worn or damaged. Replace packings. Inside of 61624 Pump Tube may be scored or rough. Remove and inspect pump tube. If area inside of tube where piston packings travel is scored or rough, replace the pump tube.
- 5) Pump is operating but not dispensing material. 14382 Check in foot valve is not seating. Inspect check and seat for foreign particles or wear. Also inspect 34415 O-ring in check and 34634 O-ring in check seat. Replace parts if necessary.
- 6) Material by-passing 34514 U-cup Packing in gland assembly. Replace packing.
- 7) Plunger may be scored, pitted or worn. Replace plunger.

NOTE: 69294 Face Spanner Wrench is available for service of pumptube assembly.

## SERVICE PARTS

PART	QUAN.	DESCRIPTION
*14356	1	Check
*14380	1	Priming plunger nut
*14381	1	Priming rod
*14382	1	Check
*14561	1	Piston
*15012	1	Plunger
16182	1	Piston stop
16394	1	Cylinder connector
*16499	1	Check seat
16500	1	Check housing
16523	1	Tube adapter
16535	1	Connecting rod
16544	2	Pin
16545	1	Check retainer
*34351	1	O-ring
*34415	1	O-ring
*34471	1	O-ring
*34513	2	U-cup packing
*34514	1	U-cup packing
*34634	1	O-ring
*34733	2	O-ring
*34734	2	O-ring
40580	1	Outlet body
48476	2	Washer
48575	4	Washer
50170	4	Screw
51034	2	Nut
61624	1	Cylinder
61637	1	Cylinder
66030	6	Ball
69283	1	Retaining ring
69305	2	Retaining ring
70431	1	Retaining ring
84012	1	Bleeder valve
92324	1	Bushing & gland nut assembly

### RETAIN THIS INFORMATION FOR FUTURE REFERENCE

When ordering replacement parts, list: Part Number, Description, Model Number, and Series Letter.

LINCOLN ST. LOUIS provides a Distributor Network that stocks equipment and replacement parts. A list of Authorized Service Departments will be furnished upon request.