

# POWER-MASTER PUMPTUBE

FOR VISCOUS BULK SYSTEMS  
(SHOVEL TYPE FOOT VALVE)



**WARNING**  
DO NOT OPERATE  
WITH COMBUSTIBLE GAS

# Model 84577

## Series "A"

### AIRMOTOR MODELS

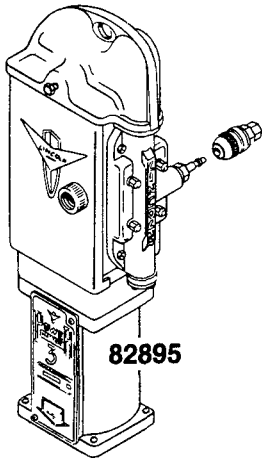

82895

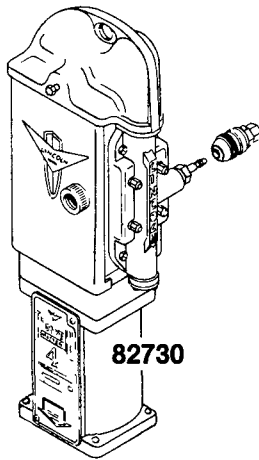

82730

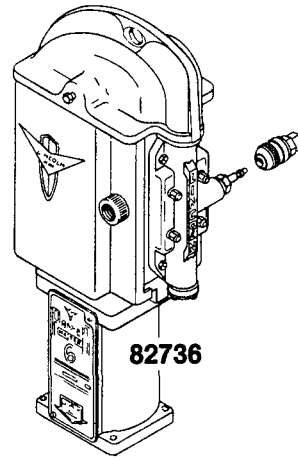

82736

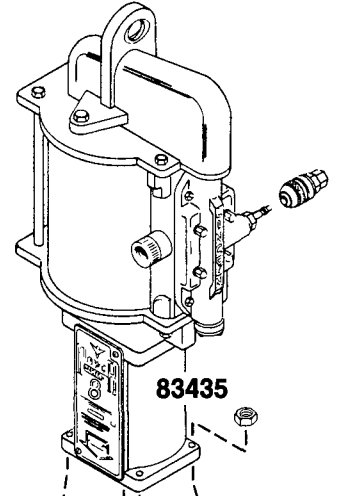

83435

### ATTACHING AIRMOTOR TO PUMPTUBE

- 1- Tightly connect airmotor coupling nut to pump plunger.
- 2- Attach airmotor to the pump outlet body flange with the four bolts and nuts (hand tight) supplied with airmotor.
- 3- Slowly cycle the pump several times, using just enough air pressure to operate the pump without stalling.
- 4- Stop the pump on an "up" stroke and tighten the four bolts and nuts to securely fasten the airmotor to the pumptube.

### GLAND PACKING LUBE WELL

Many materials such as ink, undercoating, buffing compounds, etc. tend to build up and dry out on the pump rod. This causes the gland packings to wear out rapidly. To prevent material buildup on the pump rod, fill the lube well with a fluid compatible with the material that is to be pumped.

The lube well is accessible for inspection and filling by removing the Power-Master name plate from the side of the airmotor.

**CAUTION:** Do not fill lube well to full capacity as the reciprocating movement of the airmotor piston rod may draw the fluid into the airmotor.

GLAND  
PACKING  
LUBE WELL

1/2" NPTF (F)  
OUTLET

3-17/32"

34"

2-1/8"  
O.D.

2-1/2" OPW #633-D  
COUPLER  
(Welded to  
tank)

TANK LID

### TYPICAL INSTALLATION

### AIRMOTOR SELECTION CHART

(\*Size of airmotor used with pumptube determines pump ratio.)

PUMPTUBE	AIRMOTOR	*RATIO	MAXIMUM AIR PRESSURE	AIRMOTOR SERVICE PAGE
84577	82895	7:1	200 psi	A-50, Pg. 3 Series
	82730	14:1	200 psi	A-50, Pg. 3 Series
	82736	28:1	100 psi	A-50, Pg. 3 Series
	83435	48:1	100 psi	A-50, Pg. 6 Series

**LINCOLN ST. LOUIS**  
4010 GOODFELLOW BLVD • ST LOUIS, MO 63120 • (314) 383-5900



A DIVISION OF  
**McNEIL**  
CORPORATION

SECTION - **A50**  
PAGE - **59**

## SERVICE PARTS

PART	QUAN.	DESCRIPTION
11948	1	Check seat
12017	1	Body
12018	1	Adapter
13227	1	Retainer
*13228	1	Check seat
*13229	1	Check
13235	1	Priming plunger nut
*14859	1	Piston
14861	1	Female adapter
14993	1	Male adapter
14994	1	Piston rod guide
*15013	1	Plunger rod
16445	1	Piston rod
*16503	1	Piston check
*31033	2	Gasket
*34296	1	O-ring
*34309	2	O-ring
*34401	1	U-cup packing
*38160	4	V-packing (Leather)
*38167	1	V-packing (Teflon)
*45826	1	Guide washer
48515	2	Washer
48614	1	Washer
55262	1	Spring
57036	1	Ball stop
57142	3	Wave washer
61427-7	1	Bushing tube
61428	1	Priming tube
61626	1	Adapter tube
61638	1	Pump tube
62648	1	Rod
66197	2	Cotter pin
66285	1	Ball
66310	1	Cotter pin
67359	1	Plug
*68482	1	Retaining ring
68908	1	Retaining ring
*83849	1	Packing and retainer
93296	1	Gland nut
*93482	1	Bushing and rod
93513	1	Outlet body

\*Recommended service parts inventory.

## SERVICE OF LOWER PUMPING UNIT

Loss of volume and pressure or continuous operation of pump when not in normal use indicates:

- 1) Material supply in tank may not be adequate.
- 2) Air supply may not be adequate. Check setting of air supply line regulator.
- 3) Pump may operate on down stroke only, due to material bypassing the 16503 Check and piston. Remove and clean parts. Inspect seating surfaces for wear. Replace if necessary.
- 4) Material by-passing the piston packings. 38160 and 38167 V-packings may be worn or damaged. Replace packings. Inside of 61427-7 Pump Tube may be scored or rough. Remove and inspect pump tube. If area inside of tube where piston packings travel is scored or rough, replace the pump tube.
- 5) Pump is operating but not dispensing material. Inlet check is not sealing. Inspect 93482 Bushing & Rod, 13229 Check and 13228 Check Seat for foreign particles or wear. Replace parts if necessary.

## 84577 PUMPTUBE ASSEMBLY Series "A"

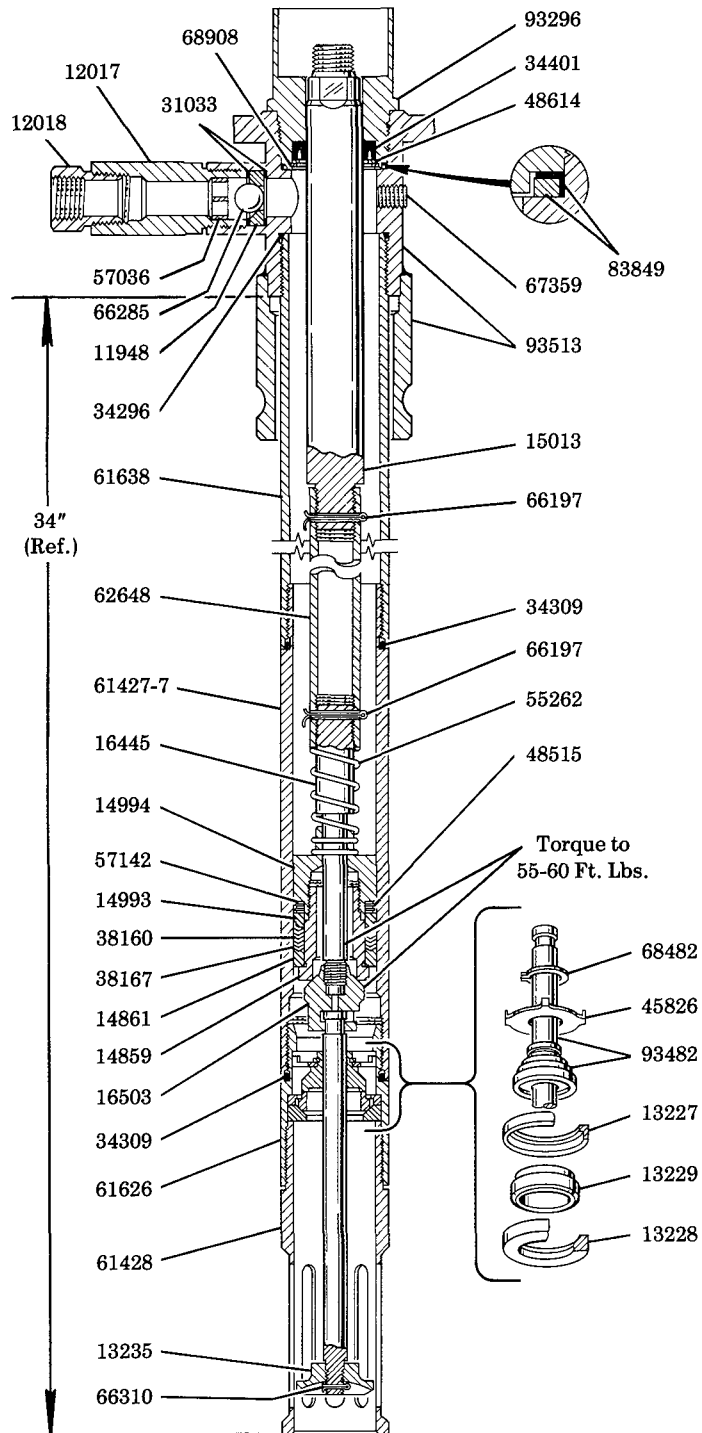

- 6) Material by-passing 34401 U-cup Packing in gland assembly. Replace packing.
- 7) Plunger may be scored, pitted or worn. Replace plunger.

### RETAIN THIS INFORMATION FOR FUTURE REFERENCE

When ordering replacement parts, list: Part Number, Description, Model Number, and Series Letter.

LINCOLN ST. LOUIS provides a Distributor Network that stocks equipment and replacement parts. A list of Authorized Service Departments will be furnished upon request.