

POWER-MASTER PUMPTUBE

FOR FLUID & SEMI-FLUID BULK SYSTEMS
(BALL TYPE FOOT VALVE)



WARNING
DO NOT OPERATE
WITH COMBUSTIBLE GAS

Model 84571

Series "A"

AIRMOTOR MODELS

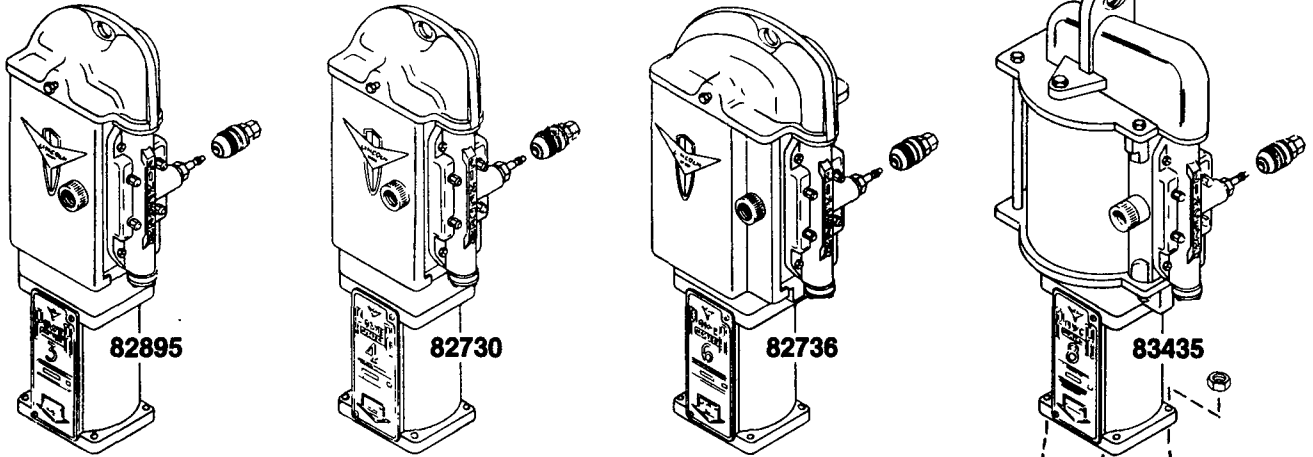

ATTACHING AIRMOTOR TO PUMPTUBE

- 1- Tightly connect airmotor coupling nut to pump plunger.
- 2- Attach airmotor to the pump outlet body flange with the four bolts and nuts (hand tight) supplied with airmotor.
- 3- Slowly cycle the pump several times, using just enough air pressure to operate the pump without stalling.
- 4- Stop the pump on an "up" stroke and tighten the four bolts and nuts to securely fasten the airmotor to the pumptube.

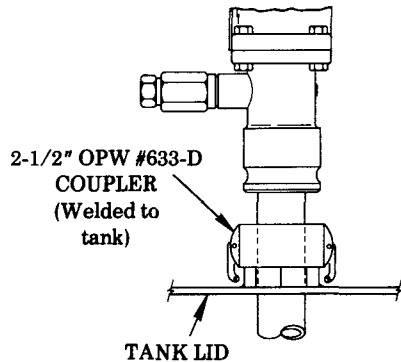

TYPICAL INSTALLATION

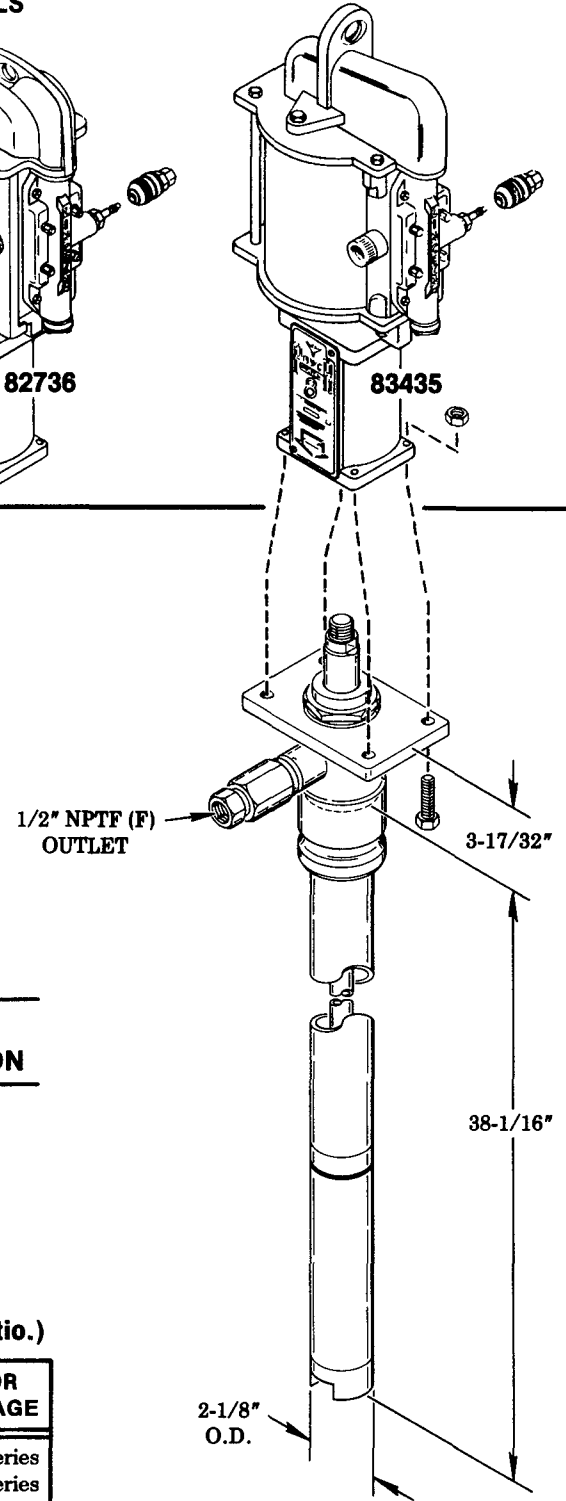

AIRMOTOR SELECTION CHART

(*Size of airmotor used with pumptube determines pump ratio.)

PUMPTUBE	AIRMOTOR	*RATIO	MAXIMUM AIR PRESSURE	AIRMOTOR SERVICE PAGE
84571	82895	6:1	200 psi	A-50, Pg. 3 Series
	82730	12:1	200 psi	A-50, Pg. 3 Series
	82736	24:1	100 psi	A-50, Pg. 3 Series
	83435	42:1	100 psi	A-50, Pg. 6 Series

LINCOLN ST. LOUIS
4010 GOODFELLOW BLVD. • ST LOUIS, MO 63120 • (314) 383 5900

A DIVISION OF
McNEIL
CORPORATION

SECTION - **A50**
PAGE - **62**

84571 PUMPTUBE ASSEMBLY Series "A"

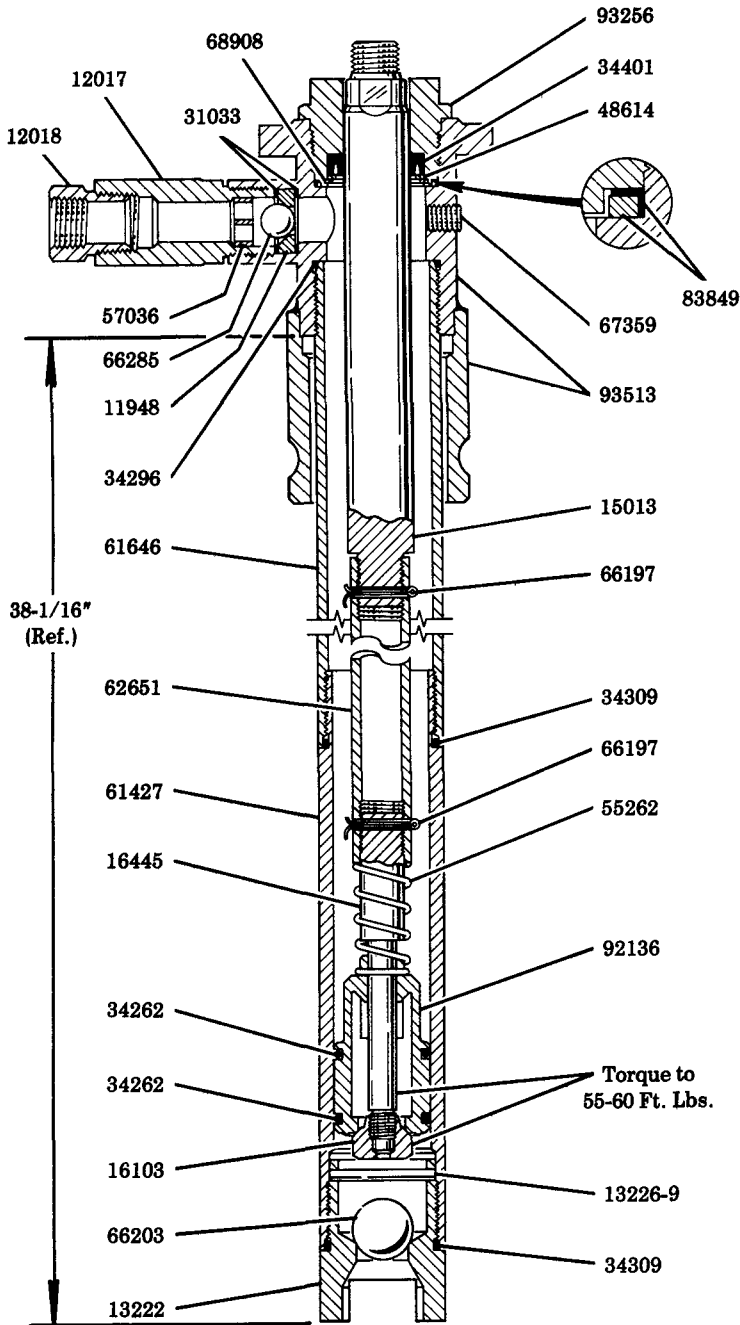

SERVICE OF LOWER PUMPING UNIT

Loss of volume and pressure or continuous operation of pump when not in normal use indicates:

- 1) Material supply in tank may not be adequate.
- 2) Air supply may not be adequate. Check setting of air supply line regulator.
- 3) Pump may operate on down stroke only, due to material by-passing the 16103 Check and piston. Remove and clean parts. Inspect seating surfaces for wear. Replace if necessary.
- 4) Material by-passing the piston packings. 34262 O-rings may be worn or damaged. Replace O-rings. Inside of 61427 Pump Tube may be scored or rough. Remove and inspect pump tube. If area inside of tube where piston packings travel is scored or rough, replace the pump tube.
- 5) Pump is operating but not dispensing material. 66203 Ball Check in foot valve is not seating. Inspect ball check and seat for foreign particles or wear. Also inspect 34309 O-ring on foot valve body. Replace parts if necessary.
- 6) Material by-passing 34401 U-cup Packing in gland assembly. Replace packing.
- 7) Plunger may be scored, pitted or worn. Replace plunger.

SERVICE PARTS

PART	QUAN.	DESCRIPTION
11948	1	Check seat
12017	1	Body
12018	1	Bushing
*13222	1	Foot valve body
13226-9	1	Ball retaining pin
*15013	1	Plunger
*16103	1	Piston check
16445	1	Piston rod
*31033	2	Gasket
*34262	2	O-ring
*34296	1	O-ring
*34309	2	O-ring
*34401	1	U-cup packing
48614	1	Washer
55262	1	Spring
57036	1	Ball stop
61427	1	Bushing tube
61646	1	Pump tube
62651	1	Rod
66197	2	Cotter pin
*66203	1	Ball
66285	1	Ball
67359	1	Pipe plug
68908	1	Retaining ring
*83849	1	Packing & retainer
*92136	1	Piston
93256	1	Gland nut
93513	1	Outlet body

*Recommended service parts inventory.

RETAIN THIS INFORMATION FOR FUTURE REFERENCE

When ordering replacement parts, list: Part Number, Description, Model Number, and Series Letter.

LINCOLN ST. LOUIS provides a Distributor Network that stocks equipment and replacement parts.

A list of Authorized Service Departments will be furnished upon request.