

WARNING
DO NOT OPERATE
WITH COMBUSTIBLE GAS

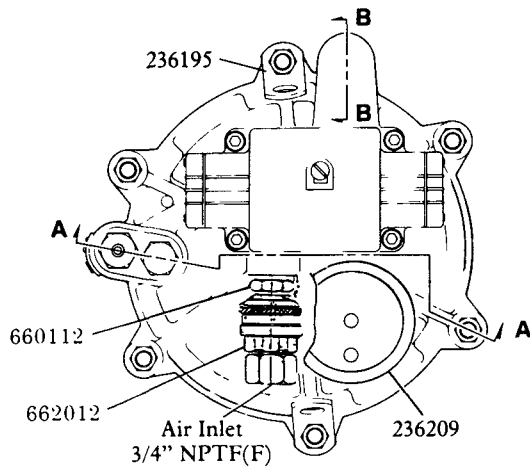

SPECIFICATIONS

- Max. Operating Pressure:..... 100 PSI
- Min. Operating Pressure:..... 30 PSI
- Max. Recommended Continuous Speed: . . . 75 Cycles/ Minute
- Max. Air Consumption: 290 SCFM @ 75 CPM w/ 100 PSI Air
- Operating Temperature Range: -30°F (-34°C) to 250°F (121°C)
- Seal Material:..... Buna-N
- Min. I.D. of Air Supply Hose: 3/4"
- Length of Stroke:..... 6"
- Overall Height: 25"
- Weight:..... 56 Lbs.

WARNING: Do not operate with air contaminated with materials not compatible with Buna-N seals.

ATTACHING AIRMOTOR TO PUMPTUBE

- 1) Remove cover plate from side of airmotor support casting.
- 2) Tightly connect pump coupling nut to airmotor piston rod through opening in airmotor support.
- 3) Attach airmotor to the pump outlet body flange with the four bolts and nuts (hand tight) supplied with airmotor.
- 4) Slowly cycle the pump several times, using just enough air pressure to operate the pump without stalling.
- 5) Stop the pump on an "up" stroke and tighten the four bolts and nuts to securely fasten the airmotor to the pumptube.

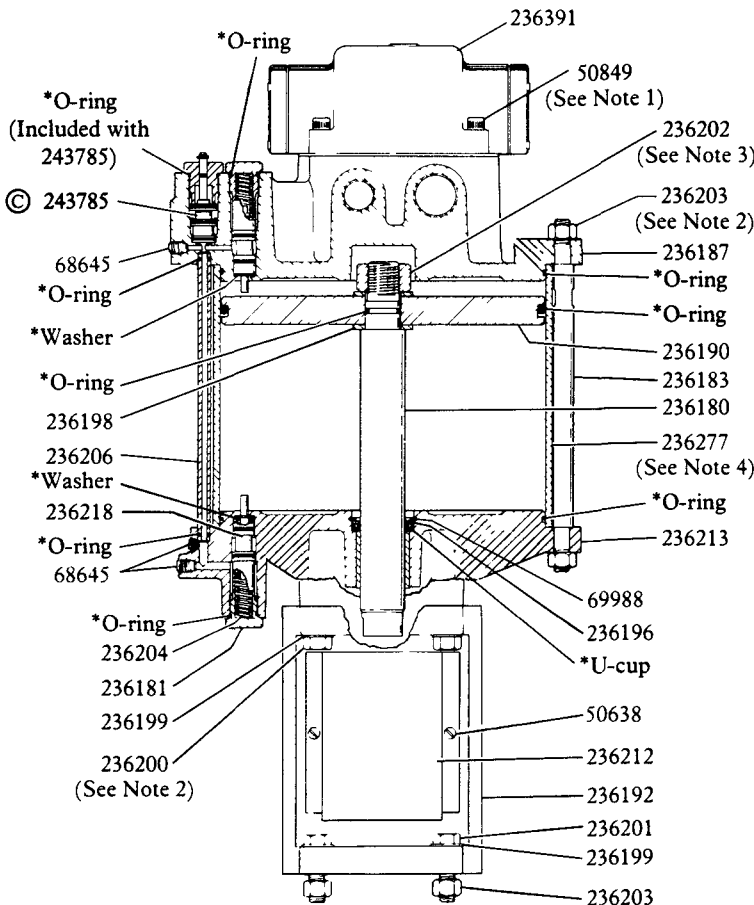

SECTION A-A

© Indicates Change

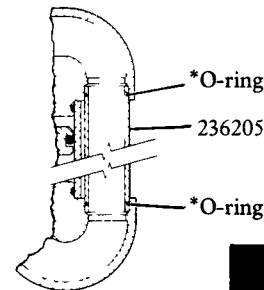

SECTION B-B

SERVICE



WARNING

Always disconnect air supply and relieve all pressure to the air motor and pump tube before servicing air motor.

NOTES:

- 1) Torque to 10 - 15 Ft. Lbs.
- 2) Torque to 30 - 35 Ft. Lbs.
- 3) Torque to 200 - 250 Ft. Lbs.
- 4) When servicing airmotor, apply #630-AAA Lubriplate to cylinder wall before reassembling.

*Only available as part of Soft Parts Kit 84818.
(All soft parts are Buna-N material.)

POWER VALVE 236391

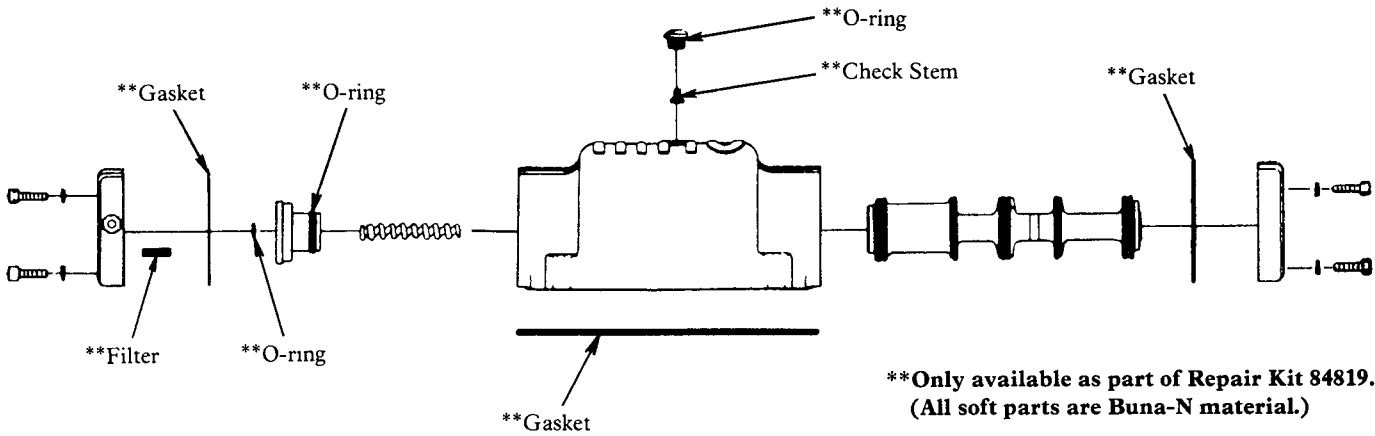

SERVICE PARTS FOR 84810 AIRMOTOR

Part	Qty.	Description	Part	Qty.	Description
50638	2	Screw	236201	4	Hex head bolt
50849	4	Screw	236202	1	Nut
68645	5	Pipe plug	236203	16	Nut
69988	1	Retaining ring	236204	2	Spring
236180	1	Piston rod	236205	1	Power tube
236181	2	Plug	236206	1	Pilot tube
236183	6	Tie rod	236209	1	Airmotor muffler
236187	1	Upper cylinder head	236212	1	Support cover plate
236190	1	Air piston	236213	1	Lower cylinder head
236192	1	Airmotor support casting	236218	2	Poppet valve
236195	2	Bracket	236277	1	Cylinder tube
236196	1	Gland packing washer	236391	1	Power valve
236197	2	Washer	243785	1	Relay valve
236198	2	Washer	660112	1	3/4" NPTF male plug
236199	8	Washer	662012	1	3/4" NPTF female socket
236200	4	Hex head bolt			

TROUBLESHOOTING

Problem	Solution
1. Air motor is not reciprocating, air blows through muffler (hissing noise).	<p>Insufficient volume of air supply:</p> <p>Check air supply line size, air filter, regulator and lubricator - 1" pipe size minimum required.</p> <p>Check air hose connecting air motor with air supply pipe - 3/4" I.D. minimum required.</p> <p>Check for other air supply restrictions.</p>
2. Air motor works erratically, short stroking.	<p>Insufficient volume of air supply (see above).</p> <p>Relay valve (243785) not holding pressure - check relay valve for broken or worn seals and replace if necessary.</p> <p>Pilot line is leaking - check lower Poppet (236218) and Pilot Tube (236206) for broken or worn seals and replace if necessary, check Spring (236204) and replace if broken.</p>

RETAIN THIS INFORMATION FOR FUTURE REFERENCE

When ordering replacement parts, list: Part Number, Description, Model Number and Series Letter.

LINCOLN provides a Distributor Network that stocks equipment and replacement parts.