

# SPRAY HEAD (AUTOMATIC)

## "DYNA SPRAY" SYSTEM



# Model 68629

## Series "C"

REFER TO INSTALLATION STANDARD  
4 28-10 SERIES FOR SPRAY TIPS.

Material Pressure: 4,000  
P.S.I.G. Maximum  
Air Pressure: 75 P.S.I.G.  
Minimum

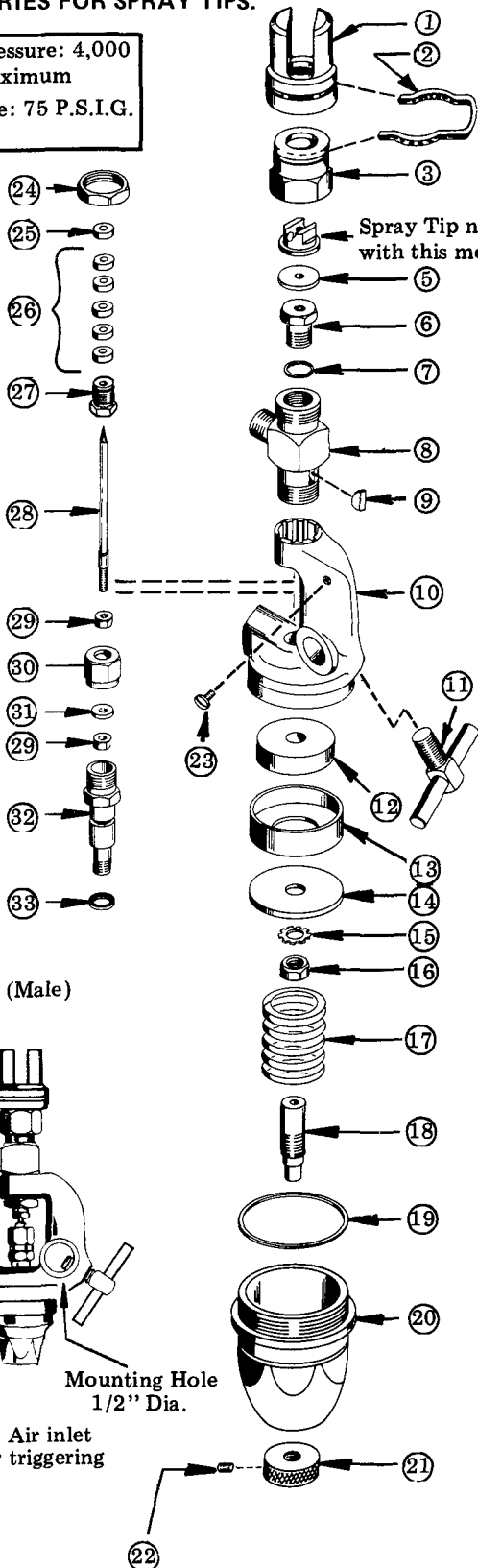

Spray Tip not included  
with this model. ④

### MAINTENANCE INSTRUCTIONS

With proper care the "Spray Head" will give long reliable service. To maintain this performance, it should be "flushed through" with solvent immediately following each spray period.

However, if it becomes necessary to disassemble this unit, the most important step is to keep the needle "lifted" off the seat throughout the entire disassembly and reassembly to avoid damage to the Needle as the Valve Seat is screwed out and back into position.

#### TO REMOVE VALVE SEAT (6)

- (A) Remove Red Cap Assembly (1, 2, 3, 4 & 5)
- (B) Feed compressed air into the air control inlet to lock Spray Head in "Open" or "Spray" position.
- (C) Unscrew Valve Seat (6)

#### TO REMOVE NEEDLE ASSEMBLY (28)

- (D) Clamp Spray Head in vise in "upside-down" position.
- (E) Unscrew Locknut (24)
- (F) Unscrew Locknut (30) — while holding Plunger (32) with other wrench
- (G) Pull out Inlet Body (8) with Needle Assembly (28) from handle. Do not lose Key (9).
- (H) Loosen Packing Screw (27)
- (J) Carefully pull out Needle Assembly (28)

#### TO REMOVE PACKINGS (26)

- (K) Unscrew Packing Screw (27)
- (L) Using small rod, push or tap out Packing Stop (25) and Packings (26)

#### TO REASSEMBLE With Compressed Air Holding Spray Head in "Open" Position.

- (M) Slide Locking Nut (30), Packing Screw (27), Packings (26) and Packing Stop (25) onto Needle (28)
- (N) Carefully insert Needle (28) into Inlet Body (8) and screw in Packing Screw (27)
- (P) Holding Locknut (24) in position behind grooved hole in Body (10), slide Body (8) (Containing needle) through grooved hole — and through Locknut (24) — with keyway alignment.
- (R) Screw Locknut (24) tight
- (S) Screw Locking Nut (30) onto Plunger (32) — while holding Plunger (32) with other wrench.
- (T) Screw Valve Seat (6) into Inlet Body (8) — with Gasket (7) in place. (Release air from air control inlet.)

#### CAUTION:

Do not force or bend Needle (28). Any adjustments to "length" of needle must be made with Body (8) and Needle Assembly (28) taken out of Spray Head

**LINCOLN ST. LOUIS**  
4010 GOODFELLOW BLVD • ST LOUIS, MO 63120 • (314) 383 5900



SECTION - **A 52**  
PAGE - **8B**

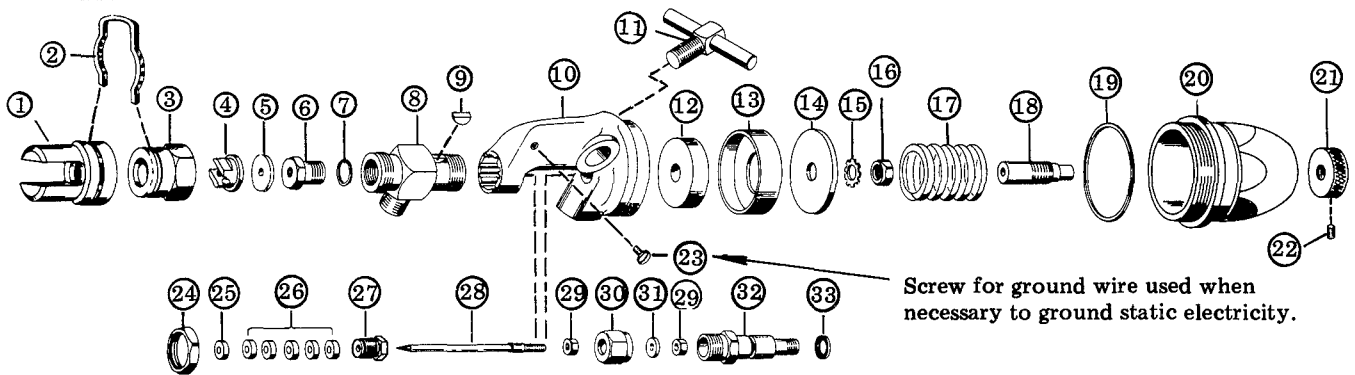

**ALTERNATE DISASSEMBLY – Without use of Compressed Air.**

- Alt. 1) Clamp spray head in vise – in “upside-down” position.
- Alt. 2) Unscrew Cap (20) – holding Plunger (32) steady with wrench. Now follow steps C, E, F, G, H, J, K and L as on other side

**ALTERNATE REASSEMBLY – With Cap (20) Removed.**

Follow steps M, N, P, R, S and T as on other side.

- Alt. 3) Replace Gasket (19) and screw Cap (20) (with Spring (17)) while holding Plunger (32) steady with other wrench.

**REPLACING TIPS**

While it varies with each job, the wear effect tends to produce narrower swaths together with “heavy centers” or “horns”. Occasionally, thinning of paint may “revive” spray pattern. Also, tips “too worn” for some jobs may be acceptable on others.

**INSTRUCTIONS FOR CLEANING ORIFICE TIPS**

Immediately after spraying, submerge spray tip in solvent until film or coating dissolves completely. Blow clean and dry with air gun. If it is necessary to dislodge clogging particles, use pointed wood or plastic probe.

(Caution: Use metal probe only with greatest care to prevent orifice damage). In all cases a magnifying glass or microscope are helpful.

**NOTE:**

Circled numbers are instruction codes. Do not include when ordering parts.

**SERVICE PARTS**

PART NO.	DESCRIPTION	CODE
68628 – 110	Locknut, Stain. Stl., Polished w/Nylok Insert	24
68628 – 115	Inlet Body, Stain. Stl., Polished, with Key	8
68628 – 116	Seat Plug Gasket, Aluminum	7
68628 – 118	Tip Gasket, Nylon	5
68628 – 126	Packing Screw, Stain. Stl.	27
68628 – 127	Teflon Packings	26
68628 – 128	Stain. Stl. Packing Stop	25
68628 – 133	Socket Head Set Screw, Steel	22
68628 – 142	Red Cap Lug, Nylon	1
68628 – 143	Snap Ring, Steel, Zinc Plated	2
68628 – 144	Cap, Steel, Nickel Plated	3
68629 – 102	Key, Steel, Cadmium Plated	9
68629 – 104	Locking Screw Sub-Assembly, Stl. Nickel Plated	11
68629 – 113	Needle Locknut, Brass, Nickel Plated	29
68629 – 114	Locking Nut, Brass, Nickel Plated	30
68629 – 115	Stem Stop Washer, Brass	31
68629 – 118	Support Body, Brass, Nickel Plated	10
68629 – 119	Cup Support, Aluminum	12
68629 – 120	Packing Cup, Teflon	13
68629 – 121	Washer, Brass	14
68629 – 122	Shakeproof Washer, Steel, Cadmium Plated	15
68629 – 123	Nut, Brass	16
68629 – 124	Helical Spring, Steel, Music Wire	17
68629 – 125	Gasket, Copper	19
68629 – 126	Shut-Off Needle, Tungsten Carbide	28
68629 – 127	Plunger, Brass, Nickel Plated	32
68629 – 128	Quad-Ring, Buna-N	33
68629 – 129	Valve Seat, Stain. Stl. w/Tungsten Carbide Insert	6
68629 – 130	Safety Lock Stud, Brass, Nickel Plated	18
68629 – 131	End Cap, Brass, Nickel Plated	20
68629 – 132	Safety Lock Knob, Brass, Nickel Plated	21
68629 – 133	Self-Tapping Screw, Stl., Nickel Plated	23