

**\*REFER TO SEPARATE INSTRUCTIONS**

815 Air Coupler — Section G9, Page 2 Series.  
 82686 Basic Pump — Section A6, Page 4 Series.  
 83447 Elevator Assembly — Section A6, Page 42 Series.

## ASSEMBLY INSTRUCTIONS

- 1) Remove air nipple and adapter (assembled) from pump.
- 2) Remove cover nut and airmotor cover from pump.
- 3) Remove the four screws holding the cover-bottom to the pump outlet body.
- 4) Hold pump outlet body securely against the inner surface of the cover-bottom and insert adapter (with outlet connection attached) through hole in cover-bottom making sure that connection is tight and that outlet connection is correctly oriented for intended application.
- 5) Insert end of pumptube through hole in drum cover.
- 6) Line up holes in drum cover, cover-bottom and pump outlet body, replace four screws and tighten securely.
- 7) Remove drum top and insert pump into lubricant drum.
- 8) Fasten drum cover to drum using three drum cover screws.
- 9) Assemble the lubricant delivery hose to the pump outlet connection. Connections must be leakproof.
- 10) Replace airmotor cover and position over cover-bottom.
- 11) Secure cover with cover nut.
- 12) Insert adapter (with air nipple attached) through hole in airmotor cover and assemble to pump. Connections must be leakproof.
- 13) Attach air coupler to air hose.
- 14) Attach air hose to air supply.
- 15) Drum pump is ready for operation as soon as air coupler is connected to air nipple.

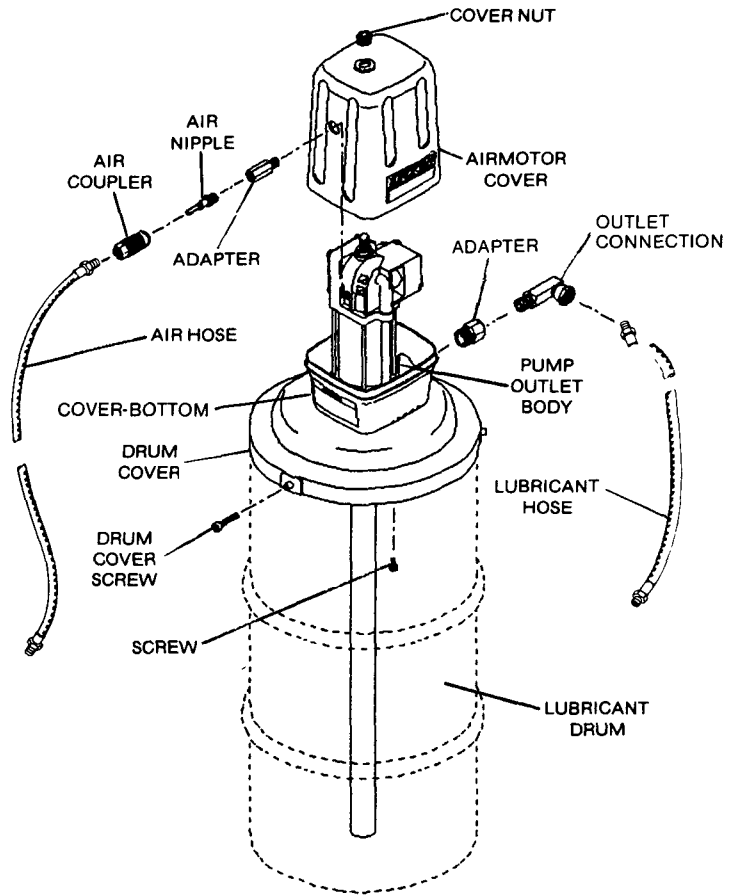

## SERVICE PARTS

Part	Qty.	Description	Part	Qty.	Description
815	1	Air coupler	50757	1	Screw
11348	1	Adapter	72036	1	Air hose
11478	1	Cover nut	73060	1	Volume hose
11659	1	Air nipple	82686	1	Basic pump
12018	1	Adapter	83447	1	Elevator assembly
46007-1	1	Drum cover	241561	1	Airmotor cover
50060	4	Screw	241567	1	Cover-bottom
50415	3	Drum cover screw	241584	1	Outlet connection
50754	1	Nut			

### RETAIN THIS INFORMATION FOR FUTURE REFERENCE

When ordering replacement parts, list: Part Number, Description, Model Number, and Series Letter.

LINCOLN provides a Distributor Network that stocks equipment and replacement parts.