

2-1/2" AIRMOTOR

Model 84179

Series "B"

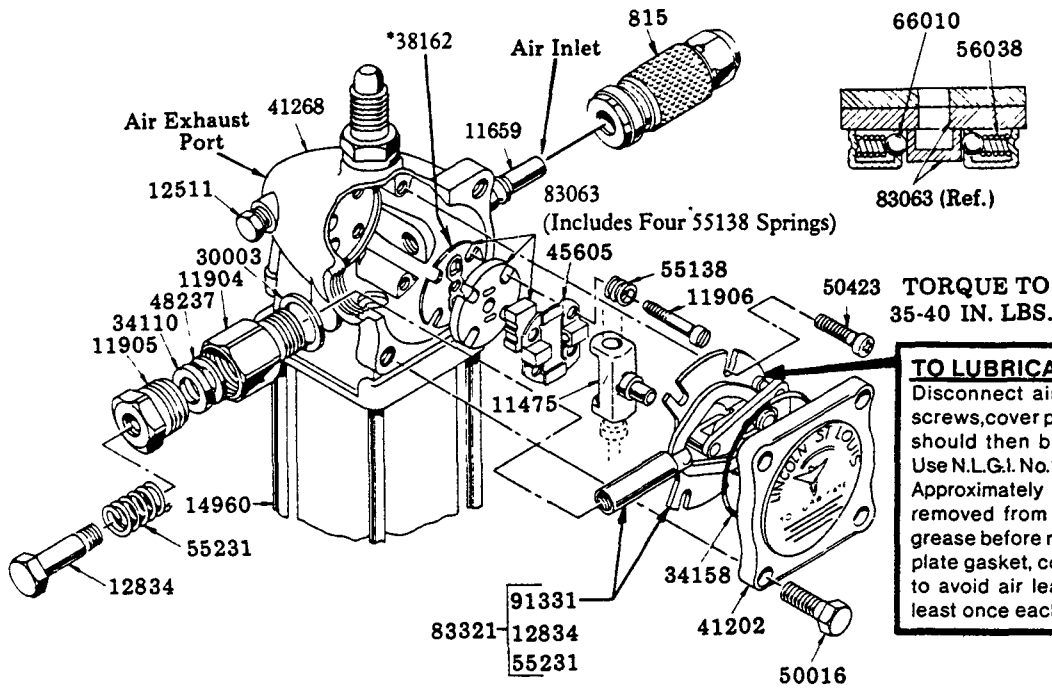

TO LUBRICATE AIR VALVE MECHANISM
 Disconnect air to pump. Remove the four cover screws, cover plate and cover plate gasket. Grease should then be packed behind the toggle plate. Use N.L.G.I. No.1 (Light Grade) water repellent grease. Approximately 1/3 ounce. If toggle plate has been removed from air valve casting, pack cavity with grease before replacing toggle plate. Replace cover plate gasket, cover plate and cover screws. Tighten to avoid air leaks. Periodic inspection of parts at least once each year is advisable.

DISASSEMBLY PROCEDURE

- 1) Unscrew the 14963 collar securing the airmotor to the pump body.
- 2) Lift the airmotor straight up to move the air piston to it's extreme "down" position.
- 3) Shift the airmotor to one side to disengage the airmotor coupling from the pump rod, and lift upward to complete separation.
- 4) Remove 11470 Valve Cap, 11472 Trip Rod Pin and 11471 Trip Rod Collar.
- 5) Unscrew four 51009 Nuts from 14960 Tie Rods and lift 41268 Air Valve Casting off of 61041 Air Cylinder slightly.
- 6) Hold 91964 Trip Rod (Do Not Damage surface of trip rod) and unscrew 11947 Trip Sleeve.
- 7) Remove air valve casting.
- 8) Remove 11904 Packing Nut and 11905 Packing Cap from air valve casting.
- 9) Remove four 50016 Screws and 41202 Cover Casting.
- 10) Remove four 50423 Screws, 91331 Toggle Plate, 11475 Trip Shoe and trip sleeve.
- 11) Remove four 11906 Screws, 55138 Springs, 45605 Valve Guide Plate, 83063 Valve Slide, Seat and Gasket.
- 12) Unscrew 11476 Trip Rod Packing Nut from air valve casting and remove all packing parts.
- 13) Unscrew 61570 Tube from 40666 Adapter Casting.
- 14) Remove 61041 Air Cylinder and 61502 Air Passage Tube from adapter casting.
- 15) Place wrenches on 13300 Piston Bolt and on wrench flats of 14961 Piston Rod and loosen.
- 16) Remove piston bolt, trip rod, 48212 Air Piston Washers, 34090 Air Piston Packing and 48511 Washer from piston rod.
- 17) Remove piston rod through bottom of adapter casting.
- 18) Unscrew 14090 Gland Packing Nut from adapter casting and remove all gland parts.
- 19) To reassemble, reverse procedure.

NOTE: If complete disassembly is required, replace all gaskets, o-rings and packings. (Order 236464 Repair Kit.)

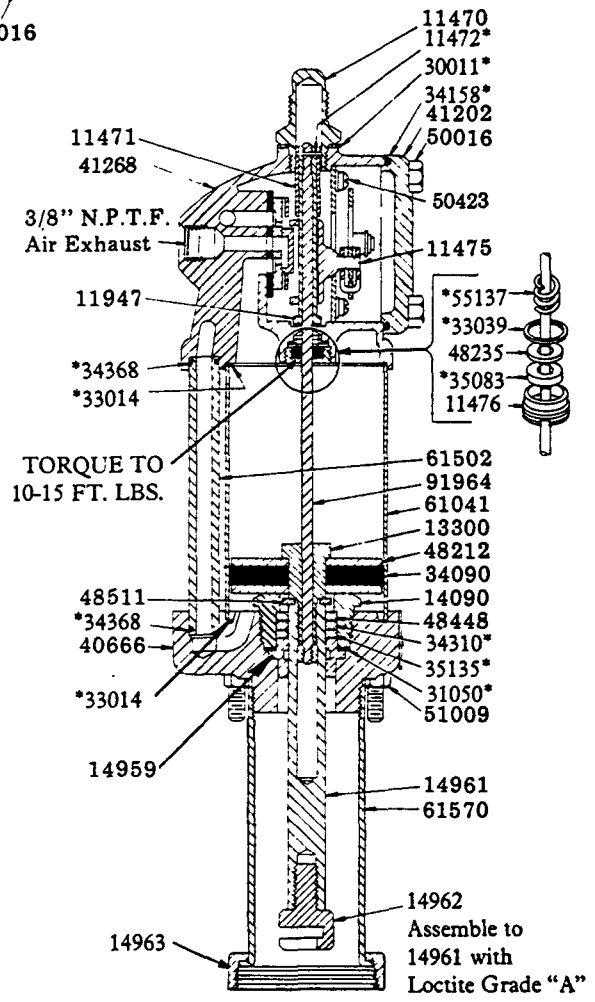

One Lincoln Way St. Louis, Missouri 63120-1578
 (314) 679-4200 Telex 44881

SECTION **A6**
 PAGE **- 50B**

SERVICE PARTS

PART	QUAN.	DESCRIPTION	PART	QUAN.	DESCRIPTION
815	1	Air coupler	*34368	2	O-ring
11470	1	Valve cap	*35083	1	Packing
11471	1	Trip rod collar	*35135	1	Gland packing
*11472	1	Trip rod pin	*38162	1	Valve seat gasket
11475	1	Trip shoe	40666	1	Adapter casting
11476	1	Trip rod packing nut	41202	1	Cover casting
11659	1	Air nipple	41268	1	Air valve casting
11904	1	Packing nut	45605	1	Valve guide plate
11905	1	Packing cap	48212	2	Air piston washer
11906	4	Valve seat bolt	48235	1	Washer
11947	1	Trip sleeve	48237	1	Washer
12511	1	Pipe plug	48448	1	Washer
12834	1	Spring retainer	48511	1	Washer
13300	1	Piston bolt	50016	4	Screw
14090	1	Gland packing nut	50423	4	Screw
14959	1	Gland packing spacer	51009	4	Nut
14960	4	Tie rod	*55137	1	Spring
14961	1	Piston rod	55138	4	Spring
14962	1	Coupling adapter	55231	1	Spring
14963	1	Body cap	*56038	2	Spring
*30003	1	Packing nut gasket	61041	1	Air cylinder
*30011	1	Valve gasket	61502	1	Air passage tube
*31050	1	Gland gasket	61570	1	Tube
*33014	2	Gasket	*66010	2	Ball
*33039	1	Gasket	83063	1	Valve slide, seat and gasket
34090	1	Air piston packing	83321	1	Low pressure kit
*34110	1	Packing	91331	1	Toggle plate
*34158	1	O-ring	91964	1	Trip rod
*34310	1	Packing			

*Included in 236464 Repair kit

RETAIN THIS INFORMATION FOR FUTURE REFERENCE

When ordering replacement parts, list: Part Number, Description, Model Number, and Series Letter.

LINCOLN provides a Distributor Network that stocks equipment and replacement parts.

A list of Authorized Service Departments will be furnished upon request.