

NOTE:

Order 82151 Repair Kit for parts that require replacement as a result of normal use.

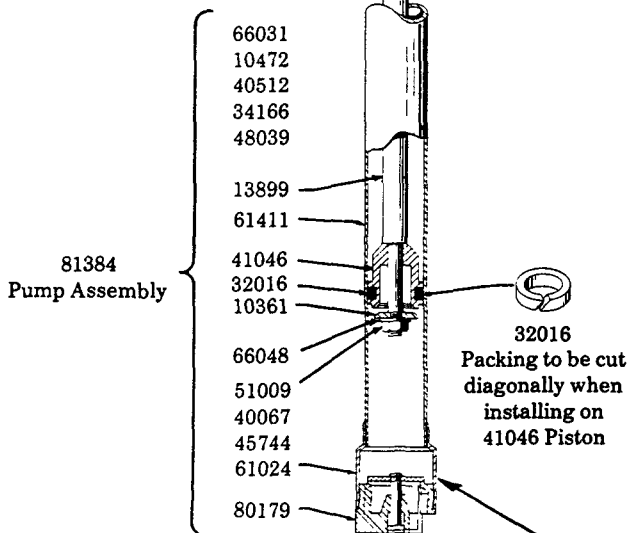

81384
Pump Assembly

32016
Packing to be cut diagonally when installing on 41046 Piston

**FOOT VALVE
MUST BE REMOVED TO
INSTALL FOLLOWER ASSEMBLY**

© Indicates change

SERVICE PARTS

Part	Qty.	Description
10361	1	Piston plate
10472	3	Toggle pin
10494	1	Filler fitting guide
13899	1	Connecting rod
32016	1	Piston packing
34166	1	O-ring
37503	1	Filler packing
40067	1	Handle
40512	1	Cylinder head
41046	1	Piston
45744	1	Toggle
46007	1	Drum cover
48039	1	Packing washer
48311	1	Washer
50060	3	Screw
50415	3	Drum cover screw
51009	1	Nut
61024	1	Adapter tube
61411	1	Pump tube
66031	3	Cotter pin
66048	1	Lockwasher
67031	1	Street elbow
67042	1	Pipe nipple
67126	1	Reducing coupler
80133	1	Filler fitting socket assembly
80179	1	Foot valve
81384	1	Complete pump assembly
82074	1	Filler fitting assembly
91014	1	Filler body assembly
91749	1	Filler cap

OPERATING INSTRUCTIONS

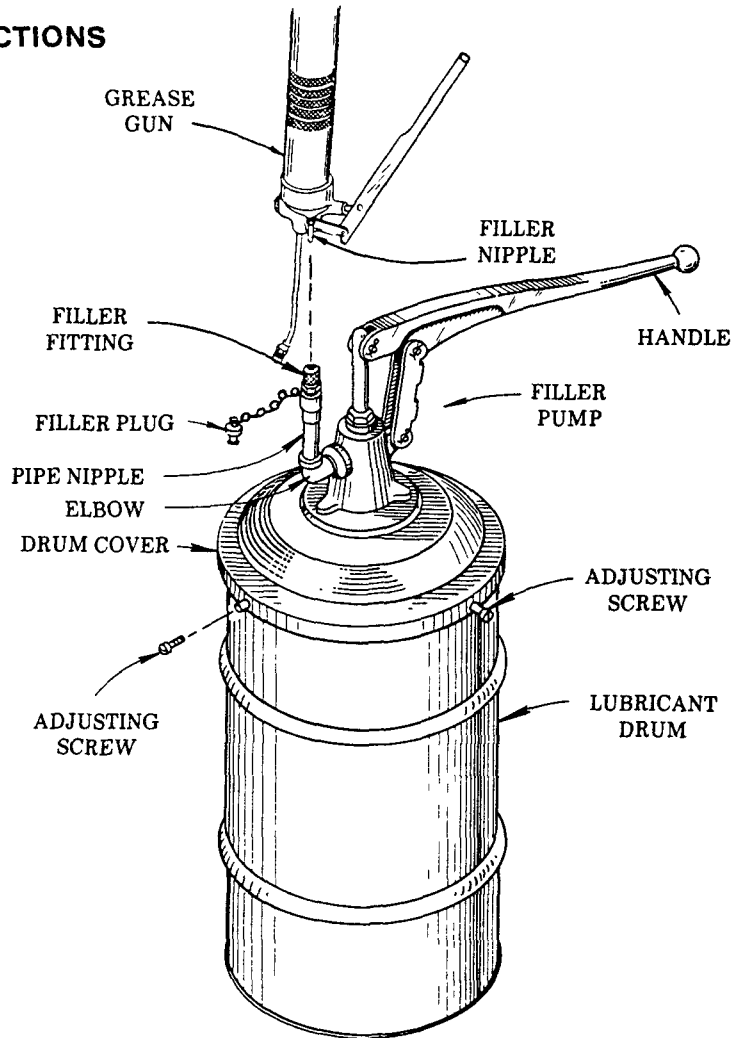

The filler pump is hand operated, designed to lift viscous and semi-solid lubricants from the original drums for loading the containers of the full range of Lincoln grease guns. These grease guns come equipped with a filler nipple for connecting to the outlet of the filler pump, which provides a quick and positive method of filling.

INITIAL PRIMING

It is necessary that the filler pump tube be filled completely with lubricant before attempting to fill a grease gun. To do this, remove the filler fitting assembly by unscrewing the pipe nipple from the elbow. Place the pump tube into a fresh drum of lubricant and operate the handle until the lubricant flows from the elbow. Replace the pipe nipple and filler fitting into the elbow.

FILLER NIPPLE

Insert filler nipple into the filler socket, permitting lubricant to enter the container of grease gun on each down stroke of the filler pump handle.

CAUTION:

- 1) If the grease gun container to be filled is of the air primed type be sure to open the vent plug in the cover cap to permit the air to escape while loading.
- 2) After the filler pump is completely primed, the handle cannot be operated unless a filler nipple is inserted in the filler nozzle. When the filler pump loses its prime, the handle can be operated, which is an indication that the drum is empty. When changing the pump to a fresh drum of lubricant it will seldom be found necessary to reprime, as the pump tube will retain a sufficient volume of lubricant to prevent loss of prime.
- 3) The foot valve at the filler pump inlet should be inspected and cleaned frequently, particularly when changing from one drum to another.

SERVICE OF LOWER PUMPTUBE

Loss of volume or pressure indicates:

- 1) Foreign matter between 41046 Piston and 10361 Piston Check or between 80179 Foot Valve. Remove and clean.
- 2) 32016 Piston Packing or 34166 O-ring worn or damaged Before replacing piston packing the inside of the tube should be inspected for rough or score marks

Piston rod surface contacting the 34166 O-ring must be smooth.

RETAIN THIS INFORMATION FOR FUTURE REFERENCE

When ordering replacement parts, list: Part Number, Description, Model Number, and Series Letter.

LINCOLN provides a Distributor Network that stocks equipment and replacement parts.