

OWNER/OPERATOR RESPONSIBILITY

It is the owner/operator responsibility to properly use and maintain this equipment. The instructions and warning contained in this manual shall be read and understood by the owner/operator prior to operating this equipment. If an owner/operator does not understand English, the contents of this manual shall be explained in the owner/operators native language to assure that the owner/operator comprehends. The owner/operator shall retain this manual for future reference to important warnings, operating and maintenance instructions.

NOTICE

This device dispenses fluid using pressurized air, and complies with the specifications of the Uniform Fire Code, Standard Fire Prevention Code and the National Fire Protection Association, (NFIPA-30). It does not comply with current provisions of BOCA section F-3203.5.3. You should consult your local fire marshall concerning code compliance of this device.

INSPECTION

Prior to operation or maintenance, a visual inspection shall be made. Check for worn parts, air leaks, damaged, loose or missing parts. Check tank operation by connecting air to air nipple and closing ball valve. Verify that there is sufficient air flow coming from nozzle/hose assembly. If the reciever is damaged, badly worn or operates abnormally, it should be removed from service. Contact a factory authorized service center for repair. An annual tank/component inspection is recommended to be performed by a factory authorized service center.

OPERATION

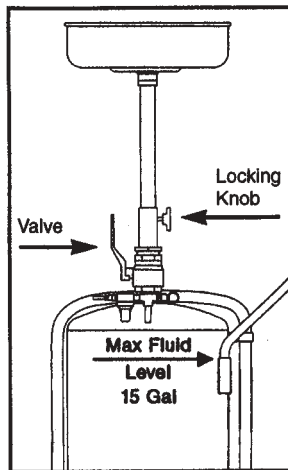

To drain oil:

With valve fully open, (Valve handle in vertical position), raise drain bowl to desired height and lock in place. Drain oil into bowl/tank assembly. Check sight gauge tube on back side of tank frequently. DO NOT fill tank above maximum oil level as shown.

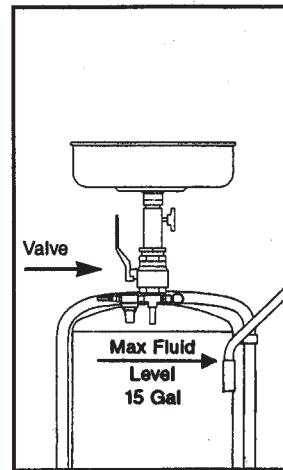

To transport tank:

With valve fully open, (Valve handle in vertical position), lower drain bowl to desired height. Always use the tank handle to transport the tank assembly.

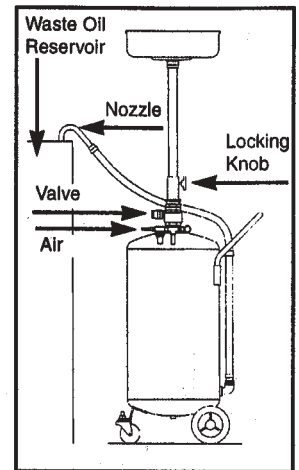

To evacuate oil:

Evacuate waste oil from tank when maximum oil level is obtained. DO NOT overfill tank above maximum oil level as shown above. Raise drain bowl and lock in place, close valve fully, (Valve handle in horizontal position), and place nozzle **SECURELY** into waste oil collection reservoir. Connect air to inlet nipple and discharge oil. Never leave unit unattended when evacuating oil. Immediately disconnect air supply when oil is no longer discharging into reservoir.

WARNING

Failure to heed the following warning may result in personal injury and/or property damage. Pop-off valve and preset, non adjustable regulator have been installed for your protection. Do not tamper with or remove.

CAUTION

- NEVER pressurize tank with ball valve open.
- If waste oil does not evacuate tank upon pressurization; check that ball valve is fully closed, (handle in horizontal position). If this does not correct the problem remove the unit from service immediately and contact an authorized service center for repair.
- If the pop-off ever relieves ANY air pressure from the tank, remove the unit from service immediately and contact an authorized service center for repair.

WARNING

Failure to heed the following may result in personal injury and/or property damage.

- NEVER leave unit unattended when operating or evacuating.
- NEVER use near open flame or heat source.
- ALWAYS raise drain bowl and close main valve before emptying.
- ALWAYS disconnect air supply after emptying.
- NEVER use unit, for handling highly volatile fuels and fluids.
- USE ONLY the nozzle assembly provided.

WASTE OIL RECIEVER MODELS 3613, 3643

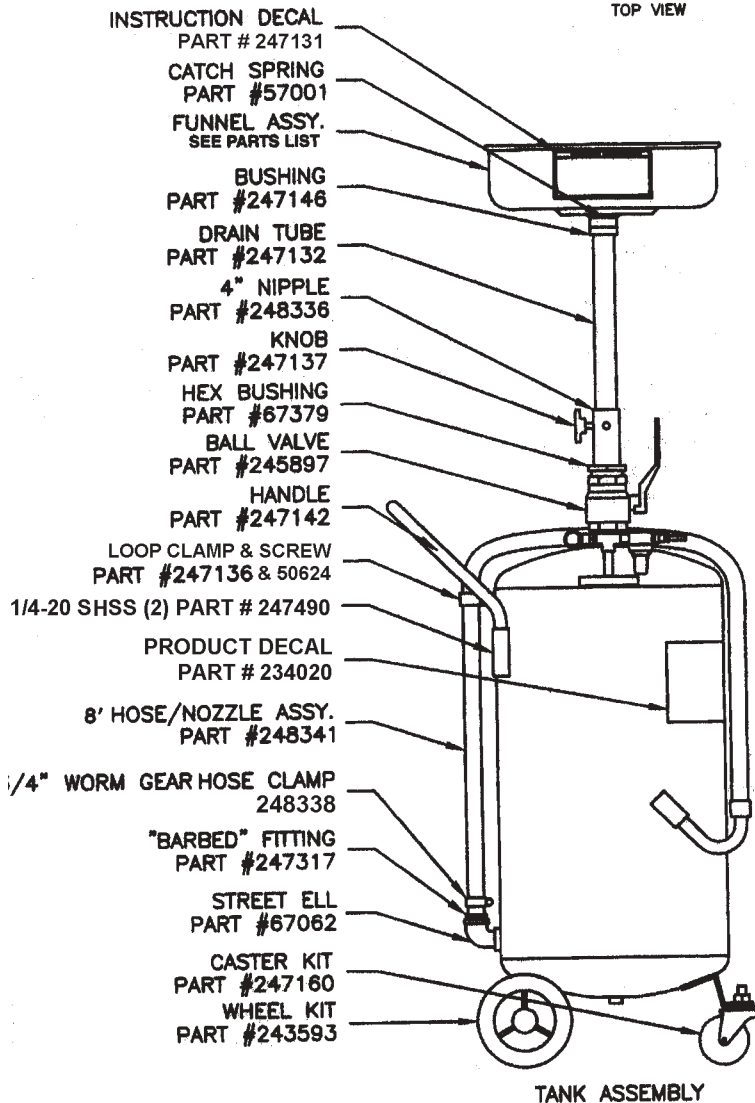
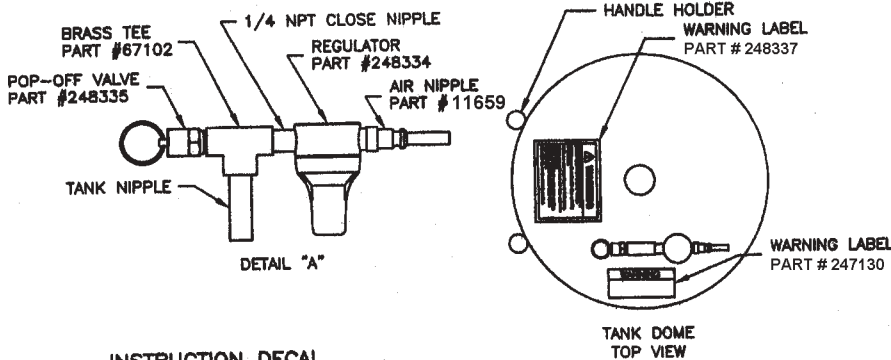

ASSEMBLY

1. Remove tank from box. Slide 1/2" diameter steel axle through axle housing on bottom of tank. Place wheel on axle, securing with palnut. Repeat for other wheel, then snap on hubcaps.

2. Remove wood spacers from caster brackets. Slide stud of caster through bracket, securing with washer, lock-washer and nut. Repeat for other caster.

3. Place TFE pipe sealant on threads of 3/4 NPT street ell and screw into lower fitting on side of tank. Place TFE pipe sealant on white nylon barbed fitting and screw into street ell. Slide a worm gear hose clamp over end of hose. Then push end of hose over barbed fitting. Slide the worm gear clamp down over hose/barbed fitting and tighten for use.

4. Place loop clamp around tubing and fasten to bracket with 1/4-20 x 1/2 cap-screw, continually keeping tension on hose to keep as straight as possible.

5. Place handle into 2 handle holders on backside of tank, securing with 1/4-20 SHSS.

6. Place TFE pipe sealant on 1 1/2 NPT nipple on top dome of tank. Screw 1 1/2 ball valve into nipple. Screw hex bushing into ball valve and 4" pipe nipple into hex bushing. Screw clamping knob into 4" pipe nipple, (Note: only one of the four holes in 4" nipple is threaded. The other 3 holes are non threaded pressure relief ports).

7. Place TFE pipe sealant on red funnel adapter bushing and screw into funnel assembly. Place TFE pipe sealant on drain tube and screw into bushing/funnel assembly. Then put drain tube/funnel assembly into tank through the 4" nipple and ball valve assembly. ALL fittings; should be tight so as to prevent any leaking.

8. Place catch spring down into the drain within the funnel assembly.



WASTE OIL RECIEVER MODELS 3613, 3643

SERVICE PARTS LIST

PART	QTY	DESCRIPTION	PART	QTY	DESCRIPTION
11659	1	Air Nipple	247137	1	Knob
50624	1	Screw	247142	1	Handle
57001	1	Catch Spring	247146	1	Bushing
67062	1	3/4 Street Elbow	247160	2	Caster Kit
67102	1	1/4 Tee	247317	1	Barbed Fitting
67379	1	Hex Bushing	247536	1	Funnel Assy (3643)
91197	1	Funnel Assy (3613)	247680	1	Product Decal (3643)
207490	2	Set Screw	248334	1	Regulator
243593	2	Wheel Kit	248335	1	Relief Valve
245897	1	Ball Valve	248336	1	4" Nipple
247129	1	Product Decal (3613)	248337	1	Warning Label
247130	1	Warning Label	248338	1	Hose Clamp
247131	1	Instruction Decal	248341	1	Hose/Nozzle Ass.
247132	1	Drain Tube	250800	1	Lincoln Label (3613 & 3643)
247136	1	Loop Clamp			

Note: Warning labels, instruction and product decals, and nameplates are available only in label kits as shown above. Retain this information for future reference. When ordering replacement parts, list: Part Number, Description, Model Number, and Series Letter. Lincoln provides a Distributor Network that stocks equipment and replacement parts.

OVERALL DIMENSIONS

HEIGHT	48"
HEIGHT WITH DRAIN BOWL FULLY EXTENDED	76"
BOWL DEPTH	
Model 3613	5"
Model 3643	4-1/2"
BOWL DIAMETER	
Model 3613	14"
Model 3643	20"
TANK CAPACITY	
Model 3613	20 GAL.
Model 3643	18 GAL.

WASTE OIL RECIEVER MODELS 3613, 3643



LIMITED WARRANTY

LINCOLN warrants the equipment it supplies to be free from defects in material and workmanship for one (1) year following the date of purchase. If equipment proves to be defective during this warranty period it will be repaired or replaced, at Lincoln's discretion, without charge provided that factory authorized examination indicates the equipment to be defective. To obtain repair or replacement, you must ship the equipment, transportation charges prepaid, with proof of date of purchase to a Lincoln authorized warranty and service center, within one (1) year following the date of purchase.

This warranty is extended to the original retail purchaser only. It does not apply to equipment damaged from accident, overload, abuse, misuse, negligence, faulty installation or abrasive or corrosive material, or to equipment repaired or altered by anyone not authorized by Lincoln to repair or alter the equipment. This warranty applies only to equipment installed and operated according to the recommendations of Lincoln or its authorized field personnel. No other express warranty applies.

Any implied warranties applicable to equipment supplied by Lincoln, including the warranties of merchantability and fitness for a particular purpose, will last for only one (1) year from the date of purchase. Some jurisdictions do not allow limitations on how long an implied warranty lasts, so the above limitation may not apply to you.

In not event shall Lincoln be eligible for incidental or consequential damages. Lincoln's ability on any claim for loss or damages arising out of the sale, resale or use of equipment it supplies shall in no event exceed the purchase price. Some jurisdictions do not allow the exclusion or limitation of incidental or consequential damages, so the above limitation or exclusion may not apply to you.

This warranty gives you specific legal rights. You may also have other rights that vary by jurisdiction.



One Lincoln Way
St. Louis, MO 63120-1578
Phone +1.314.679.4200
Fax +1.800.424.5359

© Copyright 2003
Printed in USA

Web site:
www.lincolnindustrial.com