

SPECIFICATIONS

SINGLE STROKE, AIR RETURN

RATIO	LUBRICANT OUTPUT IN ³ (CM ³)	RESERVOIR CAPACITY	AIR INLET	LUBRICANT OUTLET	LUBRICANT OPERATING PRESSURE (P.S.I.)			
					TYPE OF SYSTEM	MINIMUM	MAXIMUM	RECOMMENDED
20:1	2.4* (39)	4 -1/2 pints 123 in ³ (2016 cm ³)	1/4 BSPP Female	1/4 BSPP Female	SL-42 SL-43	750 (52 bar) with 40 PSI (3 bar) Air	1,000 (69 bar) with 50 PSI (3 bar) Air	850 (59 bar) with 45 PSI (3 bar) Air
					SL-32 SL-33	1,200 (83 bar) with 60 PSI (4 bar) Air	3,500 (241 bar) with 175 PSI (12 bar) Air	1,500 (103 bar) with 75 PSI (5 bar) Air
					SL-1	1,850 (128 bar) with 95 PSI (7 bar) Air	3,500 (241 bar) with 175 PSI (12 bar) Air	2,500 (172 bar) with 125 PSI (9 bar) Air

* Based on lubricants that are free of entrapped air. Lubricants that are aerated will reduce output of pump.

The 85392 Pump is used as the pumping unit for a centralized lubrication system having a single line circuit of SL-1, SL-32, SL-33, SL-42 and/or SL-43 Injectors dispensing oil.

It is an air operated, single stroke pump requiring air for both forward and return stroke that discharges *2.4 in.³ (39 cc) of lubricant into the circuit for each pump stroke (Lubrication Cycle).

The total quantity of lubricant needed for the lubrication cycle of the system must not exceed the amount of lubricant discharged per pump stroke.

TO FILL RESERVOIR

The reservoir can be filled through the filler cap at the top of the reservoir.

A strainer is located at the filler cap to prevent induction of foreign material into the lubricant reservoir. Inspect strainer before filling reservoir. When necessary, lift strainer out and clean thoroughly.

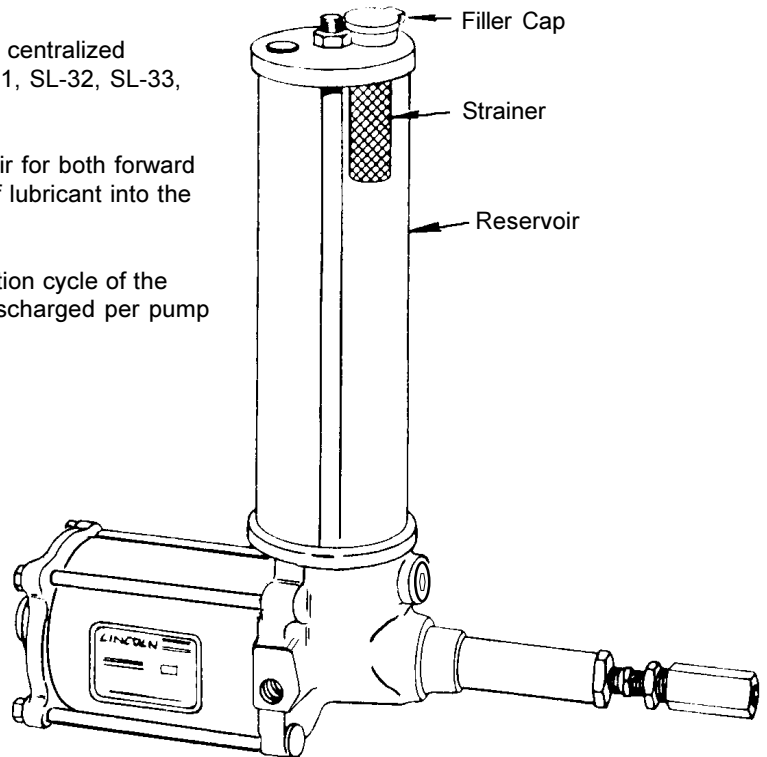

TO PRIME SYSTEM

SUPPLY LINES: After pump reservoir has been filled with recommended lubricant, loosen (do not remove) all plugs in dead ends of the injector manifolds and supply lines. Operate pump until lubricant flows from around threads of any loosened plug. Tighten this plug and continue to operate pump until lubricant flows from around threads of another loosened plug. Repeat this procedure until all supply lines are primed.

FEEDER LINES: Fill each feed line with lubricant before connecting lines to outlet of injectors and bearings. This will prevent having to cycle each injector to fill line between injector and bearing.

INJECTORS: Check each injector for proper operation. Injector stem moves when injector discharges lubricant to bearing. This may require cycling system several times. After checking injectors for operation, adjust injector for the volume required for each bearing.

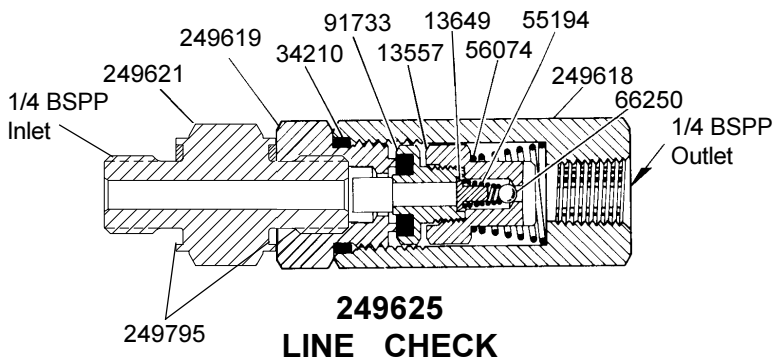
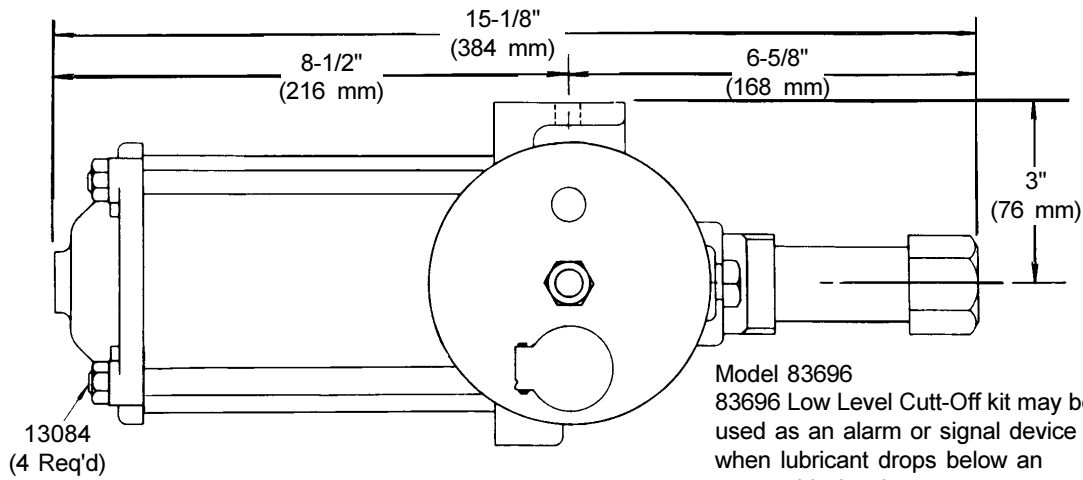

**TO CLEAN LINE CHECK
249625**

Remove 91733 Check and examine packing for presence of foreign particles. If packing is damaged, replace 91733 Check.

Remove 66250 Ball Check, 55194 Spring and 13649 Ball Stop from 13557 Check Retainer. Examine for presence of foreign particles. Clean thoroughly.

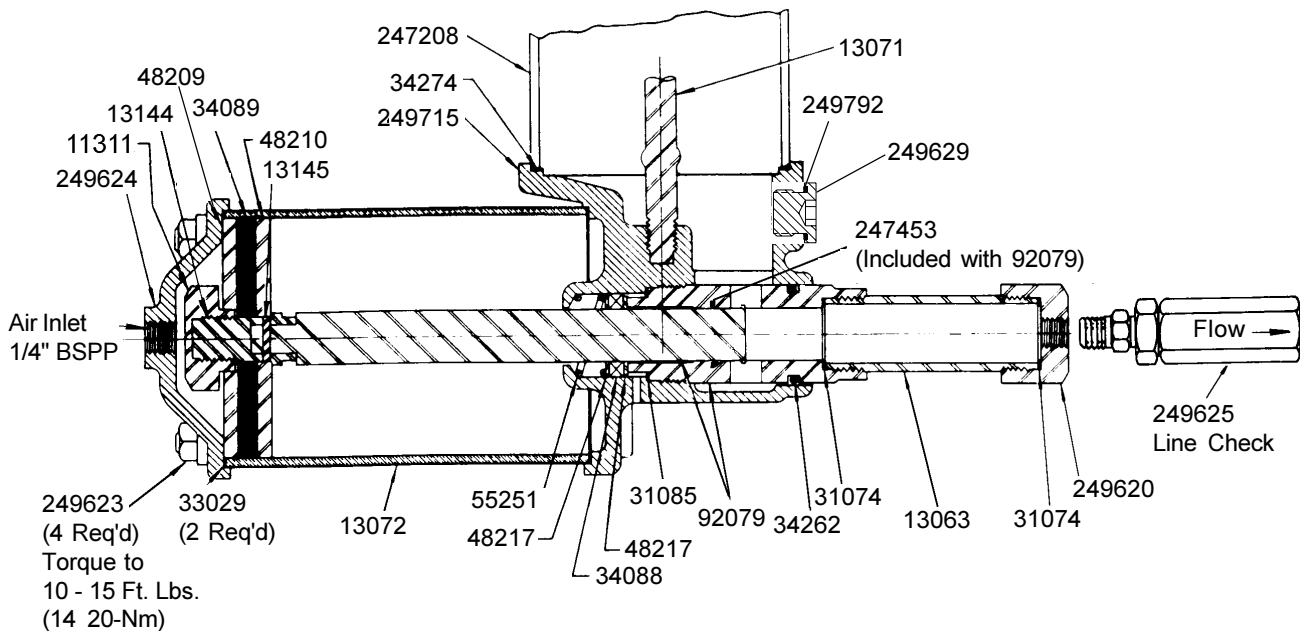

MODEL 85392 SINGLE STROKE PUMP

NOTE: Torque To
10 Ft. Lbs. (14 Nm)

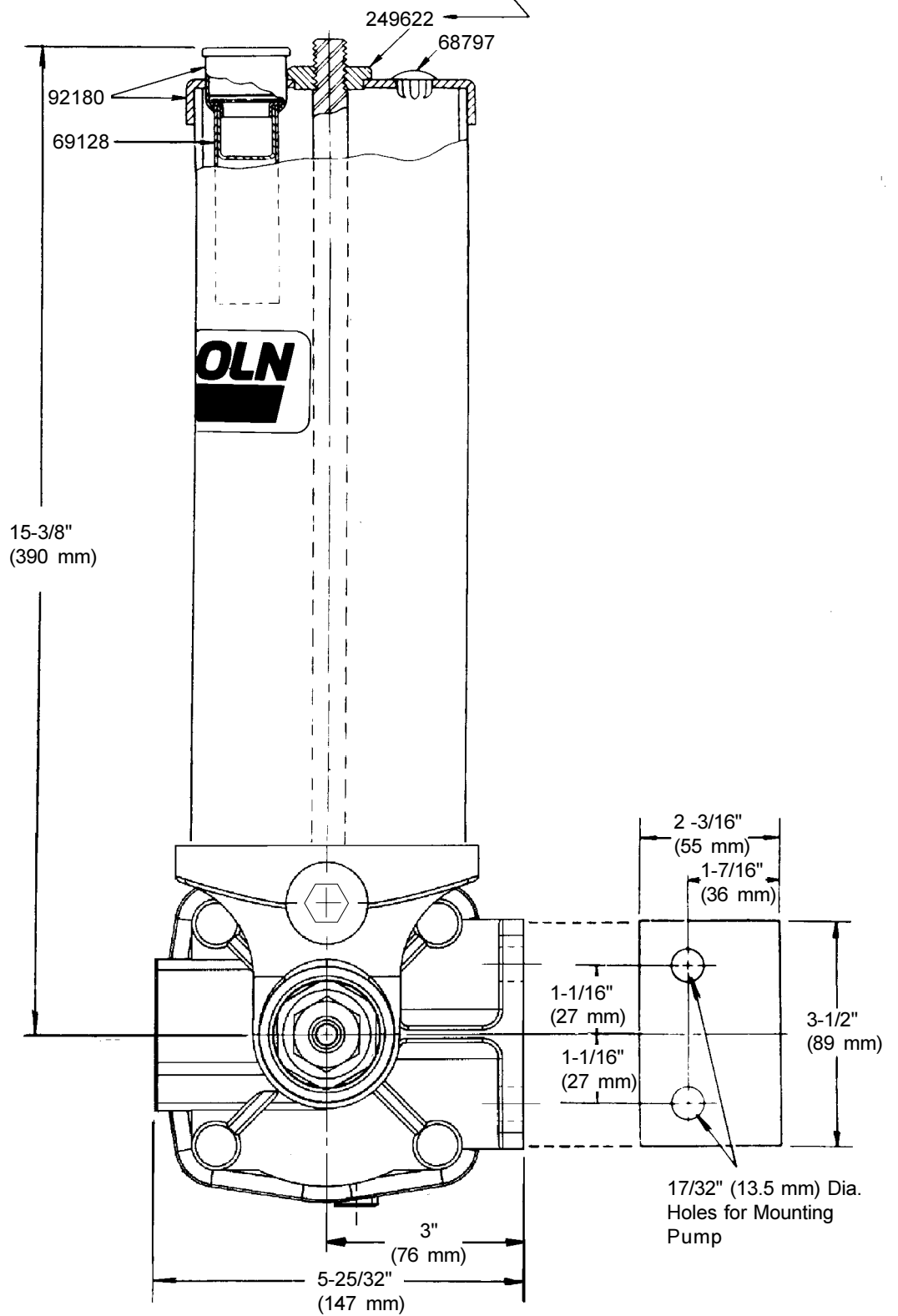

WHAT TO DO IF: PUMP LOSES PRIME - Check lubricant supply.

SYSTEM FAILS TO CYCLE - and calculated system planning has been followed
- Lubricant is leaking by packing of 91733 Check or the 66250 Ball Check. Failure of injectors to cycle can also be caused by a leak in supply lines. Examine supply lines and connections.

PUMP FAILS TO OPERATE - Check air supply.

SERVICE PARTS

Part	Qty.	Description	Part	Qty.	Description
11311	1	Piston nut	56074	1	Spring
13063	1	Pump tube	*66250	1	Steel ball
13071	1	Tie rod	68797	1	Plug button
13072	1	Air cylinder	69128	1	Strainer
13084	4	Tie rod	*91733	1	Check
13144	1	Packing stud	92079	1	Bushing & plunger
13145	1	Pin	92180	1	Cover cap
13557	1	Check retainer	247208	1	Reservoir (Acrylic)
*13649	1	Ball stop	*247453	1	O-ring (Nitrile)
*31074	2	Gasket	249795	2	Seal
*31085	1	Gasket	249792	1	Seal
*33029	2	Gasket	249618	1	Check body
*34088	1	Packing (Nitrile)	249619	1	Check seat
*34089	1	Packing (Nitrile)	249620	1	Outlet
*34210	1	O-ring (Nitrile)	249621	1	Nipple
*34262	1	O-ring (Nitrile)	249622	1	Nut
*34274	1	Gasket (Neoprene)	249623	4	Nut
48209	1	Washer	249624	1	Cylinder cap
48210	1	Washer	249625	1	Line check assembly
48217	2	Washer	249629	1	Plug
*55194	1	Spring	249715	1	Body casting
55251	1	Spring			

* Included in 252716 Soft Parts Kit

RETAIN THIS INFORMATION FOR FUTURE REFERENCE

When ordering replacement parts, list: Part Number, Description, Model Number and Series Letter.
LINCOLN provides a Distributor Network that stocks equipment and replacement parts.