

PISTOL GRIP GREASE GUN

16 OZ. CAPACITY
14-1/2 OZ. CARTRIDGE

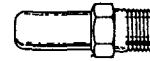

Models 1130
1132, 1133
Series "D"

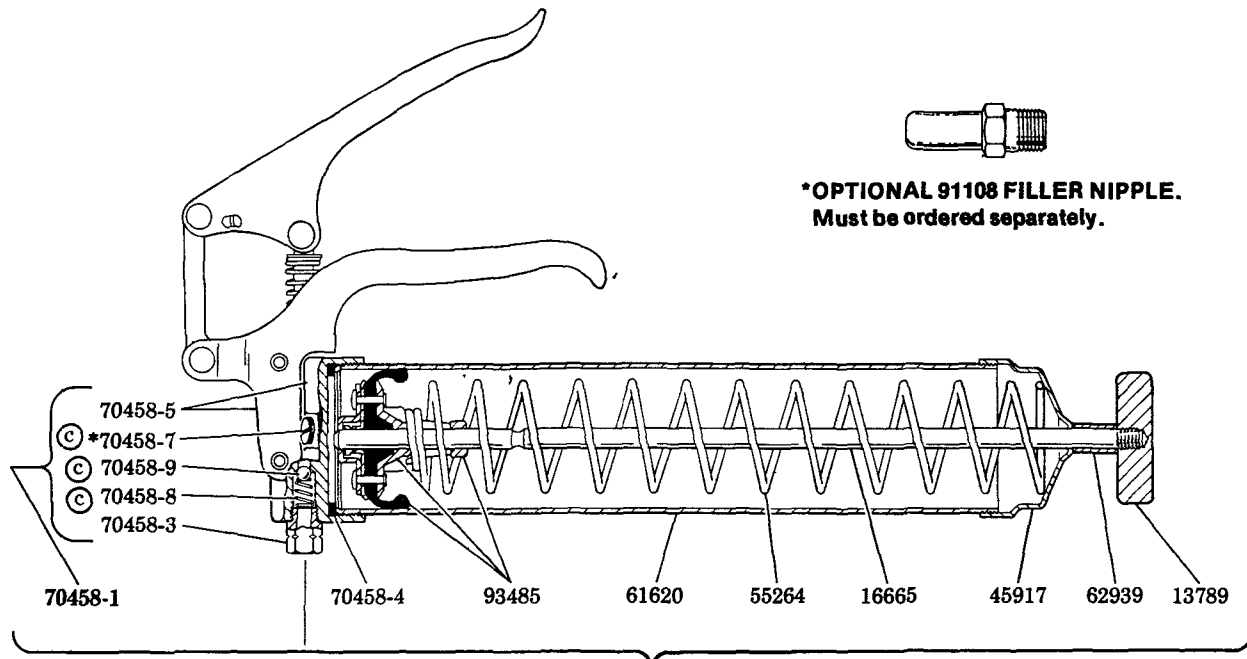

*OPTIONAL 91108 FILLER NIPPLE.
Must be ordered separately.

Model 1130

© Indicates change

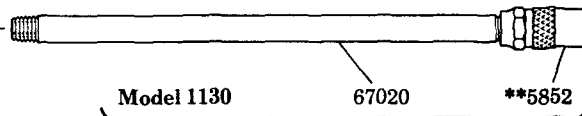

Model 1132

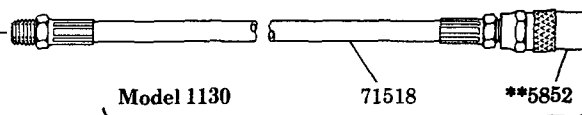

Model 1133

**Refer to Service Manual
Section F4, Page 2 Series.

OPERATING INSTRUCTIONS

Fill the lubricant container. Refer to reverse page for instructions.

Wipe fittings clean before lubricating. Push coupler onto fitting at a slight angle and then center coupler on the fitting. Squeeze pistol grip to lubricate, taking care not to damage seals by excessive pressure or lubricant volume. After lubricating, turn coupler at a slight angle to release grip of the coupler jaws.

SERVICE PARTS

PART	DESCRIPTION	PART	DESCRIPTION
5852	Hydraulic coupler	70458-3	Adapter
13789	Follower handle	70458-4	Gasket
16665	Follower rod	70458-5	Head & handle
45917	Tube cap	70458-7	Plug
55264	Follower spring	70458-8	Spring
61620	Container tube	70458-9	Ball
62939	Spacer	71518	Hose
67020	Pipe nipple	93485	Follower assembly
70458-1	Head assembly		

LINCOLN ST. LOUIS
4010 GOODFELLOW BLVD • ST. LOUIS, MO 63120 • (314) 679-4200



A DIVISION OF
McNEIL
CORPORATION

SECTION - D7
PAGE - 46C

TO INSTALL A LUBRICANT CARTRIDGE

- 1) Remove head and plunger assembly from container tube.
- 2) To remove an empty cartridge, pull back on the follower handle until the follower rod is fully extended. Then, carefully release the follower handle to eject the empty cartridge from the container tube. Pull back on the follower handle. When the follower rod is fully extended, pull it sideways to latch the rod groove into the keyhole slot in the container cap.

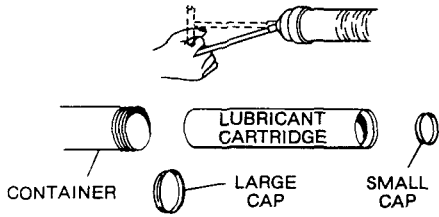

- 3) Remove the caps from both ends of the cartridge and insert the large open end of the cartridge into the container tube.
- 4) Loosely assemble the head and plunger assembly to the container tube. Disengage the follower rod from the container cap. Engage the follower rod with the follower by rotating the follow-

er handle. Exert force on the follower handle until lubricant oozes from the tube and head interface. Tighten container tube into the head and plunger assembly.

- 5) Disengage the follower rod from the follower by rotating the follower handle. Push the follower rod into the container.

TO EXPEL AIR POCKETS

- 1) Unscrew the container tube 1-1/2 turns from the head and plunger assembly.
- 2) Withdraw the follower rod from the container cap and engage it with the follower by rotating the follower handle. Exert force on the follower handle until lubricant oozes from the tube and head interface.
- 3) Tighten container tube into the head and plunger assembly. Disengage the follower rod from the follower by rotating the follower handle. Push the follower rod into the container.

IMPORTANT

Air pockets in the cartridge lubricant will cause the grease gun to lose its prime.

TO CONVERT GREASE GUN TO ALLOW FILLING FROM BULK CONTAINER OR FILLER PUMP

- 1) Unscrew the container cap from the container tube. Pull on the follower handle to extract the follower and spring from the container tube.
- 2) Grasp follower between thumb and forefinger and flip the follower lip from the rear to the front side.

NOTE: The follower resembles a cup. When the grease gun is assembled for use with bulk lubricant, the cup opens toward the head assembly.

- 3) Reassemble follower into container tube and position with the follower handle so that the container cap can be tightened onto the container tube.

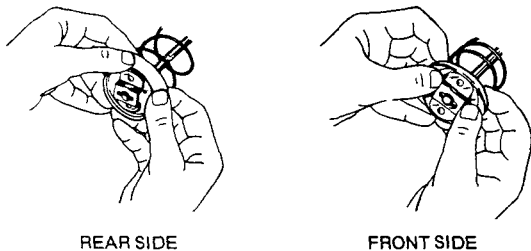

- 5) Loosely assemble the head and plunger assembly to the filled container tube. Release the follower rod from the container cap and disengage the follower rod from the follower by rotating the follower handle. Push the follower rod into the container. Slowly unscrew the container tube from the head and plunger assembly until lubricant oozes from the interface. Tighten container tube into the head and plunger assembly.

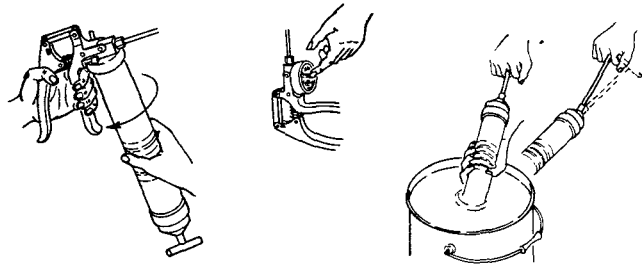

TO FILL GREASE GUN WITH A FILLER PUMP

Engage the follower rod with the follower by rotating the follower handle. Insert the grease gun filler nipple into the filler pump socket. Operate the filler pump to fill the grease gun container. When the follower rod groove is exposed, the container is filled (follower rod will be extended approximately 8 inches). Disengage the follower rod from the follower by rotating the follower handle. Push the follower rod into the container.

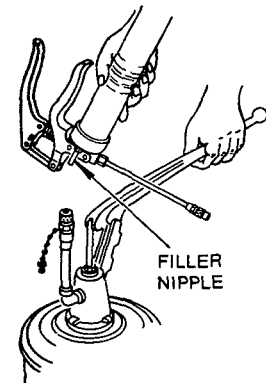

TO FILL GREASE GUN FROM BULK LUBRICANT CONTAINER

- 1) Remove head and plunger assembly from container tube.
- 2) Pack lubricant into cavity of the head and plunger assembly.
- 3) Insert the open end of the container tube into lubricant. Slowly pull the follower handle back while pushing the container tube deeper into the lubricant to prevent air pockets from being pulled into the container tube.
- 4) When the follower rod is fully extended, pull it sideways to latch the rod groove into the keyhole slot in the container cap.

RETAIN THIS INFORMATION FOR FUTURE REFERENCE

When ordering replacement parts, list: Part Number, Description, Model Number, and Series Letter.

LINCOLN ST. LOUIS provides a Distributor Network that stocks equipment and replacement parts.

A list of Authorized Service Departments will be furnished upon request.