

Bulk Capacity - 16 oz. (473 cubic cm)  
 Cartridge Capacity 14 1/2 oz. (429 cubic cm.)

Hydraulic Coupler { 62028  
 with extension 5852

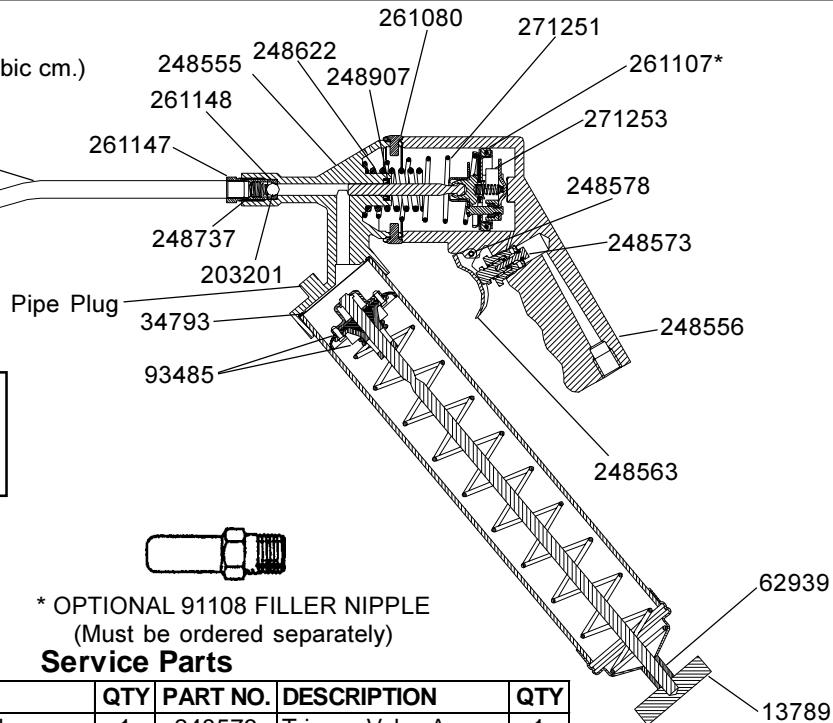

**NOTE**  
 Illustration shows follower seal lip positioned for cartridge use.

\* OPTIONAL 91108 FILLER NIPPLE  
 (Must be ordered separately)

### Service Parts

PART NO.	DESCRIPTION	QTY	PART NO.	DESCRIPTION	QTY
5852	Hydraulic Coupler	1	248573	Trigger Valve Assem	1
13789	Handle	1	248578	Roll Pin	1
34793	Packing	1	248622	Actuation Spring	1
62028	Nozzle Extension	1	248737	Ball Check Spring	1
62939	Spacer	1	248907	Rod Wiper	1
93485	Follower Assembly	1	261080	Screw, 10-32 x 1/4	4
203201	Ball	1	261107*	U-Cup Packing	1
248555	Head Casting	1	261147	Check Valve Body	1
248556	Handle Casting	1	261148	Ball Seat	1
248563	Trigger	1	271251©	Return Spring	1
			271253©	Air Piston Assembly	1

\* Included with Air Piston Assembly

**! WARNING**

Extreme pressure may cause nozzle extension or whip hose to burst. Use only APPROVED hoses and follow whip hose instructions and warnings.

**! WARNING**

Grease gun can develop high pressure up to 6000 P.S.I. (413 Bar). Use safety glasses and gloves for protection during operation. Keep hands clear of the extension during operation of the grease gun.

### ASSEMBLY AND OPERATION

1. Inspect pump head for assembly of ball check spring seated in 1/8 NPSF thread in the end of the pump head nozzle.
2. Thread extension tube or hose to pump head nozzle.
3. Securely attach air supply line to an air fitting **NOT FURNISHED** on bottom of gun handle operate gun with between 60 and 150 PSI. (4.1 and 10.3 BAR).
4. Refer to loading instructions for proper grease loading.
5. Before attaching coupler to grease fitting, depress trigger to cycle gun and verify gun is primed with grease. If gun fails to prime, refer to air purging instructions.

### MAINTENANCE

NOTE: For optimum performance and product life, purchase Model 600203 Miniature Lubricator. Otherwise, add a few drops of lubricating oil (SAE 30 or greater) through the air fitting at the bottom of the handle if gun begins to cycle slowly or erratically.

### TROUBLESHOOTING

The gun does not pump automatically when the trigger is depressed-  
 Put a few drops of lubricating oil (SAE 30 or greater) through the air fitting and cycle the gun.

© indicates change

The gun cycles but will not prime or pump grease—

Refer to the air purging instructions.

The gun cycles very slowly—

Put a few drops of lubricating oil (SAE 30 or greater) through the air fitting.

If the gun still doesn't operate—

Contact an authorized service center.

## SERVICE

If gun fails to prime or fails to cycle continuously, contact your nearest factory authorized service center for repairs and/or replacement parts.

## TO CONVERT GREASE GUN TO ALLOW FILLING FROM BULK CONTAINER OR FILLER PUMP

- 1) Unscrew the container cap from the container tube. Pull on the follower handle to extract the follower and spring from the container tube.
- 2) Grasp follower between thumb and forefinger and flip the follower lip from the rear to the front side.

NOTE: The follower resembles a cup. When the lever gun is assembled for use with bulk lubricant the cup opens toward the head assembly.

- 3) Reassemble follower into container tube and position with the follower handle so that the container cap can be tightened onto the container tube.

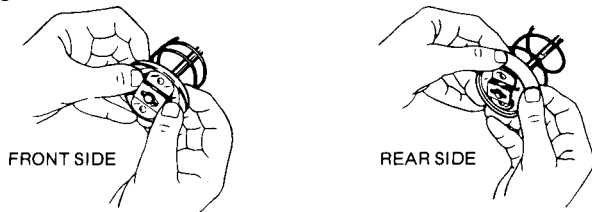

## TO FILL GREASE GUN FROM BULK LUBRICANT CONTAINER

- 1) Remove head and plunger assembly from container tube.
- 2) Pack lubricant into cavity of the head and plunger assembly.
- 3) Insert the open end of the container tube into lubricant. Slowly pull the follower handle back while pushing the container tube deeper into the lubricant to prevent air pockets from being pulled into the container tube.
- 4) When the follower rod is fully extended pull it sideways to latch the rod groove into the keyhole slot in the container cap.
- 5) Loosely assemble the head and plunger assembly to the filled container tube. Release the follower rod from the container cap and disengage the follower rod from the follower by rotating the follower handle. Push the follower rod into the container. Slowly unscrew the container tube from the head and plunger assembly until lubricant oozes from the interface. Tighten container tube into the head and plunger assembly.

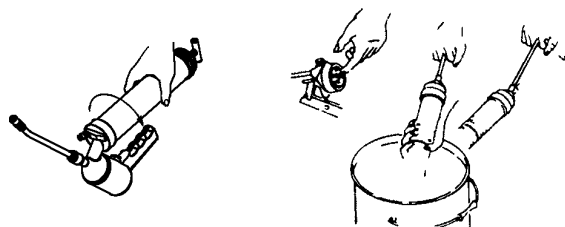

## TO FILL GREASE GUN WITH A FILLER PUMP

Engage the follower rod with the follower by rotating the follower handle. Insert the lever gun filler nipple into the filler pump socket and extend the lever gun handle away from the container tube. Operate the filler pump to fill the lever gun container. When the follower rod groove is exposed the container is filled (follower rod will be extended approximately 8 inches). Disengage the follower rod from the follower by rotating the follower handle. Push the follower rod into the container.

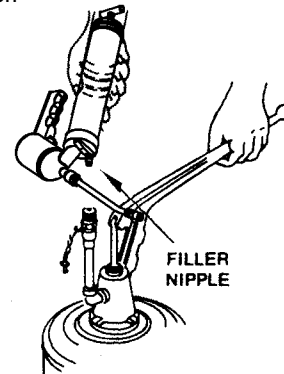

## AIR PURGING

- 1) Unscrew the container tube 1 1/2 turns from the head and plunger assembly.
- 2) Withdraw the follower rod from the container cap and engage it with the follower by rotating the follower handle. Exert force on the follower handle until lubricant oozes from the tube and head interface.
- 3) Tighten container tube into the head and plunger assembly. Disengage the follower rod from the follower by rotating the follower handle. Push the follower rod into the container.

## ! WARNING

Air pockets in the cartridge lubricant will cause the lever gun to lose its prime.

NOTE: If desired bleeder valve (243307), may be purchased and installed in place of pipe plug.

Americas:  
One Lincoln Way  
St. Louis, MO 63120-1578  
USA  
Phone +1.314.679.4200  
Fax +1.800.424.5359

© Copyright 2002  
Printed in USA

Web site:  
[www.lincolnindustrial.com](http://www.lincolnindustrial.com)