

RIGID EXTENSION INSTALLATION INSTRUCTION.

1. Remove the whip hose from the Power Luber
2. Install the plug p/n 272395 with copper gasket p/n. 260322 from the kit in place of removed hose. Do not re-use the gasket from removed hose.
3. Remove the plug (1) from adapter (2) preventing latter from loosening.
4. Install the rigid extension p.n. 245981 in place of removed plug. Use a sealing compound or teflon tape to seal the thread.
5. Remove the hydraulic coupler from the whip hose and attach in to the rigid extension.
6. Check for leaks.

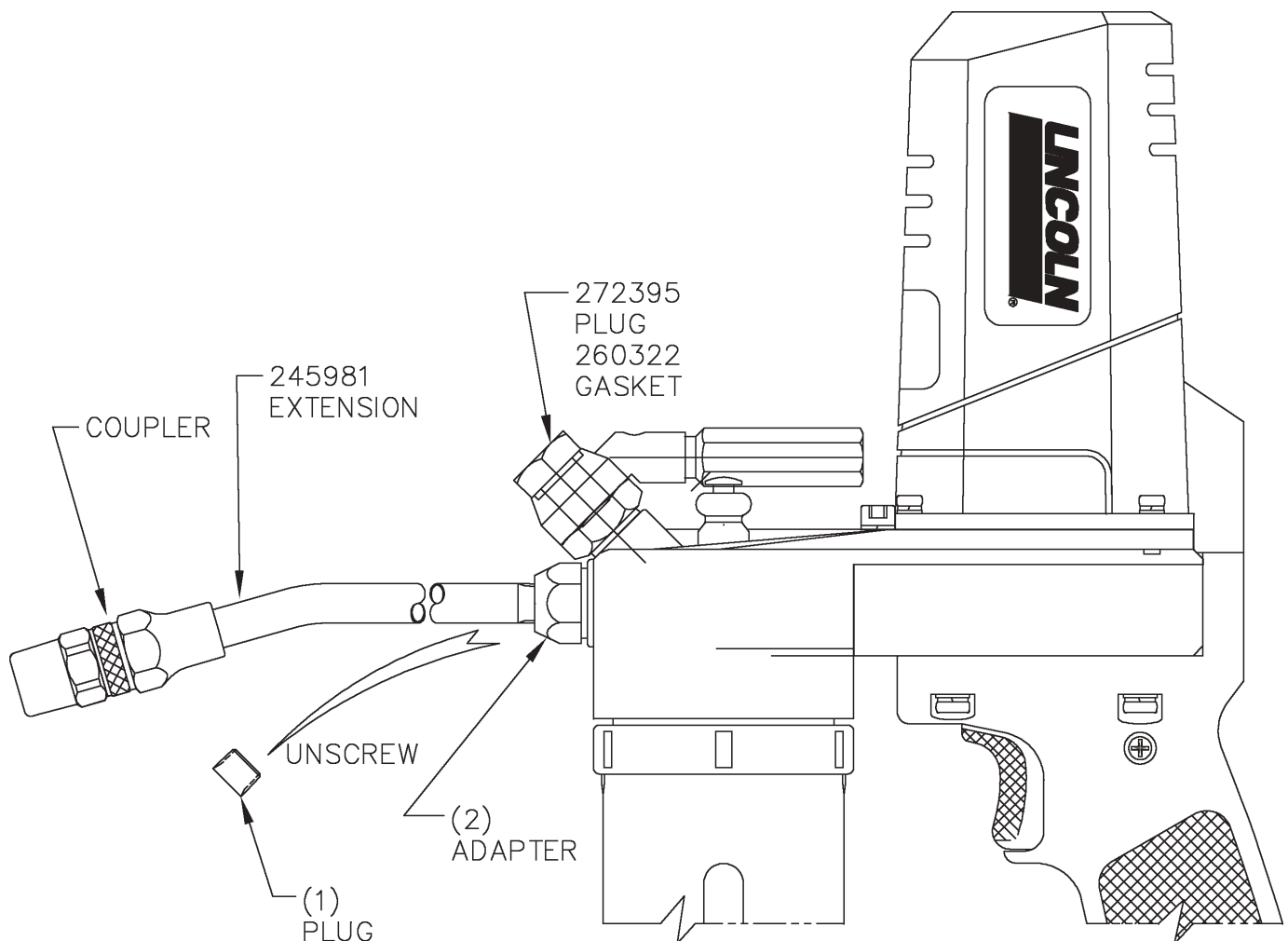

Americas:
One Lincoln Way
St. Louis, MO 63120-1578
USA
Phone +1.314.679.4200
Fax +1.800.424.5359

Europe/Africa:
Heinrich-Hertz-Str 2-8
D-69183 Walldorf
Germany
Phone +49.6227.33.0
Fax +49.6227.33.259

Asia/Pacific:
25 Int'l Business Park
#01-65 German Centre
Singapore 609916
Phone +65.562.7960
Fax +65.562.9967

© Copyright 2003
Printed in USA

Web site:
www.lincolnindustrial.com