

WITH INNER CIRCLE POINTER NON-TOTALIZING (U.S. QUARTS) 4 G.P.M. MAX., 2.5 G.P.M. RECMD.

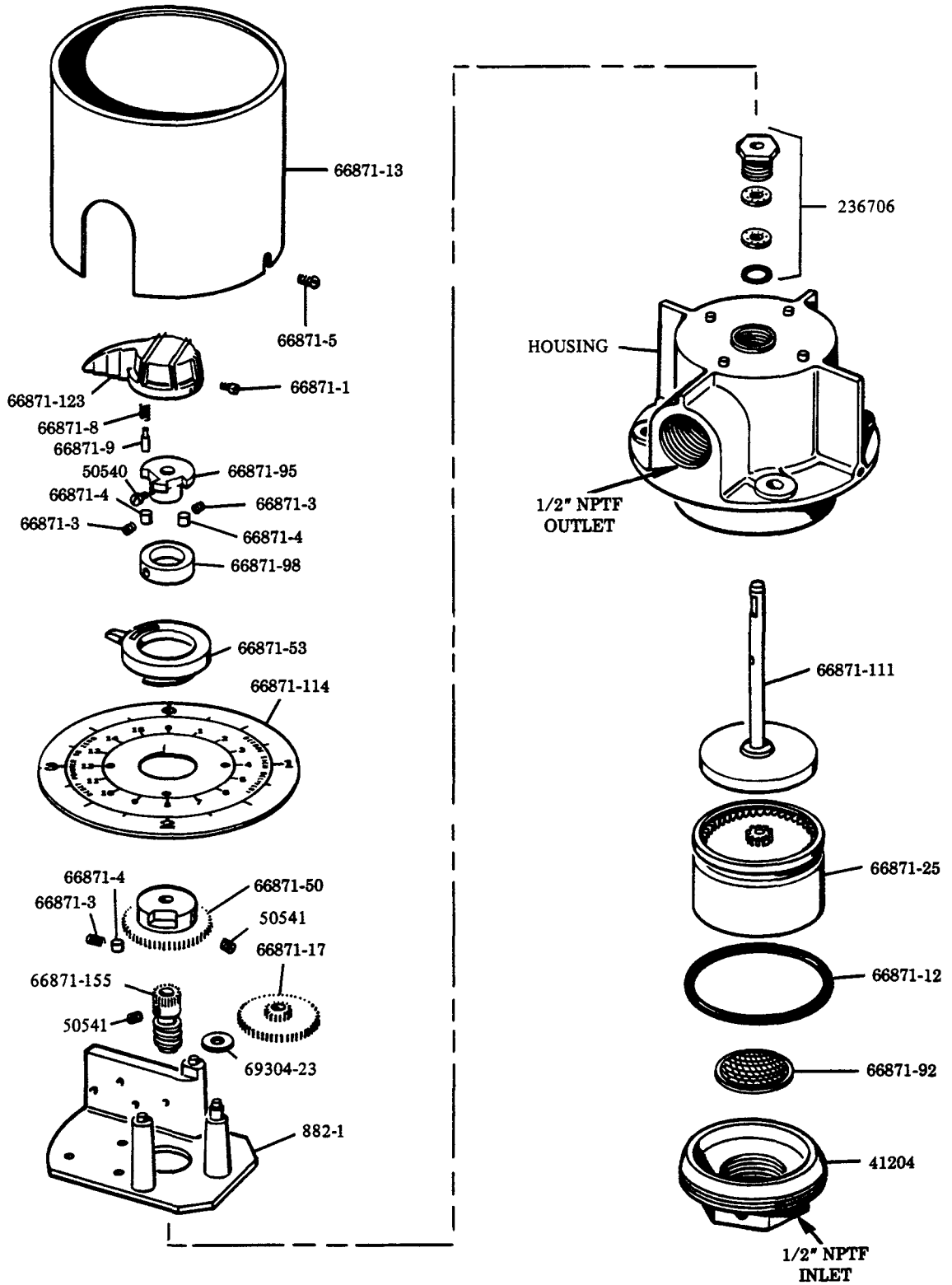

SERVICE PARTS

PART	QUAN.	DESCRIPTION
882-1	1	Frame
41204	1	Housing cap
50540	1	Set screw
50541	1	Set screw
66871-1	2	Set screw
66871-3	3	Reset knob roller retaining spring
66871-4	3	Reset knob clutch roller
66871-5	2	Shroud screw
66871-8	1	Reset knob plunger spring
66871-9	1	Reset knob plunger
66871-12	1	Housing cap gasket
66871-13	1	Shroud
66871-17	1	Inner circle pointer gears
66871-23	1	Packing box gland nut
66871-25	1	Chamber & piston assembly
66871-41	1	Register bottom plate
66871-50	1	Inner circle pointer cam
66871-53	1	Inner circle pointer & spring assembly
66871-92	1	Filter screen
66871-95	1	Reset lock cam
66871-98	1	Clutch retainer sleeve
66871-111	1	Upper driving pawl spindle & gear assembly
66871-114	1	Dial
66871-116	1	Washer
66871-123	1	Reset knob
66871-155	1	Right hand, double worm & gear assembly
69304-23	1	Spacer
236706	1	Packing gland kit

RETAIN THIS INFORMATION FOR FUTURE REFERENCE

When ordering replacement parts, list: Part Number, Description, Model Number, and Series Letter.

LINCOLN provides a Distributor Network that stocks equipment and replacement parts.

A list of Authorized Service Departments will be furnished upon request.