

METERING CONTROL VALVES

Models 878, 881 287E

IMPORTANT:

This unit is not for resale of product and is not subject to resale tolerances.

Before meter can be placed in service "after repair", meter must be tested and approved in accordance with U.S. Government's weights and measures standards.

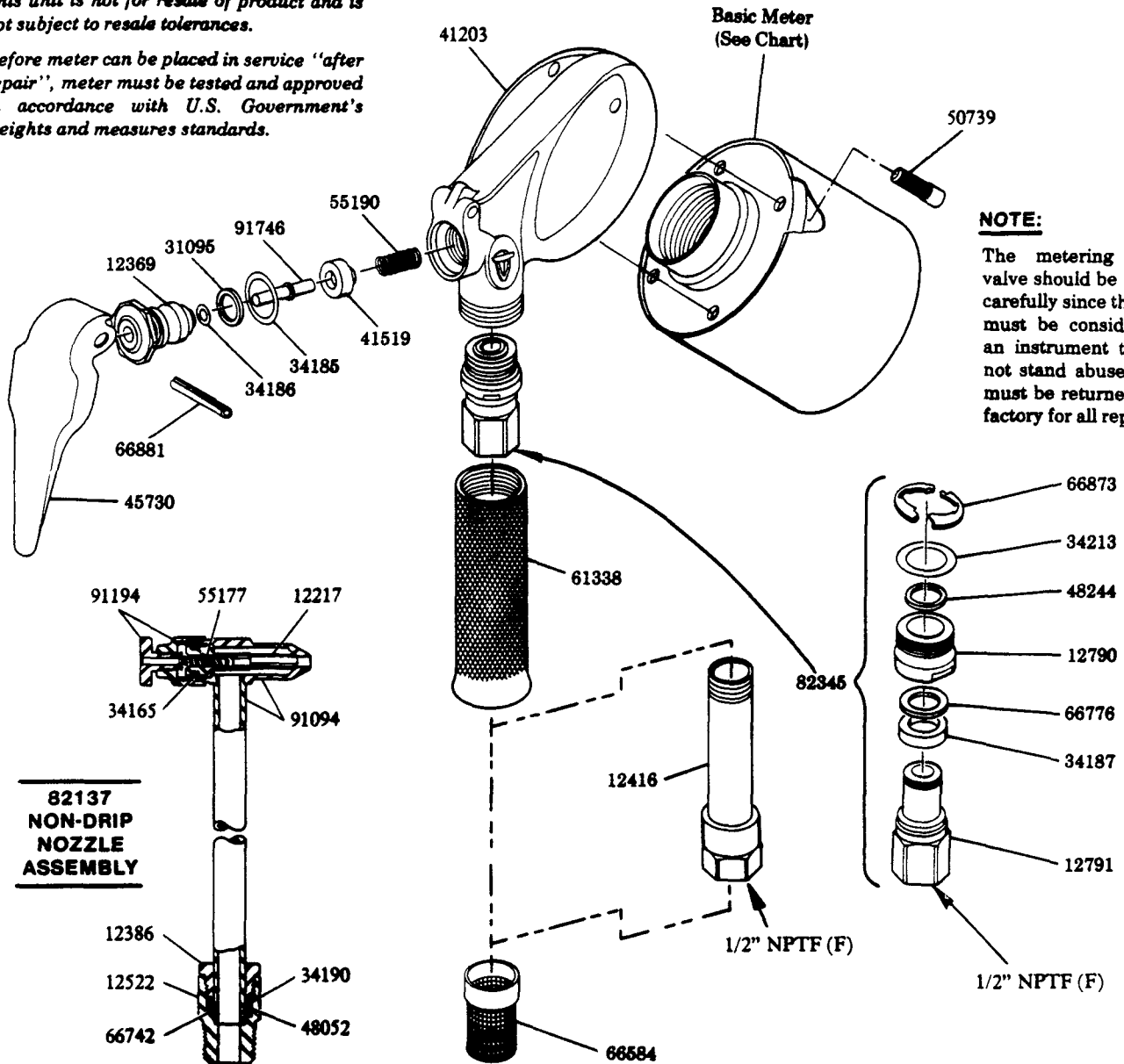

NOTE:
The metering control valve should be handled carefully since the meter must be considered an instrument that will not stand abuse. Meters must be returned to the factory for all repairs.

**82137
NON-DRIP
NOZZLE
ASSEMBLY**

MODEL	REFER TO SERVICE PAGE	MEASURE	BASIC METER
878	F21-26	PINTS (Totalizing)	66738
881	F21-25	LITRES (Totalizing)	70500 ©
287E	F21-27	PINTS (Non-totalizing)	68585

© Indicates Change

LINCOLN McNEIL
A DIVISION OF
CORPORATION
One Lincoln Way, St. Louis, MO 63120 (314) 679-4200

**SECTION - F21
PAGE - 8G**

OPERATION OF CONTROL VALVE

The control valve is designed to allow the operator complete control of the volume of lubricant being dispensed. First unscrew the nozzle cap knob three or four revolutions. A slight compression of the valve handle will allow a small volume of lubricant to pass through the control valve, meter and nozzle. As the handle is further compressed the lubricant volume will increase. When the valve handle is released, a plunger in the nozzle tip prevents the lubricant from draining out of the extension. The nozzle should always be closed when the control valve is not being used. To close nozzle, turn the nozzle cap knob clockwise and tighten by hand.

If lubricant continues to flow from nozzle tip after the valve handle is released:

- 1) Lubricant is by-passing the 41519 Check. If sealing surface is cut or otherwise damaged, replace the 41519 Check. To remove the valve handle, use slender punch to drive the 66881 Roll Pin out of the handle and valve casting.

IMPORTANT

The 41519 Check should hold the lubricant pressure back from the nozzle. Purpose of the plunger in the nozzle is not to stop the flow of lubricant when under pressure.

- 2) Plunger in nozzle tip or seat of plunger is worn, pitted or damaged. Tighten and retighten nozzle cap knob several times with pliers to reseal the plunger.

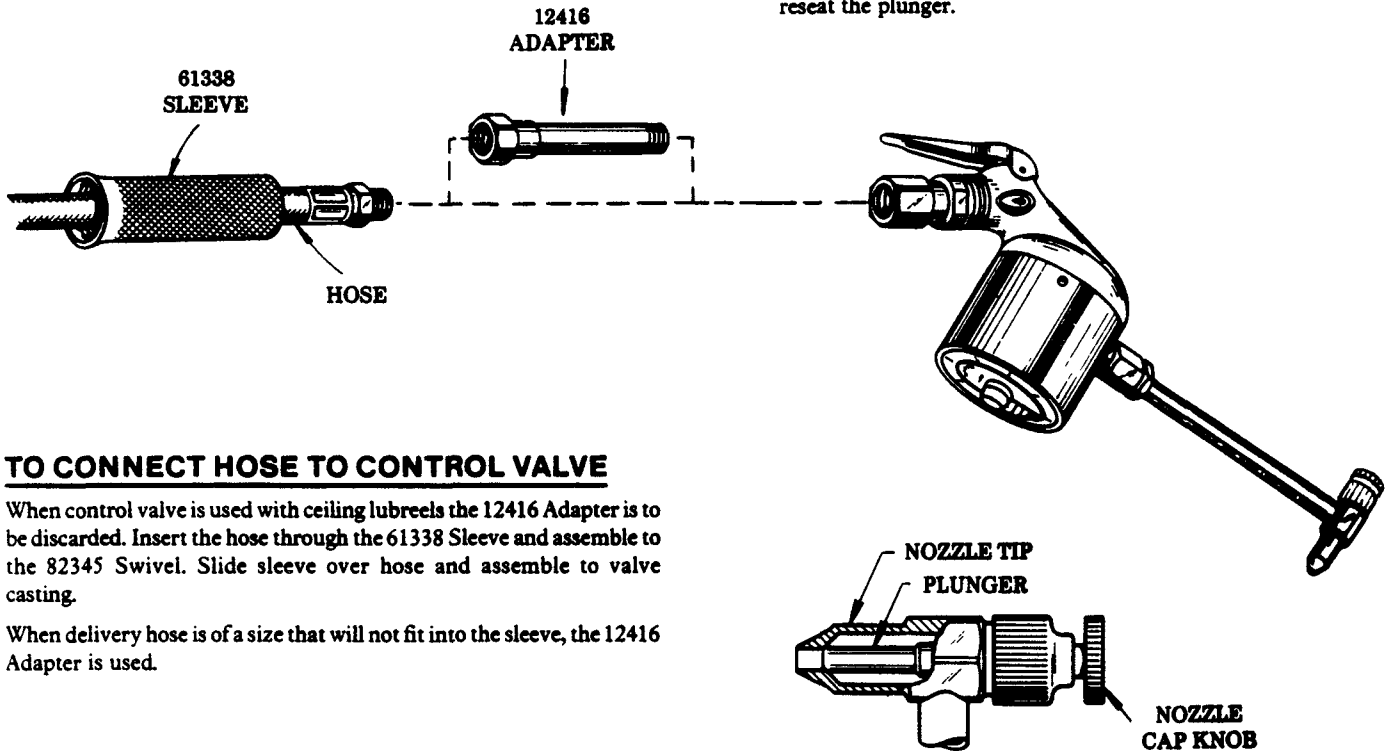

TO CONNECT HOSE TO CONTROL VALVE

When control valve is used with ceiling lubreels the 12416 Adapter is to be discarded. Insert the hose through the 61338 Sleeve and assemble to the 82345 Swivel. Slide sleeve over hose and assemble to valve casting.

When delivery hose is of a size that will not fit into the sleeve, the 12416 Adapter is used.

SERVICE PARTS

PART	QUAN.	DESCRIPTION	PART	QUAN.	DESCRIPTION	PART	QUAN.	DESCRIPTION
12217	1	Plunger	34187	1	Packing	61338	1	Valve sleeve
12369	1	Gland nut	34190	1	Packing	66584	1	Strainer
12386	1	Swivel nut	34213	1	O-ring	66742	1	Retaining ring
12416	1	Adapter	41203	1	Valve body	66776	1	Spring washer
12522	1	Swivel body	41519	1	Check	66873	1	Retaining ring
12790	1	Swivel adapter	45730	1	Handle	66881	1	Roll pin
12791	1	Swivel stud	48052	1	Washer	82137	1	Non-drip nozzle ass'y.
31095	1	Gasket	48244	1	Washer	82345	1	Swivel assembly
34165	1	Packing	50739	4	Screw	91094	1	Nozzle body assembly
34185	1	O-ring	55177	1	Spring	91194	1	Cap assembly
34186	1	O-ring	55190	1	Spring	91746	1	Plunger

RETAIN THIS INFORMATION FOR FUTURE REFERENCE

When ordering replacement parts, list: Part Number, Description, Model Number, and Series Letter.

LINCOLN provides a Distributor Network that stocks equipment and replacement parts.

A list of Authorized Service Departments will be furnished upon request.