

27:1 RATIO

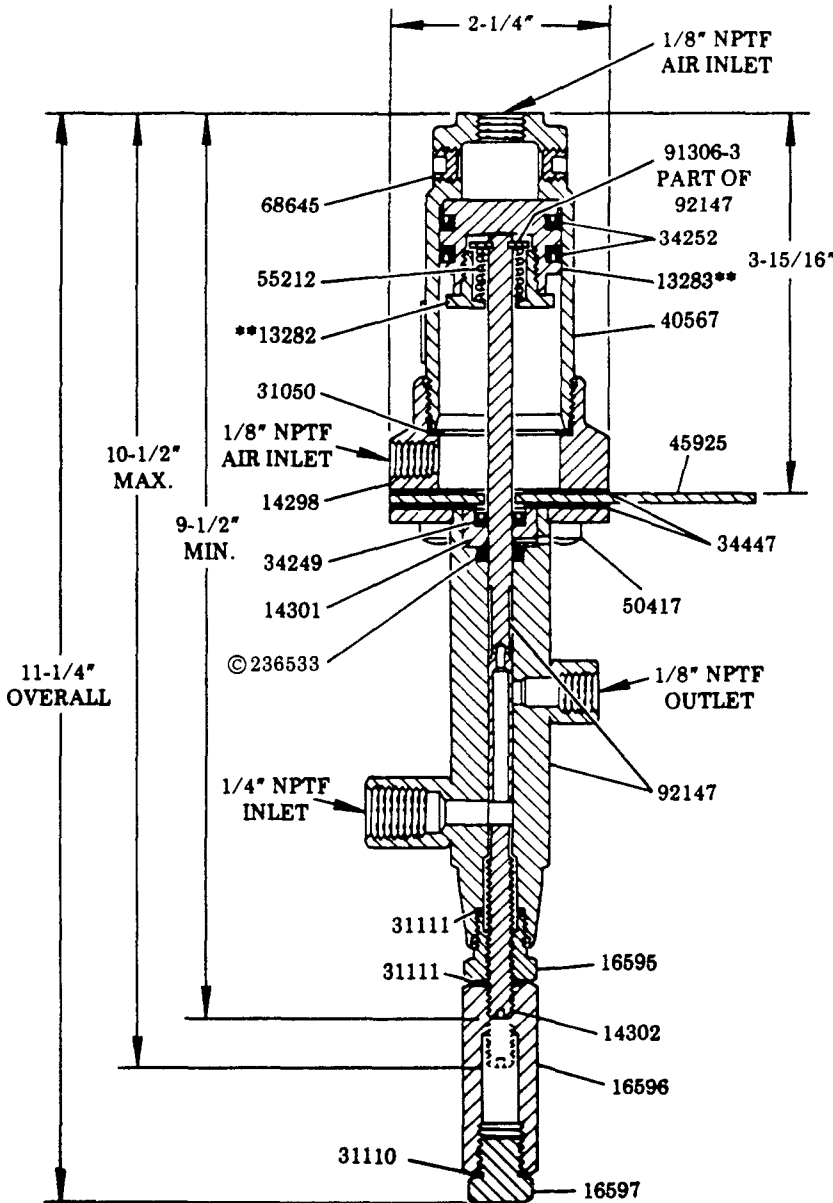

© Indicates change

SPECIFICATIONS

	Min.	Max.
PRIMING PRESSURE	—	1,000 psi
AIR OPERATING PRESSURE	80 psi	100 psi
*OUTPUT PER CYCLE	.005 in ³	.045 in ³

*14302 Adjusting Screw controls the amount of output per cycle.

**Torque 13282 and 13283 to 25-30 ft.-lbs.

ADJUSTMENT PROCEDURE

Remove 16597 Stop Plug and 31110 Gasket. Loosen 16596 Adjustment Housing one half to one full turn. Insert screwdriver into adjustment housing and turn 14302 Adjusting Screw counter-clockwise to increase output or clockwise to decrease output. After completing adjustment, tighten adjustment housing while holding adjusting screw with screwdriver. Replace gasket and stop plug.

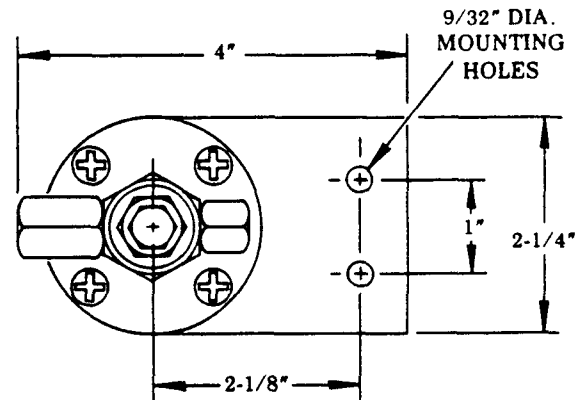

SERVICE PARTS

Part	Qty.	Description	Part	Qty.	Description	Part	Qty.	Description
13282	1	Spring retainer nut	31050	1	Gasket	50417	4	Screw
13283	1	Piston	31110	1	Gasket	55212	1	Spring
14298	1	Cylinder adapter	31111	2	Gasket	68645	2	Flush seating plug
14301	1	Spacer	34249	1	U-cup packing	91306-3	1	Washer
14302	1	Adjusting screw	34252	2	U-cup packing	92147	1	Plunger assembly
16595	1	Adjusting screw adapter	34447	2	Gasket	236533	1	Viton packing
16596	1	Adjustment housing	40567	1	Air cylinder			
16597	1	Stop plug	45925	1	Bracket			