

602103 - 1/4" PORTS

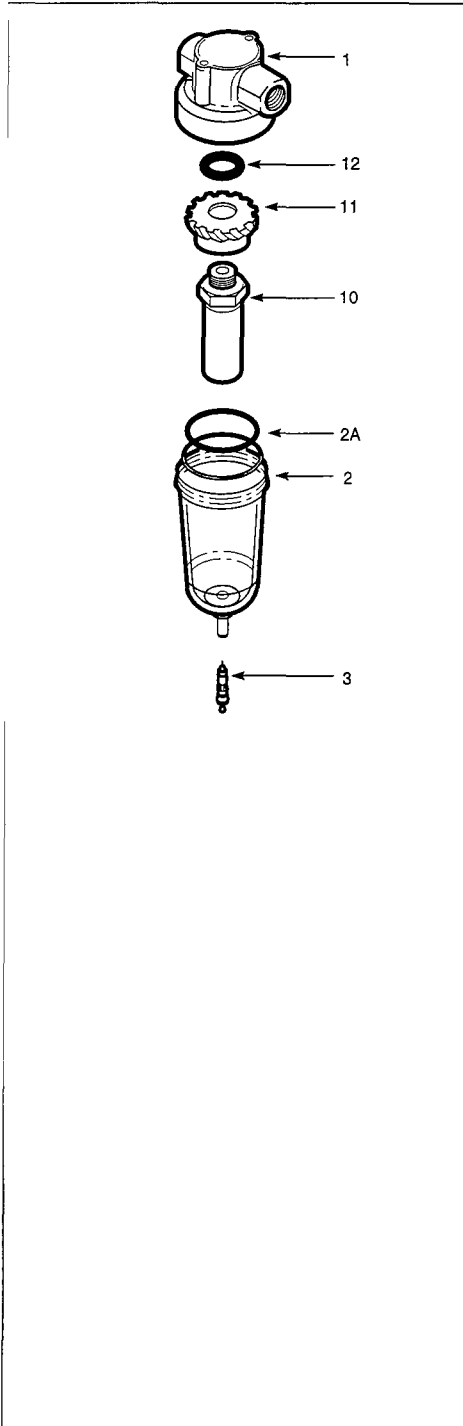

TECHNICAL DATA

Fluid: Compressed air
 Maximum pressure: 150 psig (10.3 bar)
 Operating temperature:* 0 to +125°F (-20° to +52°C)
 * Air supply must be dry enough to avoid ice formation at temperatures below +35°F (+2°C)

Main ports: 1/4" PTF
 Filter element rating: 5µm
Materials:
 Body: Zinc
 Bowl: Polycarbonate plastic
 Element: Sintered polypropylene plastic
 Elastomers: Neoprene and nitrile

REPLACEMENT ITEMS

Filter element, 5µm (2A, 10, 12).....	247872
Bowl with drain (2, 2A, 3)	247921
Drain, manual (3).....	247894

INSTALLATION

1. Install filter vertically in air line -
 - upstream of regulators, lubricators, and cycling valves,
 - with air flow in direction of arrow on body,
 - as close as possible to the air supply when used as a main line filter,
 - as close as possible to the device being serviced when used as a final filter.
2. Connect piping to proper ports using pipe thread sealant on male threads only. Do not allow sealant to enter interior of unit.
3. Make sure bowl is fully tightened into body before pressurizing.

SERVICING

1. Open manual drain (3) to expel accumulated liquids. Keep liquids below element (10).
2. Clean or replace filter element when dirty.

DISASSEMBLY

1. Shut off inlet pressure. Reduce pressure in inlet and outlet lines to zero.
2. Remove bowl by turning counterclockwise.
3. Disassemble in general accordance with the item numbers on exploded view. Remove and replace drain (3) only if it malfunctions.

CLEANING

1. Clean polycarbonate bowl (2) with warm water only. Clean other parts with warm water and soap.
2. Rinse and dry parts. Blow out internal passages in body (1) with clean, dry compressed air. Blow air through filter element (10) from inside to outside to dislodge surface contaminants.
3. Inspect parts. Replace parts found to be damaged.

ASSEMBLY

1. Lubricate o-rings with o-ring grease.
2. Assemble the filter as shown on the exploded view.
3. Torque Table

	Inch-Pounds (N-m)
10 (element)	5 to 10 (0.6 to 1.1)
2 (bowl)	5 to 10 (0.6 to 1.1)
3 (drain)	1.5 to 3 (0.2 to 0.3)

CAUTION

Water vapor will pass through these units and could condense into liquid form downstream as air temperature drops. Install an air dryer if water condensation could have a detrimental effect on the application.

WARNING

These products are intended for use in industrial compressed air systems only. Do not use these products where pressures and temperatures can exceed those listed under **Technical Data**.

Polycarbonate plastic bowls can be damaged and possibly burst if exposed to such substances as certain solvents, strong alkalis, compressor oils containing ester-based additives or synthetic oils. Fumes of these substances in contact with the polycarbonate bowl, externally or internally, can also result in damage. Clean with warm water only.

Do not use these products with fluids other than air, for nonindustrial applications, or for life-support systems.