

FOR MODELS 84978 & 84979 PUMP TUBES

- 86224 - Teflon Kit
- 86226 - UHMW Polyethylene Kit
- 86228 - Viton Kit
- 86230 - Polyurethane Kit (Standard)

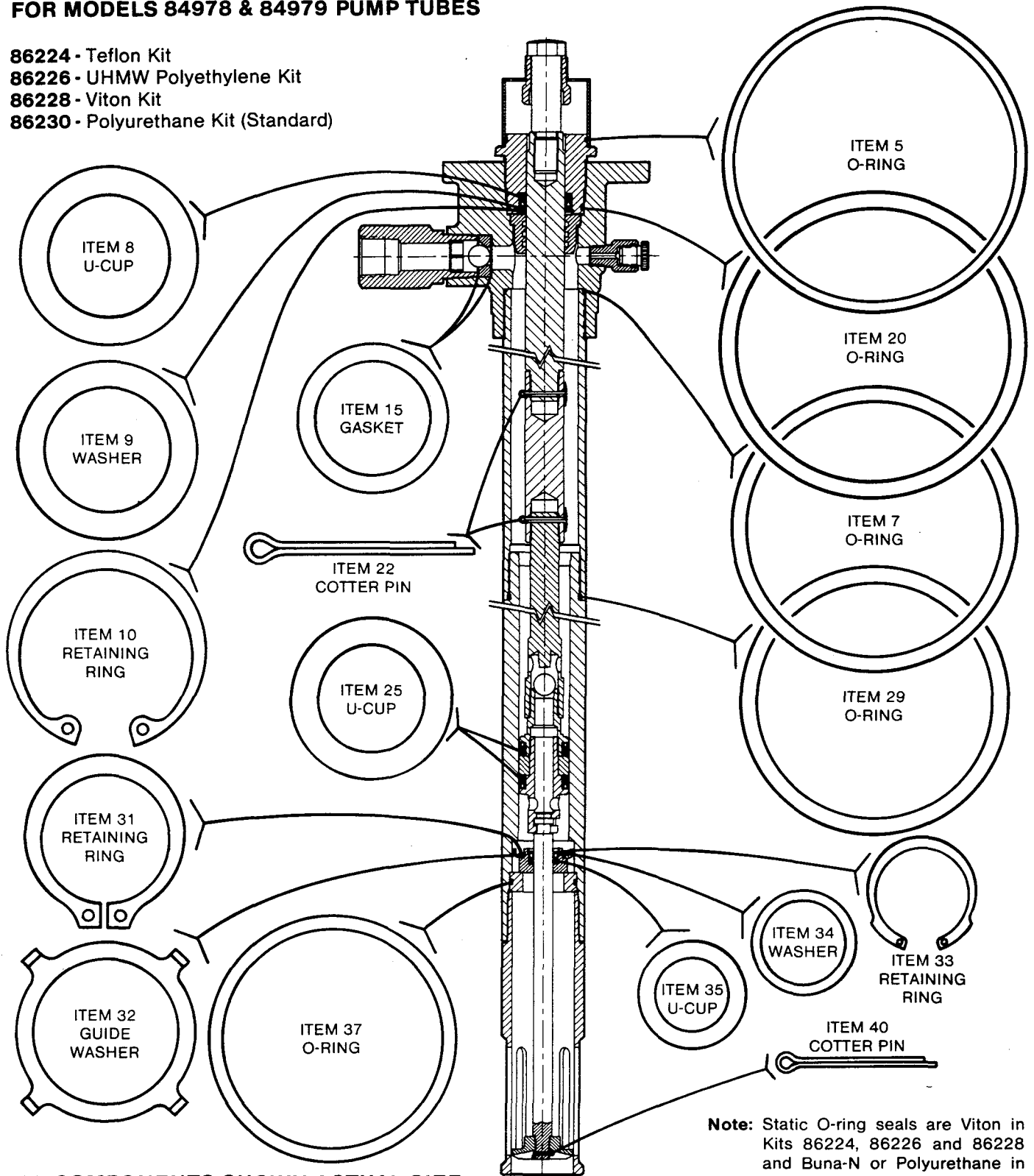

Note: Static O-ring seals are Viton in Kits 86224, 86226 and 86228 and Buna-N or Polyurethane in Kit 86230.

ALL COMPONENTS SHOWN ACTUAL SIZE

DISASSEMBLY

Tools Required

- 2-1/8" Dia. Strap Wrench
- Retaining Ring Pliers (External)
- Retaining Ring Pliers (Internal)
- 11/16" Hex Wrench
- 7/8" Hex Wrench
- 13/16" Hex Wrench
- 1-3/8" Hex Wrench
- 2-1/4" Hex Wrench
- Pliers

Procedure

1. Remove Priming Tube (Item 42) from Adapter Tube (Item 30).
2. Remove Cotter Pin (Item 40) from Priming Plunger (Item 39).
3. Remove Priming Shovel (Item 41) from Priming Plunger (Item 39).
4. Unscrew Adapter Tube (Item 30) from Pump Tube (Item 21) and slide off of Piston Assembly (Items 25, 27 & 28).
5. Remove Priming Plunger (Item 39) from Piston Body (Item 28).
6. Remove Check Seat (Item 38) and O-ring (Item 37) from Adapter Tube (Item 30).
7. Remove Check Assembly (Items 31, 32, 33, 34, 35, & 36) from Adapter Tube (Item 30).
8. Remove Retaining Ring (Item 31) and Guide Washer (Item 32) from Check (Item 36).
9. Remove Retaining Ring (Item 33), Packing Washer (Item 34) and U-cup Packing (Item 35) from Check (Item 36).
10. Remove Lube Cup (Item 4) from Gland Nut (Item 6).
11. Remove Bolt Connector (Item 1) from Plunger (Item 3).
12. Pull Piston Assembly (Items 25, 27 & 28) to remove Plunger (Item 3), Connecting Rod (Item 23), Adapter (Item 24) and Piston Assembly from Pump Tube (Item 21).
13. Remove Pump Tube (Item 21) from Outlet Body (Item 12).
14. Remove O-ring (Item 20) from Outlet Body (Item 12).
15. Remove Gland Nut (Item 6) from Outlet Body (Item 12).
16. Remove Sleeve (Item 11) from Outlet Body (Item 12).
17. Remove Priming Plug (Item 13) and Adapter (Item 14) from Outlet Body (Item 12).
18. Remove Outlet Body (Item 19) from Outlet Body (Item 12).
19. Remove Ball (Item 17), Check Seat (Item 16) and Gaskets (Item 15) from Outlet Body (Item 12).
20. Remove Retaining Ring (Item 10), Packing Washer (Item 9) and U-cup Packing (Item 8) from Gland Nut (Item 6).
21. Remove Piston Adapter (Item 25) from Adapter (Item 24).

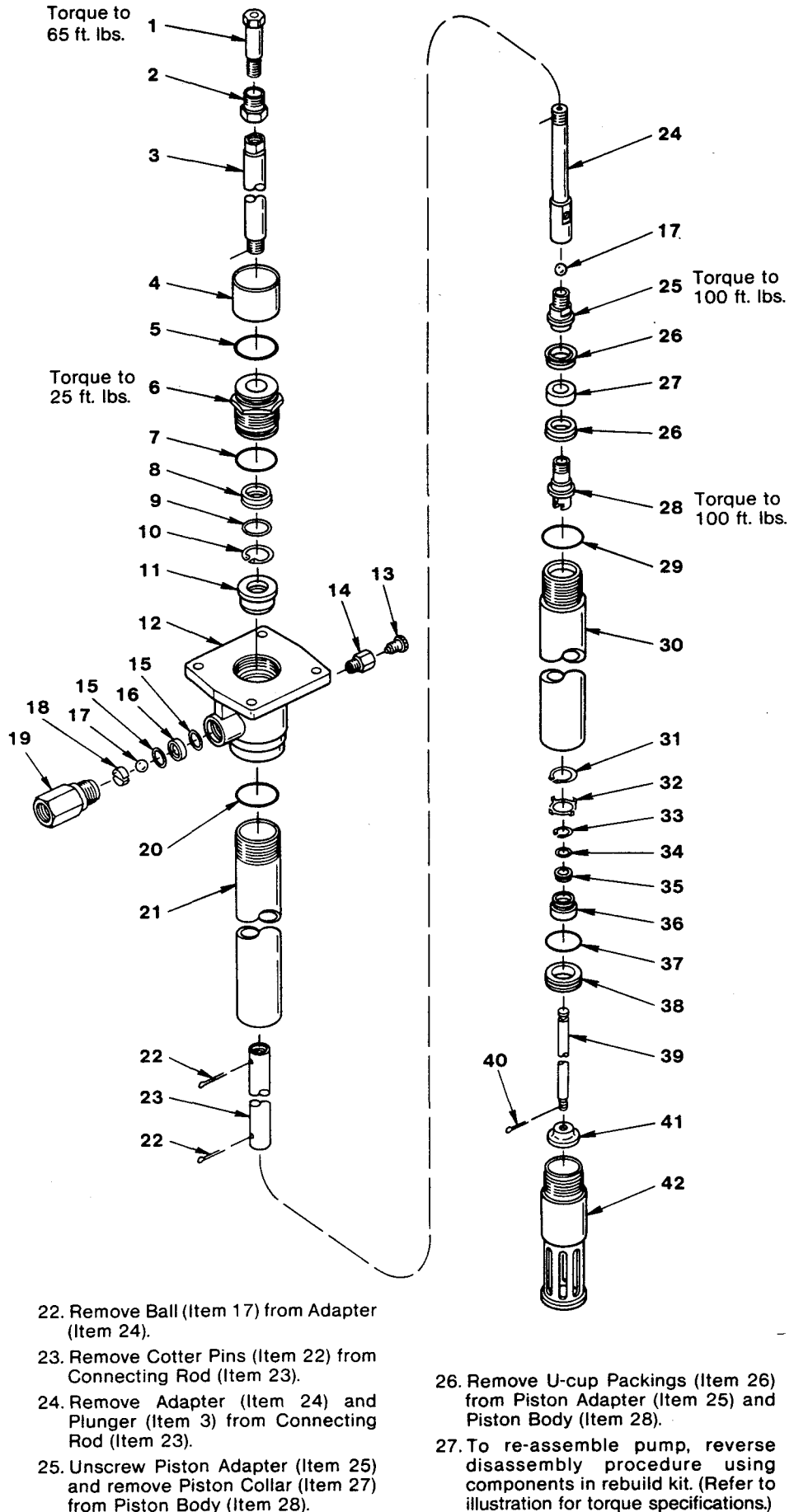

RETAIN THIS INFORMATION FOR FUTURE REFERENCE

When ordering replacement parts, list: Part Number, Description, Model Number and Series Letter.
 LINCOLN provides a Distributor Network that stocks equipment and replacement parts.