

Included with Model 2718 Pressure Primer  
 For Pile Driver III Pumps

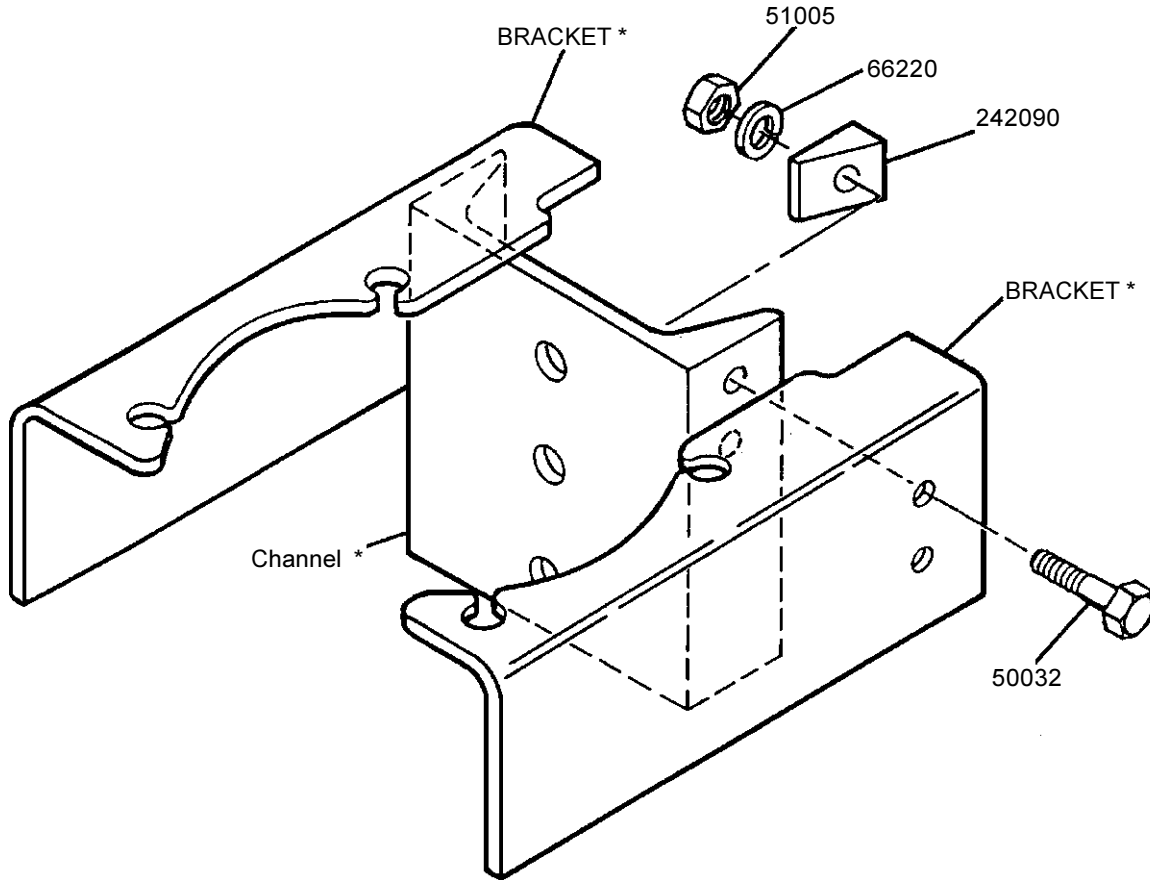

**Service Parts**

Part	Qty	Description
50032	4	Hex, Screw
51005	4	Hex, Nut
66220	4	Lock Washer
242090	4	Bevel Washer

**\* Available only in  
 Bracket Kit 84784**

**NOTE:** This kit is available to install following Pile Driver III pump tubes only: models 84900, 84901, 84902 & 84904.

---

## **Assembly Instructions**

1. Mount bracket part number 84784 to pump hoist channel, per the illustration that shows the pump tube type you will be using.
2. To install air motor and pump tube to bracket, remove 4 hex nuts from air motor tie rods. Mount air motor to pump tube outlet body. Use recommended procedure listed in air motor and pump tube owner's manual to align the pump tube and air motor during installation on the bracket. Then fasten air motor and pump tube to bracket using 4 hex nuts.

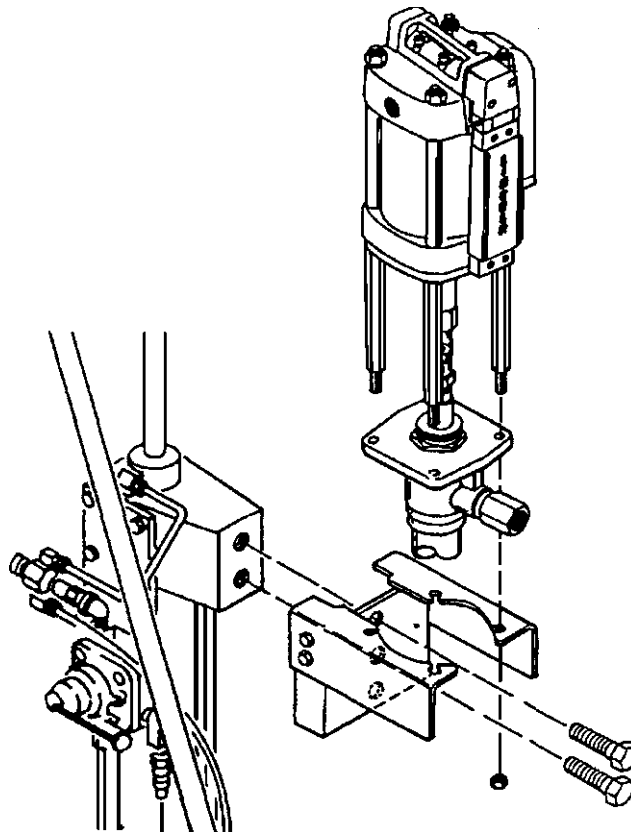

**Pile Driver III Pump Tubes  
84900, 84901, 84902, 84904**

————— **RETAIN THIS INFORMATION FOR FUTURE REFERENCE** —————

When ordering replacement parts, list: Part Number, Description, model Number and Series Letter.  
LINCOLN provides a Distributor Network that stocks equipment and replacement parts.